

U.P.R.N.

Ward of Point - a - Pierre

Process SD# 109871

County of Victoria

Cadastral Sheet D.22.P. 53C
4/a

G.N.

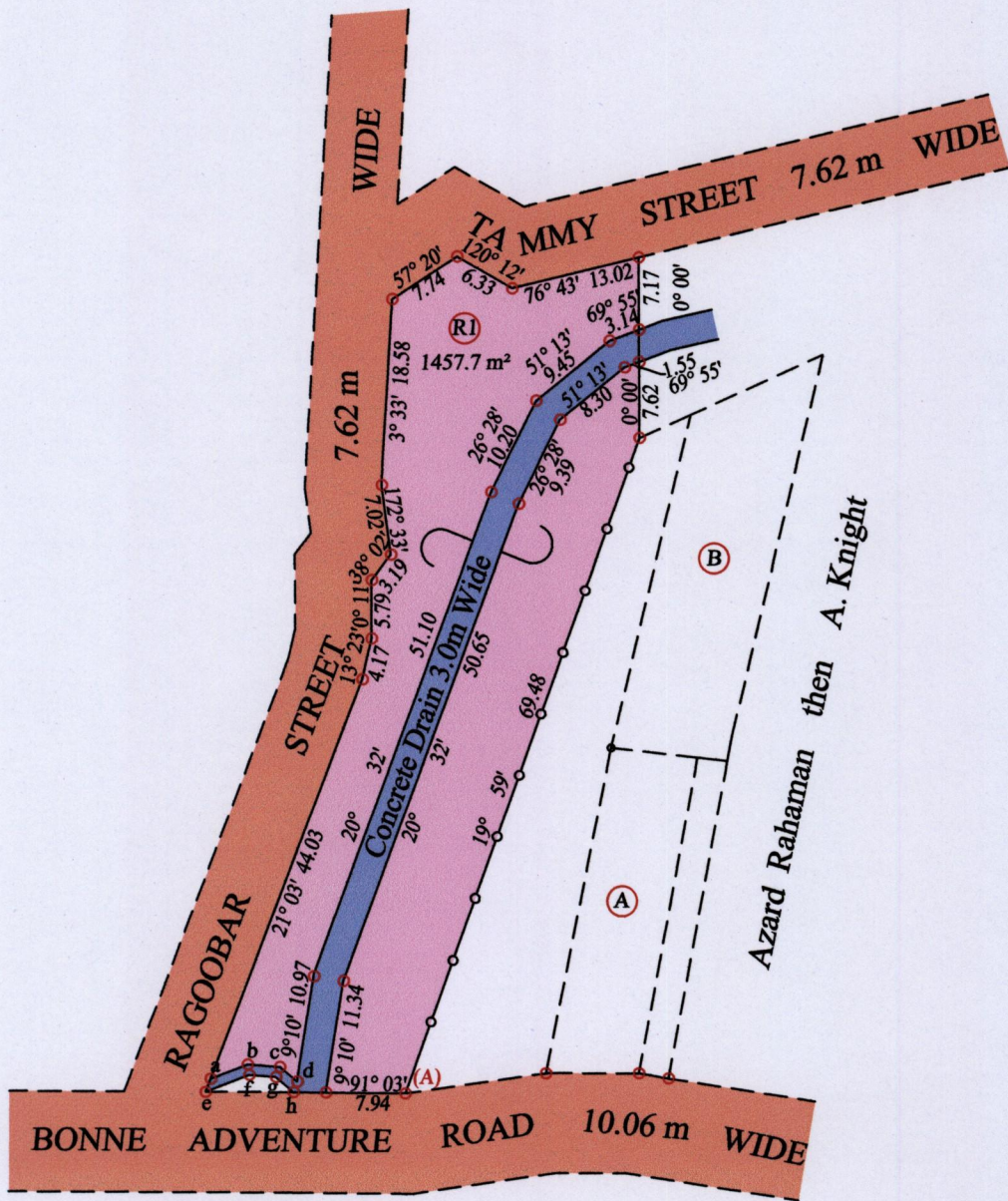
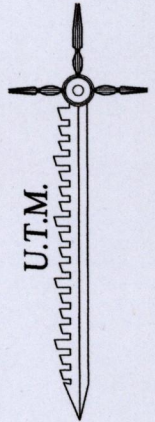

Vide Bk. 1262 fol. 199

At Station (A)
 E 0672447
 N 1140757
 Reading taken with
 Handheld G.P.S.
 U.T.M. Zone 20
 Naparima
 ± 5 m.

| | | |
|-------|----------|------|
| a - b | 69° 00' | 3.97 |
| b - c | 94° 58' | 3.23 |
| c - d | 131° 40' | 2.26 |
| e - f | 69° 00' | 4.66 |
| f - g | 94° 58' | 2.65 |
| g - h | 131° 21' | 2.35 |

○ Denotes Iron put except stated otherwise.

SCALE : 1:750

Note: Bearings are U.T.M. grid based on solar observations Distances are in metres

PLAN of a Parcel of land coloured pink in the Ward of Point - a - Pierre
 Containing one thousand four hundred and fifty seven point seven square metres
 Surveyed by me, with due authority, in March 2015 for Dr. C. Ragoobar
 Certified Correct in accordance with Regulation 25(1) of the Land Surveyors Regulations 1998

Checked by

Entered on Trinidad & Tobago Land Surveyor 12.05.2015

MINISTRY OF FOOD PRODUCTION
 LAND AND MARINE AFFAIRS
 MAY 12 2015
 # 142 RR
 Lands & Surveys Division

