

Surveyor's
Process SD# 110991

U.P.I.N. No.

1560

Cadastral Sheet $\frac{53C}{4/b}$, D.22.P

Ward of Point-a-Pierre

169

County of Victoria

Vide
Bk. 984:99
Plan J.F.272

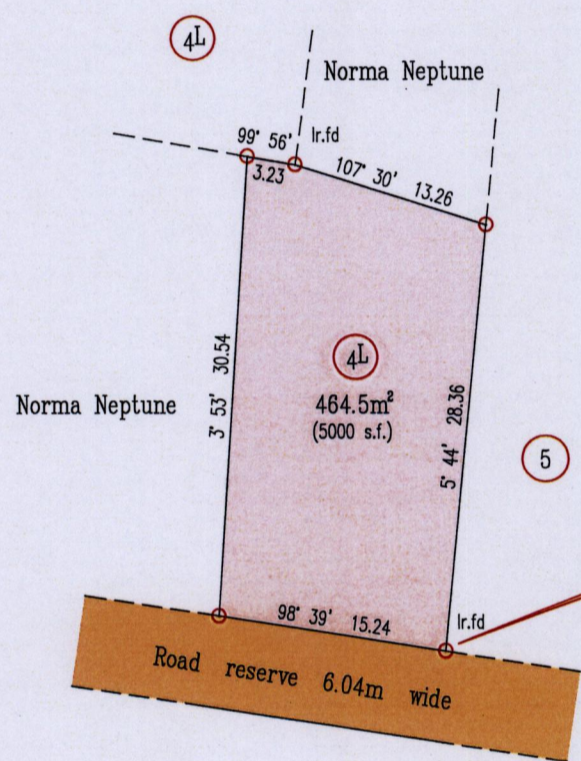
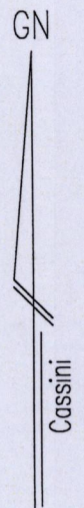

Coordinates scaled from Ward Sheet
(673500 mE, 1140480 mN)
(U.T.M. 20, NAPARIMA 1955 (+/- 5 m)

Bearings are Cassini Grid based on Solar Obs.

○ Denotes Iron Put unless otherwise stated

Plan of a Parcel of land coloured pink in the Ward of Point-a-Pierre
Containing four hundred and sixty four point five square metres
Surveyed by me, with due authority, in June 2006 for Norma Neptune

Certified Correct in accordance with Regulation 25(1) of the Land Surveyors Regulations 1998

Checked by

Entered on

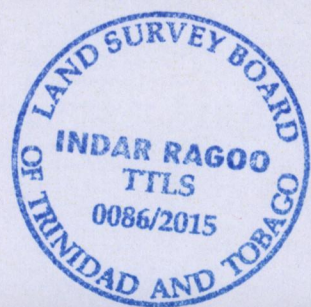

..... Indar Ragoo

Trinidad & Tobago Land Surveyor/...../2015

SCALE 1:500

Distances are in Metres

