

U.P.R.N.....

Address - (LP#70) Lot#71,
Iere Village Branch Road,
Princes Town.

Process ID#110964

Cadastral Sheet G.4. $\frac{54D}{1/b \& 2/a}$
Ward of Savana Grande
County of Victoria

Registered Deed#13941/1978

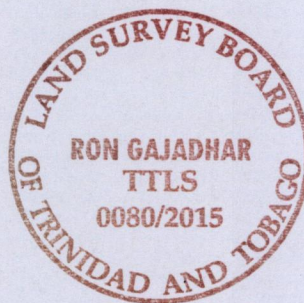
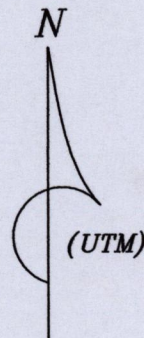
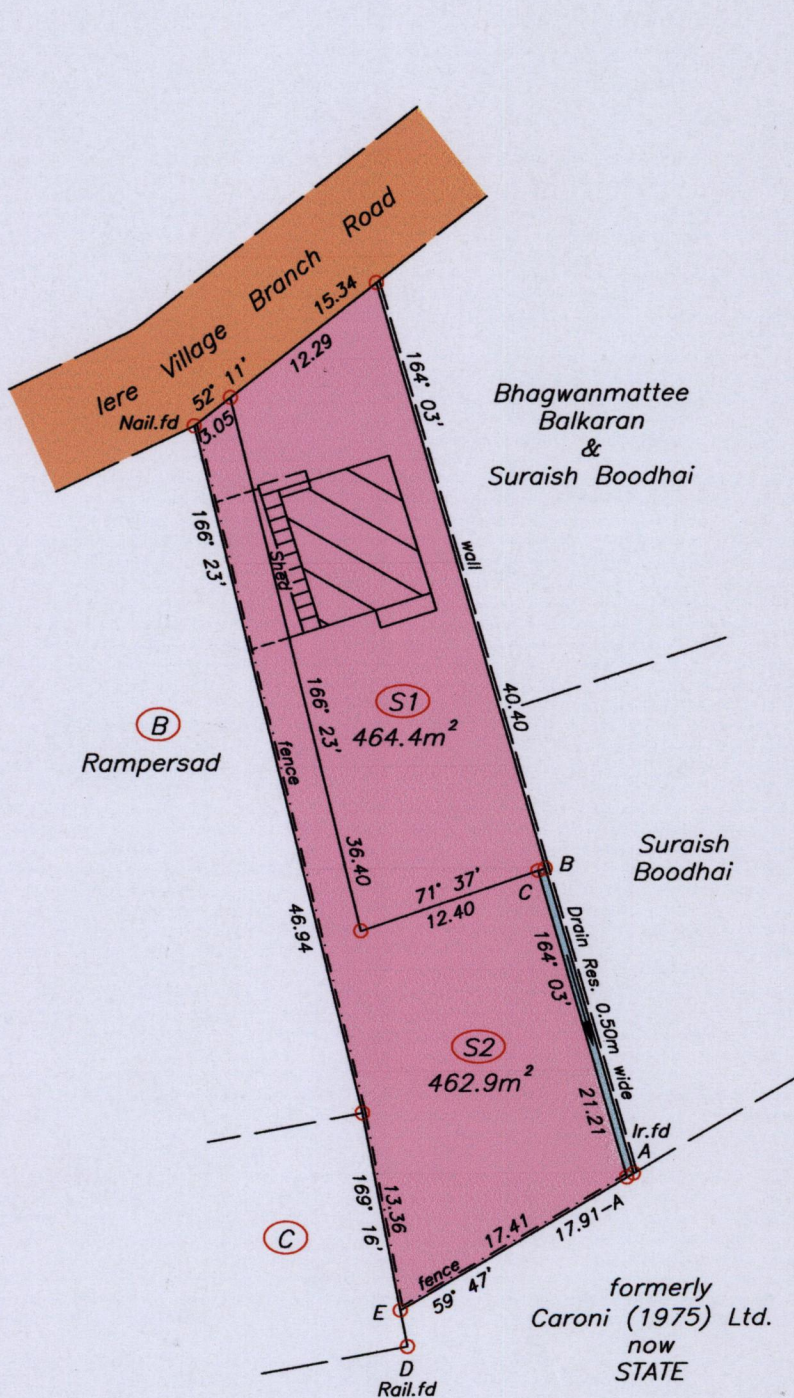

A = $\begin{matrix} 677214 & E \\ 1138102 & N \end{matrix}$ (U.T.M)

Legend

| | | |
|-------|----------|-------|
| A - B | 344° 03' | 21.11 |
| B - C | 251° 37' | 0.50 |
| D - E | 349° 16' | 2.50 |

SCALE 1:500

Distances are in metres

Note - UTM (Nap-Zone 20) Coordinates obtained from hand held GPS receiver $\pm 5.00m$

- Denotes Iron put except stated otherwise
- Note: Bearings are U.T.M. grid based on solar observations

Plan of 2 Parcels of land coloured pink in the Ward of Savana Grande. Containing together nine hundred and twenty seven point three square metres. Surveyed by me, with due authority, in July 2015 for Ambrose Semontar. Certified correct in accordance with Regulation 25(1) of the Land Surveyors' Regulations 1998.

Checked by.....

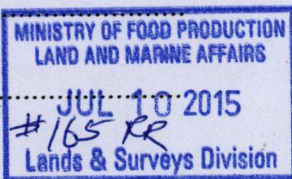

Entered on.....

Trinidad & Tobago Land Surveyor.....10.07.2015

L.S.

599724
+2