

Reg. Deed No.2373 / 2000

Ward of Pointe a Pierre
County of Victoria
Cadastral Sheet D.23.1. $\frac{53 C}{2/d}$

AMENDED PLAN

Process LD#109915

Heirs of Sarah Adams
then
Claudina D'Arnaud
now claimed by
Leeroy Meade

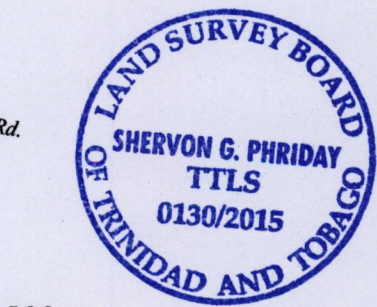
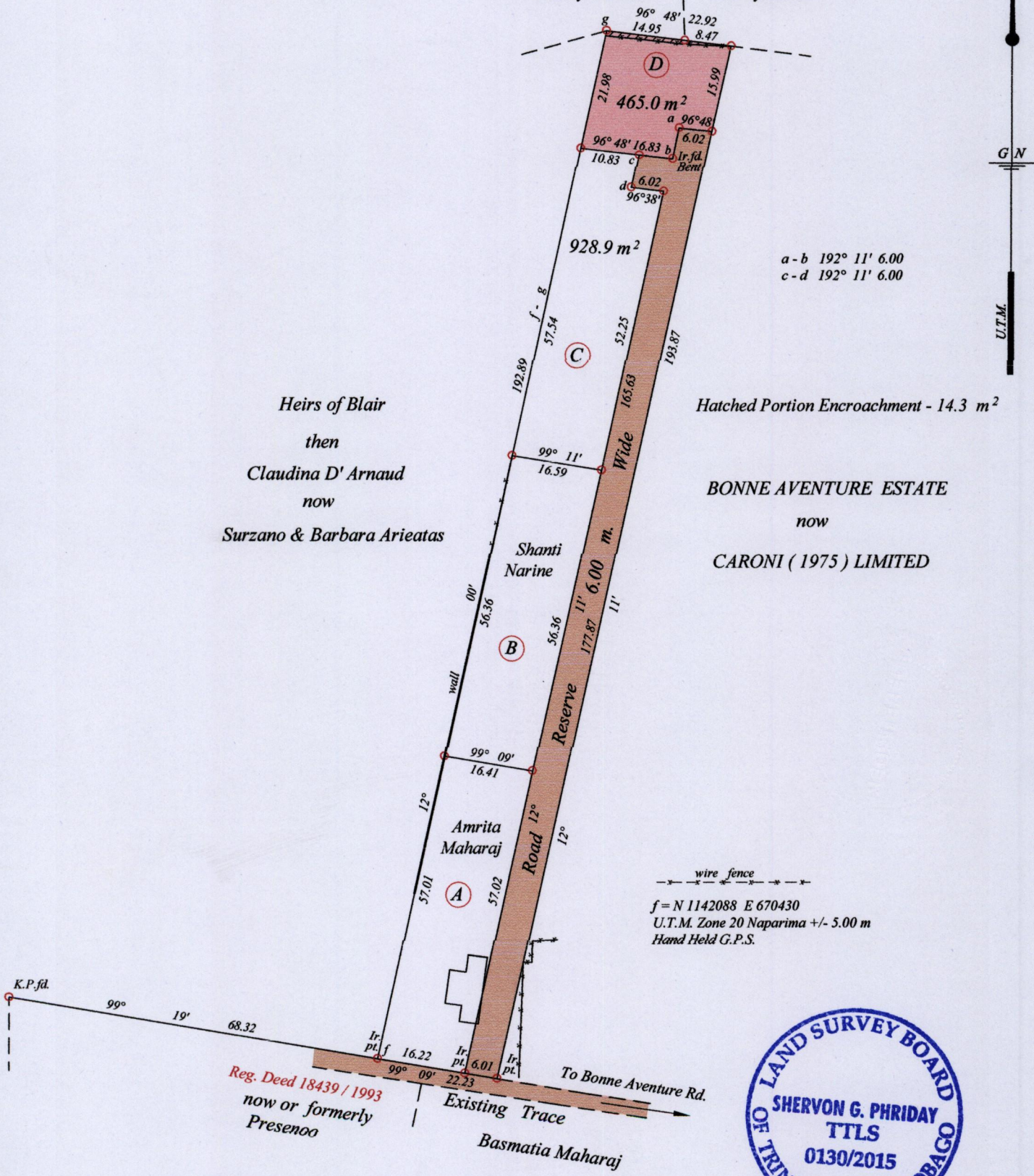

○ Denotes Iron Found Except
Otherwise Stated

SCALE : 1 : 1500

Note: Bearings are U.T.M. grid based on solar observations Distances are in metres
PLAN of a Parcel of land coloured pink in the Ward of Pointe a Pierre
Containing four hundred and sixty five square metres
Re-defined by me, with due authority, in April 2014 for Omala Rampersad Sawh
Certified Correct in accordance with Regulation 25 (1) of the Land Surveyors
Regulations 1998.

Shervon Phriday

Entered on Trinidad & Tobago Land Surveyor 28th May 2015

