

156()

118

U.P.R.N.

Process LSH 109937

Ward of Point - a - Pierre

County of Victoria

Cadastral Sheet D.22.H. $\frac{53C}{2/b}$

G.N.

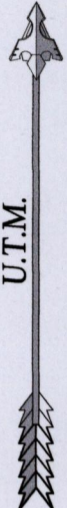

U.T.M.

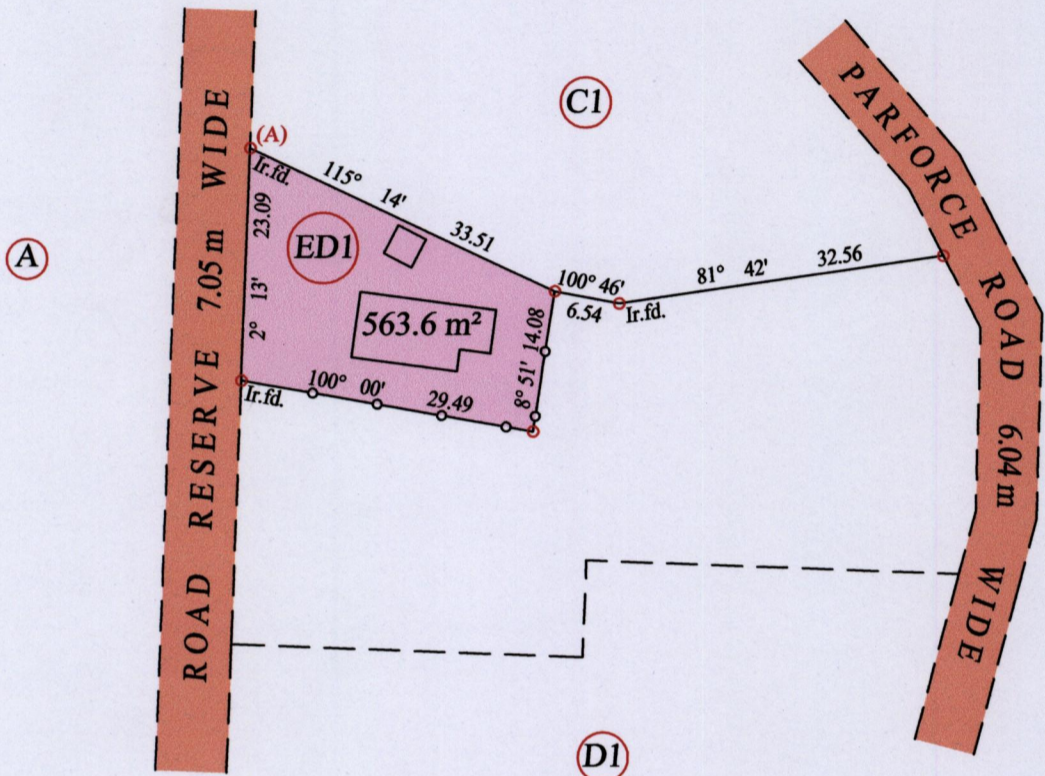

Vide Bk.278 fol.81

At Station (A)
 E 0673383
 N 1143214
 Reading taken with
 Handheld G.P.S.
 U.T.M. Zone 20
 Naparima
 ± 5 m.

○ Denotes Iron put except stated otherwise.

SCALE : 1:750

Note: Bearings are U.T.M. grid based on solar observations

Distances are in metres

PLAN of a Parcel of land coloured pink in the Ward of Point - a - Pierre

Containing five hundred and sixty three point six square metres

Surveyed by me, with due authority, in April 2015 for Eugene Duncan

Certified Correct in accordance with Regulation 25(1) of the Land Surveyors Regulations 1998

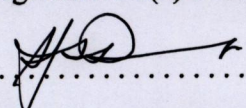
Checked by 

Entered on Trinidad & Tobago Land Surveyor 26.05.2015

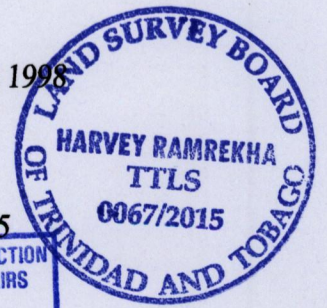

MINISTRY OF FOOD PRODUCTION
 LAND AND MARINE AFFAIRS
 MAY 28 2015
 # 346
 Lands & Surveys Division