

Process JSA 109916

Cadastral Sheet ^{53C} 4/a/3 D.22.0.
Ward of Pointe-a-Pierre
County of Victoria

GASPARILLO

A = N 1140707 +/- 5.0m
E 672166
UTM 20 Naparima 1955 Datum
Hand Held GPS

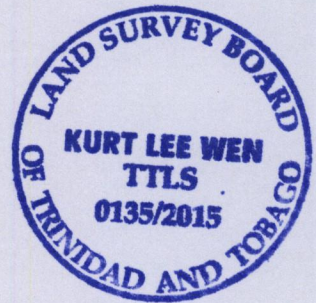
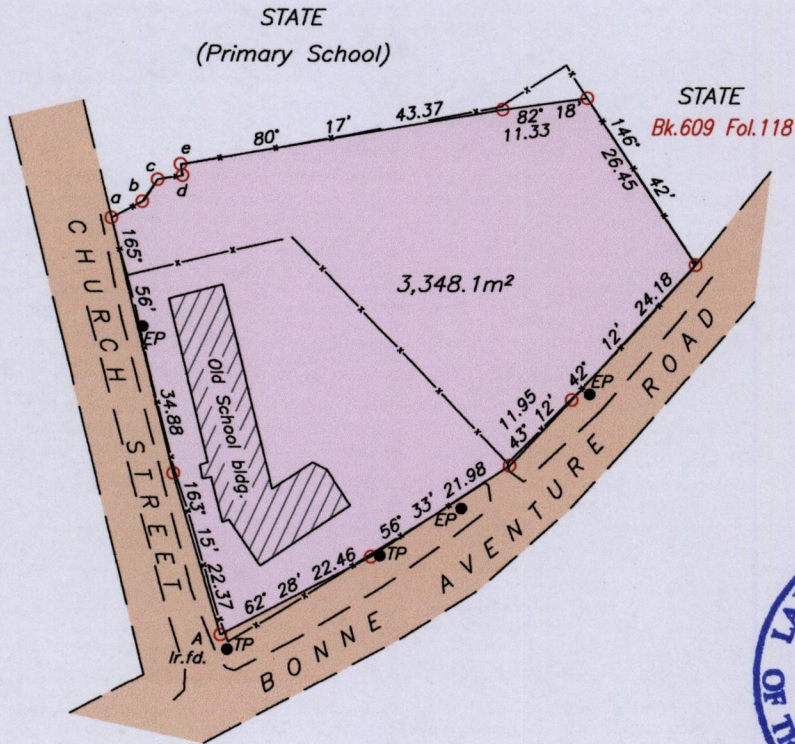
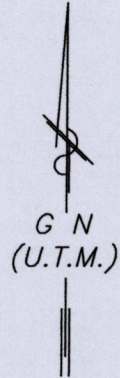

LEGEND

● EP	- Electricity Pole
● TP	- Telephone Pole
—x—	- Wire Fence
— —	- Edge of Asphalt

a - b	62° 10'	4.61
b - c	34° 30'	3.56
c - d	80° 56'	3.35
d - e	349° 00'	1.56

SCALE 1:1000
Distances are in METRES

○ Denotes Iron put unless otherwise stated
Bearings are U.T.M. Grid based on Solar observations

PLAN of a Parcel of land coloured pink in the Ward of Pointe-a-Pierre
Containing three thousand three hundred and forty eight point one square metres
Surveyed by me, with due authority, in March 2015 at the request of
The Education Facilities Company Limited
Certified correct in accordance with Regulation 25 (1) of the Land Surveyors Regulations 1998.

..... *Kurt Lee Wen* T.T.L.S.

Entered on Trinidad & Tobago Land Surveyor *May 22* 20¹⁵

