

1500

1008

U.P.R.N.
Process ID# 109903



Ward of Pointe - a - Pierre
County of Victoria
Cadastral Sheet D.23.F 54.A
1/b

G. N.
U.T.M.

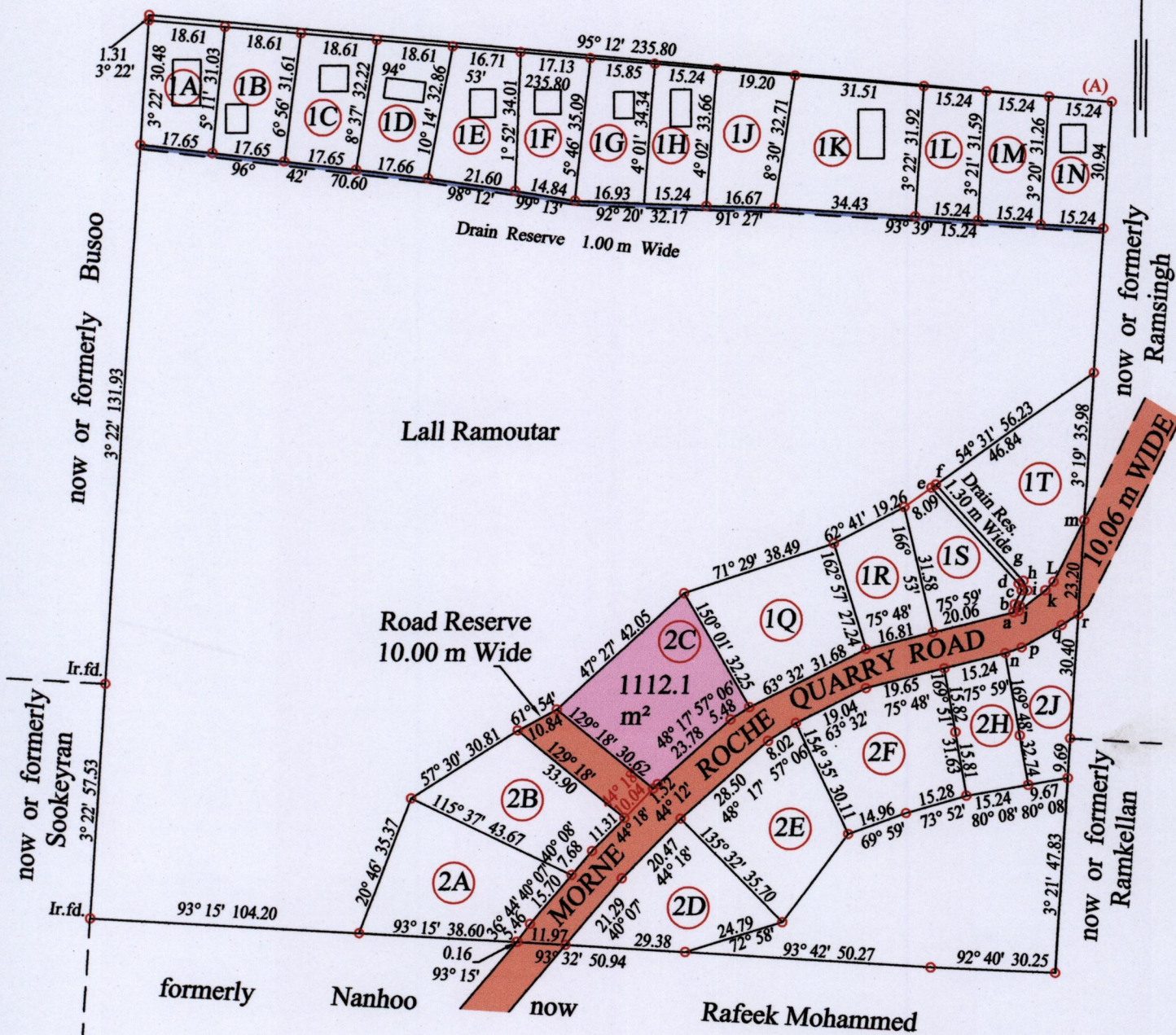

Vide Bk. 1221 fol. 127
Vide Bk. 1126 fol. 20

At Station (A)
E 0676371
N 1143180
Reading taken with
Handheld G.P.S.
U.T.M. Zone 20
Naparima
+ 5 m.

a - b	08° 48'	1.24	i - j	08° 48'	1.24
b - c	25° 54'	3.81	j - k	51° 23'	8.10
c - d	56° 11'	1.78	k - L	43° 28'	2.90
d - e	137° 55'	31.76	L - m	26° 03'	16.83
e - f	54° 31'	1.30	n - p	70° 39'	4.22
f - g	137° 55'	31.83	p - q	60° 32'	11.13
g - h	156° 11'	2.59	q - r	56° 58'	4.74
h - i	25° 54'	4.21			

o Denotes Iron put except stated otherwise.

SCALE : 1:1500

Note: Bearings are U.T.M. grid based on solar observations

Distances are in metres

PLAN of a parcel of land coloured pink in the Ward of Pointe - a - Pierre
Containing one thousand one hundred and twelve point one square metres
Surveyed by me, with due authority, in April 2013 for Lall Ramoutar

Certified Correct in accordance with Regulation 25(1) of the Land Surveyors Regulations 1998

Checked by *Kelvin Ramdass*

Entered on

Trinidad & Tobago Land Surveyor *18/05/2015*

