

DE:198812604089

Process IDA109954

Ward of La Brea
County of St. Patrick
Cadastral Sheet G.6 .J, 62C
3/b

L.P.No.68/8,
Neranthar Trace,
Bodoosingh Road,
Rousillac

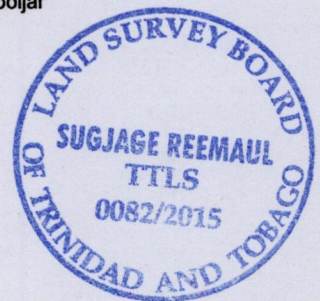
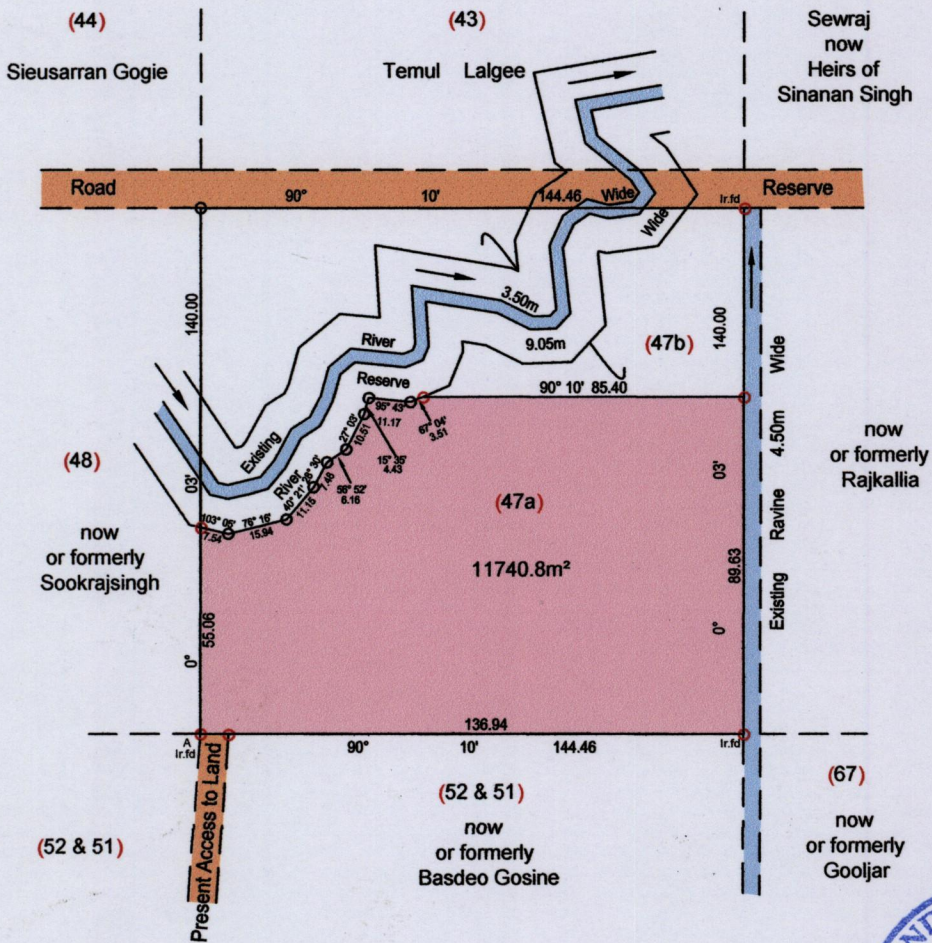

A = N 1129278
E 0654220

Note: U.T.M Naparima 20 (GPS +/- 5.0m)

- o Denotes No.Marks.
- o Denotes Iron put except stated otherwise.

Note: Bearings are cassini grid based on solar observations

Vide: Bk.454 fol.146

SCALE : 1:2000

Distances are in metres

PLAN of a Parcel of land coloured pink in the Ward of La Bera
Containing eleven thousand seven hundred and forty point eight square metres
Surveyed by me, with due authority, in June 2015 for Gosine & Ors.
Certified correct in accordance with Regulation 25 (1) of the Land Surveyors Regulations 1998.

.....*Sheeman*.....

Entered on *18* June,2015

