

Reg. Deed # 6766 / 1942 **1559**

Ward of La Brea
County of St. Patrick
Cadastral Sheet G.6. J. 62 C.
4/b

39

Process **109445**

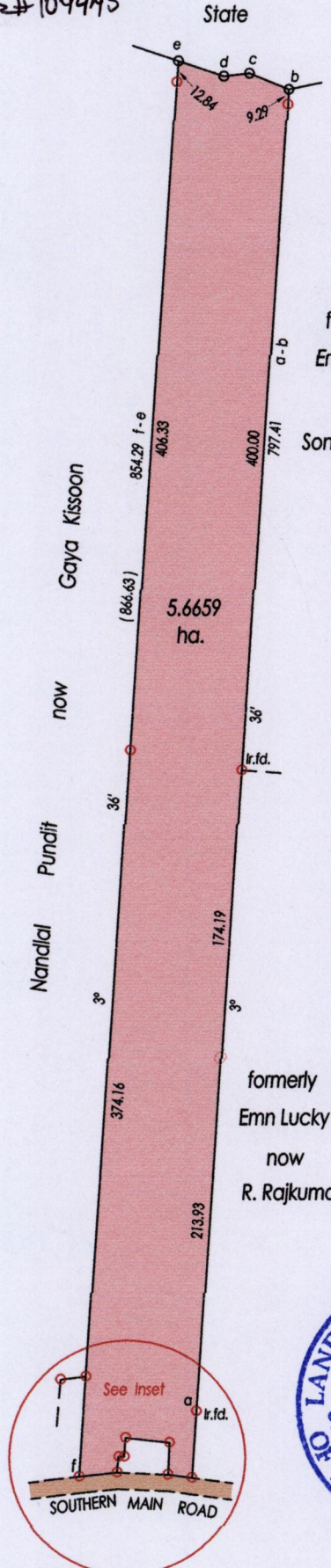

b-c 291° 48' 25.75
 c-d 263° 20' 15.59
 d-e 288° 12' 28.89

formerly
Emn Lucky
now
Sonny Ramsumair

wire fence
 x x x x x
 Z = N. 1129886 E. 655435
 U.T.M. Zone 20 Naparima +/- 5.00 m.
 Hand Held G.P.S.

GN
 U.T.M.

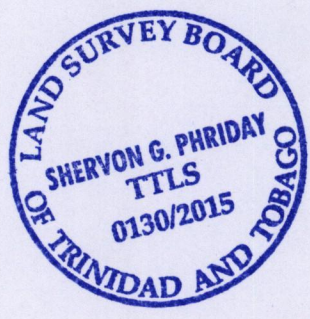
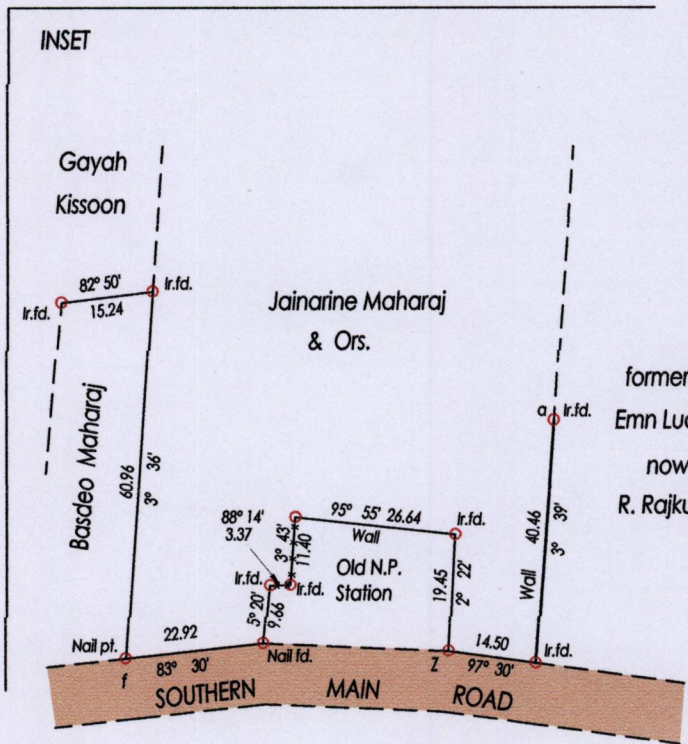

SCALE 1 : 1250
 Distances are in metres

Bk 981 fol. 46

o Denotes Iron Put Except Stated Otherwise

SCALE 1 : 4000

Bearings are U.T.M. Grid based on Solar Observations Distances are in Metres
 PLAN of a parcel of land coloured pink in the Ward of La Brea
 Containing five point six six five nine hectares
 Surveyed by me, with due authority, in April 2015 at the request of Jainarine Maharaj
 Certified Correct in accordance with Regulation 25 (1) of the Land Surveyors
 Regulation 1998.

.....*Shervon Phriday*.....

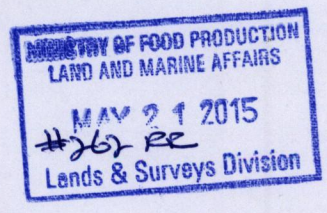

Entered on..... Trinidad & Tobago Land Surveyor *20th May*2015

598