

U.P.R.N.

Process *SD#109412*

X - 642,254mE, 1121,712mN
 UTM ZONE 20, Naparima (+/- 2.00M)
 Direct Observation-GPS Hand held

Line	Brg.	Dist.
A - B	8° 23'	3.52
B - C	23° 59'	6.54
C - D	11° 43'	7.54
D - E	8° 11'	2.76

Cadastral Sheet F. 14. O., **72A**
 1/a

Ward of La Brea

County of St. Patrick

See Registered Deed No.:

DE201100242577

Ref. Plan A.F. 52

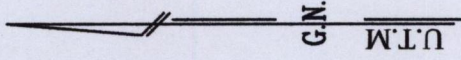

1559

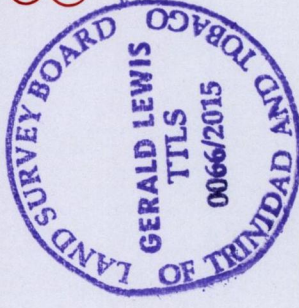

SCALE 1: 1250

Distances are in Metres

25

Ramesh Ramnath Singh

 Trinidad & Tobago Land Surveyor *26/04/2015*

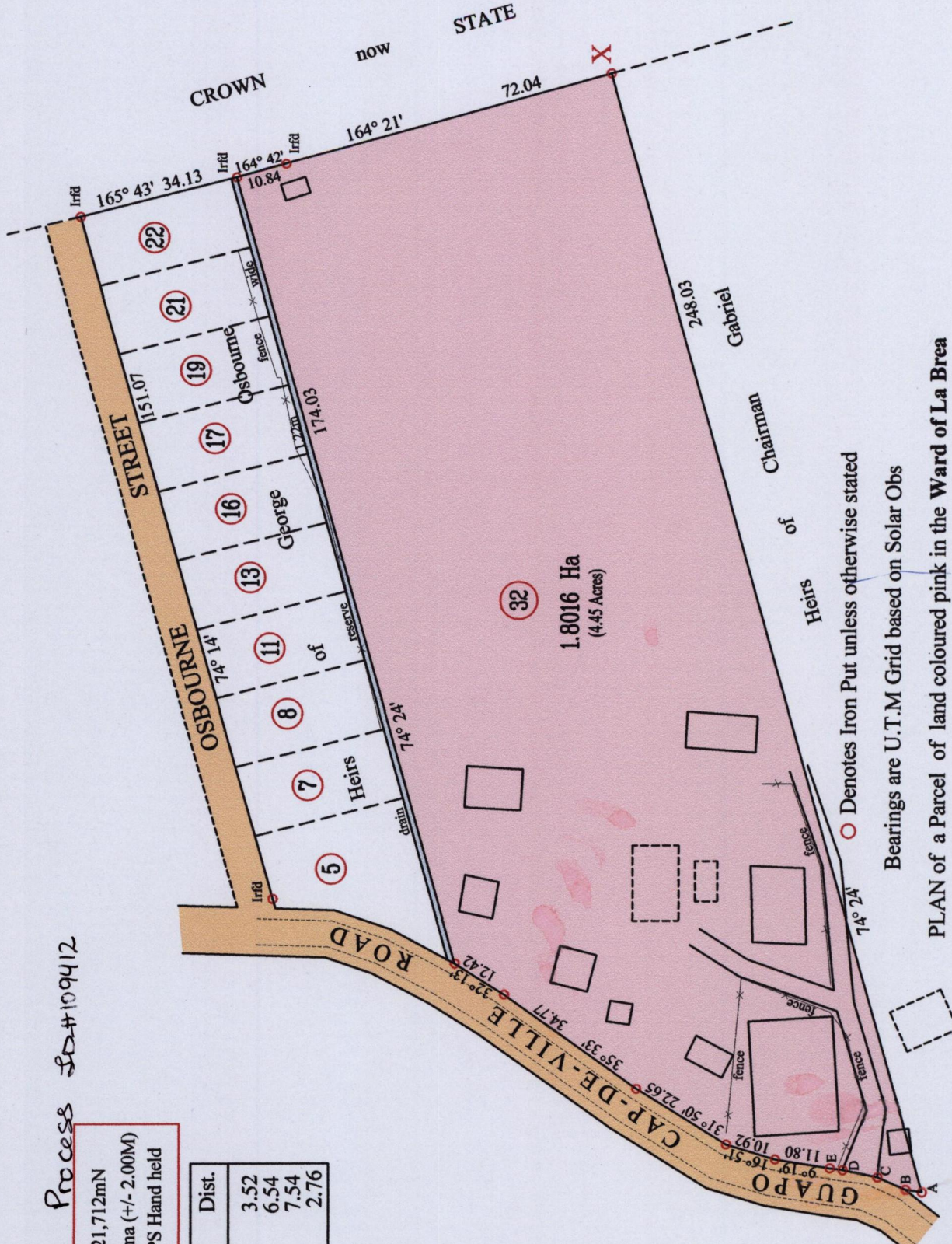

PLAN of a Parcel of land coloured pink in the Ward of La Brea

Containing **one point eight zero one six hectares**

Surveyed by me, with due authority, in March 2015 at the request of **Ramesh Ramnath Singh**

Certified Correct in accordance with Regulation 25(1) of the Land Surveyors Regulations 1998

Entered on

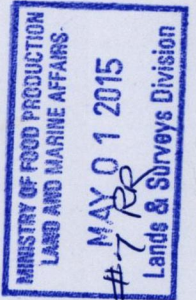

59P