

1558

89

U.P.R.N.....

Process ID # 109284

Coordinates

Rail fd.2 : N 1126209
E 678927

Error Statement : ±3m

Datum Definition : U.T.M. Zone 20 Naparima

Source : Garmin Hand Held GPS

Ward of Mourga

County of Victoria

Cadastral Sheet G.14.G., 64D
2/d

Parcel Address: LP #A50,
Oropouche South Trace,
Barrackpore.

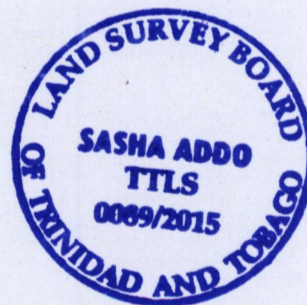
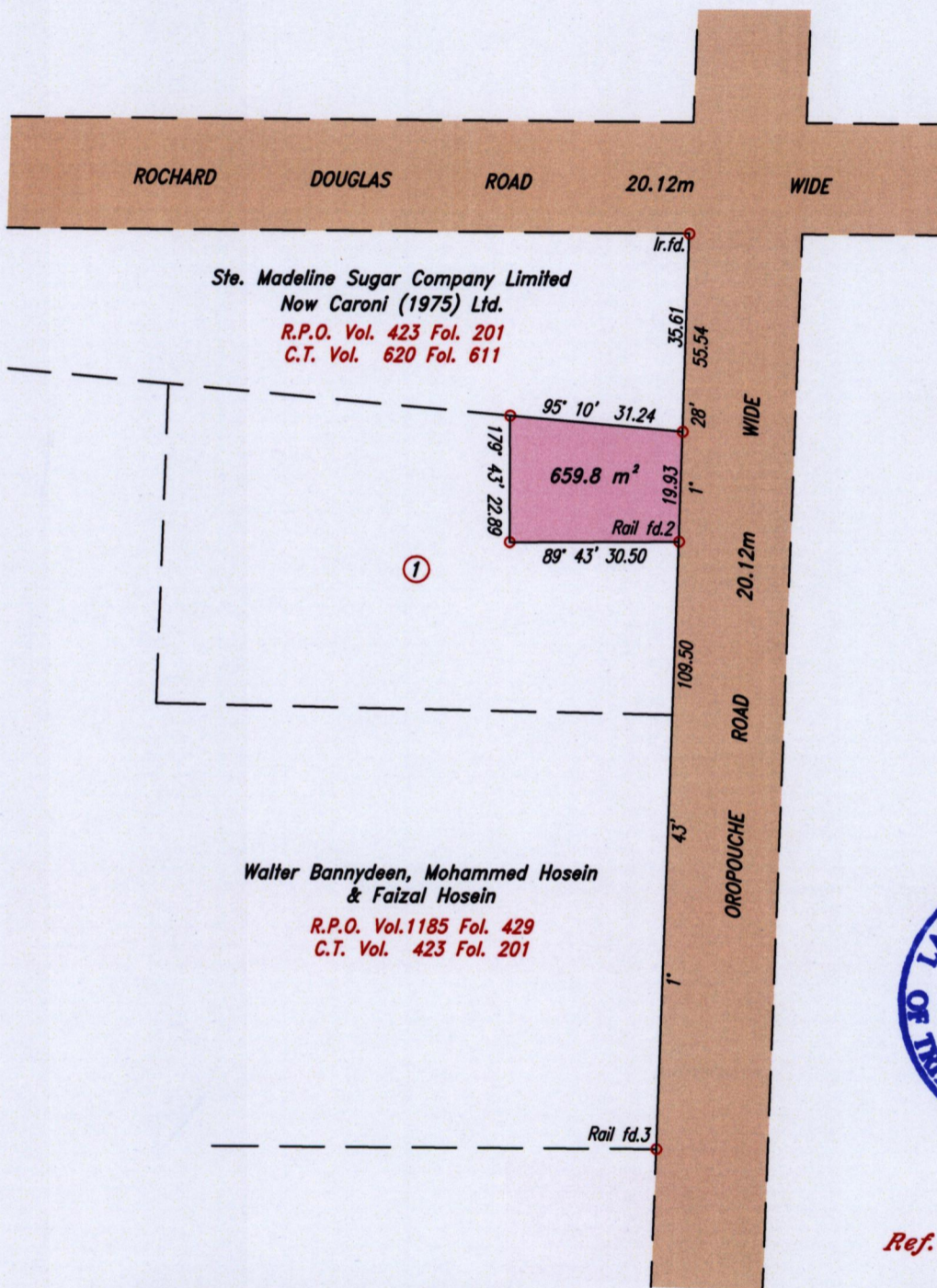

Ref. : Bk.1256 Fol.116

SCALE: 1:1250

Distances are in metres.

○ Denotes Iron put except stated otherwise.

Note: Bearings are U.T.M. Grid based on solar observations.

Plan of a Parcel of land coloured pink in the Ward of Mourga

Containing six hundred and fifty nine point eight square metres

Redefined by me, with due authority, in February 2015 at the request of South West Regional Health Authority.

Certified correct in accordance with Regulation 25 (1) of the Land Surveyors Regulations 1998.

Sasha Addo

Entered

Trinidad & Tobago Land Surveyor *10 April* 2015

