

1558

80

U.P.R.N.....

Process ID#

Ward of Naparima  
County of Victoria

Cadastral Sheet G.3.M., 53E  
4/c

Parcel Address: Lot#73 Coral Drive,  
Gulf View,  
San Fernando.

**Coordinates**

Ir.pt.A : N 1134296  
E 666882

Error Statement : ±4m

Datum Definition : U.T.M. Zone 20 Naparima

Source : Garmin Hand Held GPS

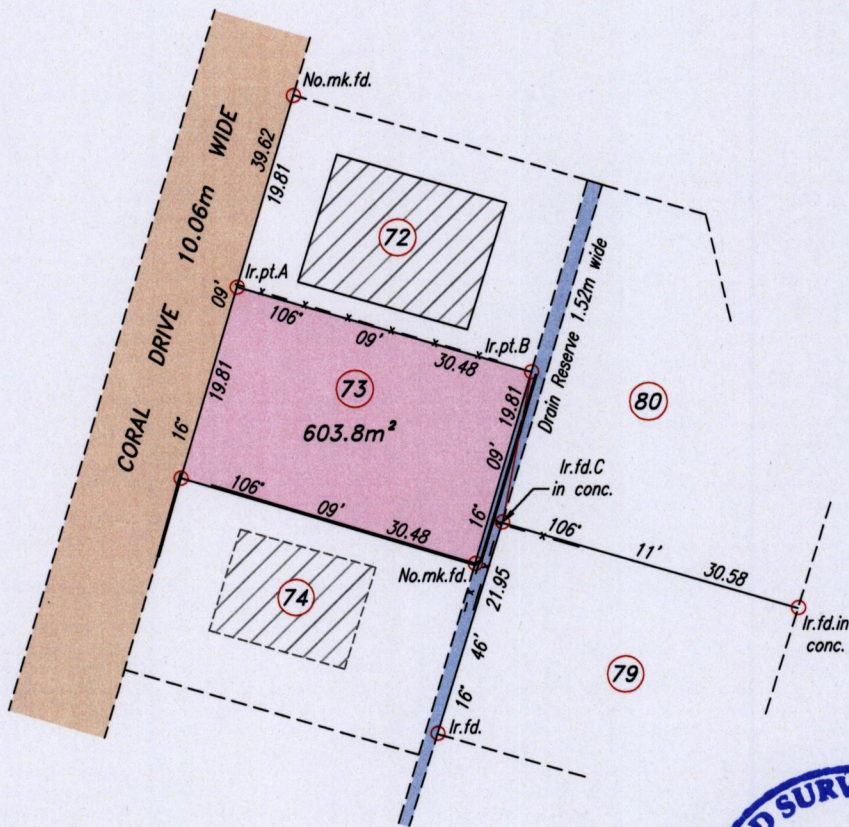

LEGEND	
	Concrete Wall
	Chain Link Wire Fence
	Building/House
	Unsurveyed Building/House

STATION	BEARING	DISTANCE
Ir.pt.B-		
Ir.fd.C in conc.	10° 27'	15.29



Ref.: Plan J.B.26

SCALE: 1:750

○ Denotes Iron put except stated otherwise.

Note: Bearings are U.T.M. Grid based on solar observations.

Distances are in metres.

Plan of a Parcel of land coloured pink in the Ward of Naparima  
Containing six hundred and three point eight square metres.

Surveyed by me, with due authority, in March 2015 at the request of Devanand Rambaran.

Certified correct in accordance with Regulation 25 (1) of the Land Surveyors  
Regulations 1998.

*Sasha Addo*

Entered .....

Trinidad & Tobago Land Surveyor *31 March* 2015

