

Process ~~SD~~ 110900

1558

Cadastral Sheet H.4.D. $\frac{56B}{4/c}$
 Ward of Ortoire
 County of Mayaro

192

General Plan in R.D. 13882/1976

Naparima Mayaro Road,
Mafeking.

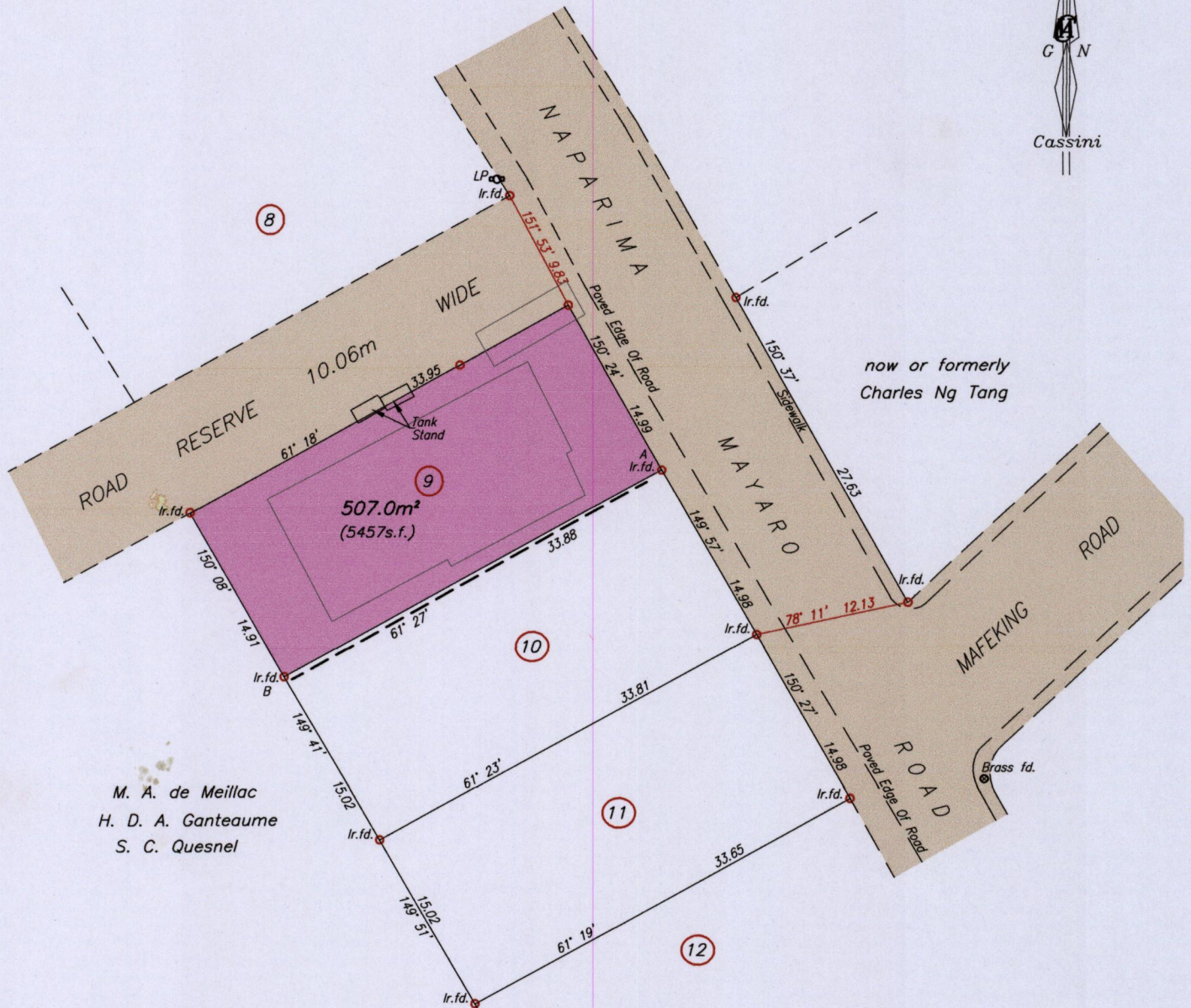
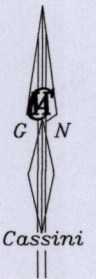

M. A. de Meillac
 H. D. A. Ganteaume
 S. C. Quesnel

Bk. 298:52

Station	Bearing	Distance	Station
A	330° 27'	26.45	LP
A	133° 58'	35.21	Brass fd.

A N. 1139 595 Hand Held GPS
 E. 0716 746 WGS84 Zone20

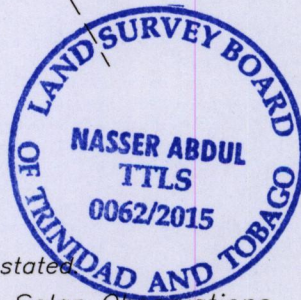

--- Wall

SCALE 1/500

Distances are in metres

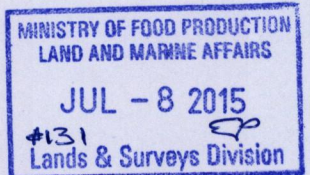

○ Denotes No Mark Put unless otherwise stated
 Bearings are Cassini Grid based on Solar Observations
 PLAN of a Parcel of land coloured pink in the Ward of Ortoire
 Containing five zero seven point zero square metres
 Surveyed by me, with due authority, in July 2015 for Clifford Campbell

Certified Correct In accordance with Regulation 25 (1) of the Land Surveyors' Regulations 1998,

Entered on

Trinidad & Tobago Land Surveyor 2015

Nasser Abdul TTLS
 8th July