

Process SD# 110891

U.P.R.N. ....

Ward of Naparima

County of Victoria

Cadastral Sheet G.9.k 64A.  
3/b

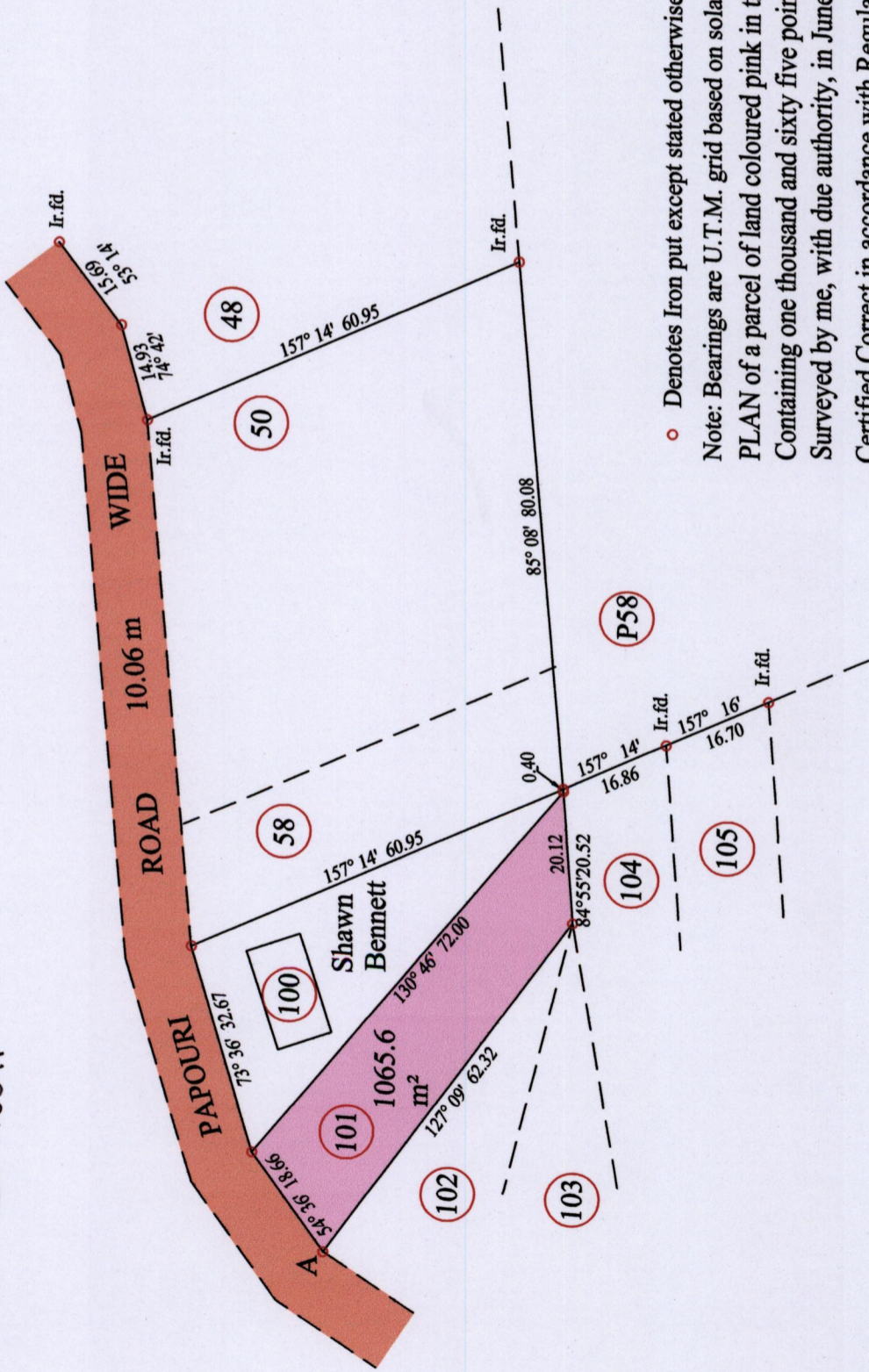

At Station (A)  
 E 676778  
 N 1130600  
 Reading taken with  
 Handheld G.P.S.  
 U.T.M. Zone 20  
 WGS84  
 ± 5 m.

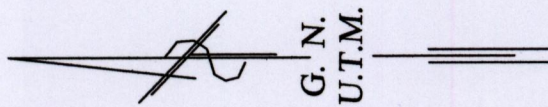

1558



190

SCALE : 1:1000

Distances are in metres

○ Denotes Iron put except stated otherwise.

Note: Bearings are U.T.M. grid based on solar observations

PLAN of a parcel of land coloured pink in the Ward of Naparima

Containing one thousand and sixty five point six square metres

Surveyed by me, with due authority, in June 2015 for Brian Simmons

Certified Correct in accordance with Regulation 25(1) of the Land Surveyors Regulations 1998

Checked by *Kevin Ramdass* .....

Entered on ..... Trinidad & Tobago Land Surveyors Association ..... 2015

