

1558

1837

U.P.R.N.....

Process *JDH* 110883

Ward of Naparima
County of Victoria
Cadastral Sheet G.8.N., $\frac{63C}{3/a}$

Coordinates

Ir.f.d. A : N 1129346
E 669575

Error Statement : $\pm 3m$

Datum Definition : U.T.M. Zone 20 Naparima

Source : Magellan Hand Held GPS

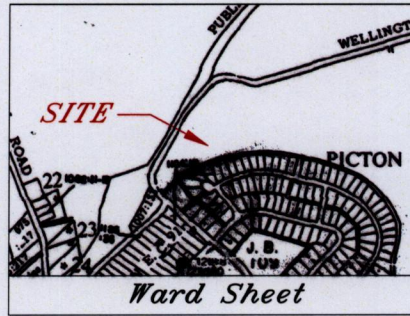

Parcel Address: Wellington Road,
Debe.

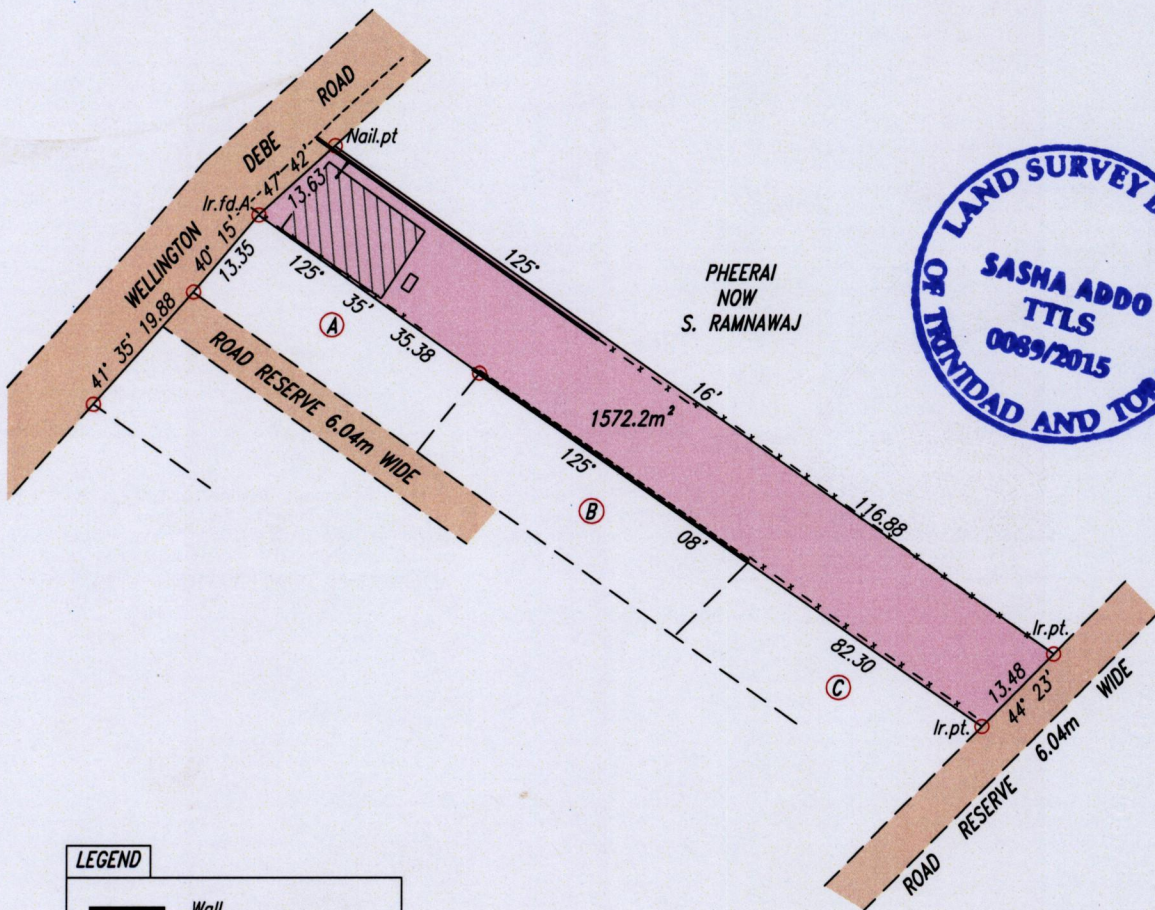

LEGEND	
	Wall
	Building
	Septic Tank
	Existing Drain
	Chain Link Wire Fence

Ref.: E.C. 91
Deed# 2323 of 1971
Bk.1126 Fol.34
Bk.1230 Fol.48

SCALE: 1:1000

○ Denotes Iron found except stated otherwise.

Note: Bearings are U.T.M. Grid based on solar observations.

Distances are in metres.

Plan of a Parcel of land coloured pink in the Ward of Naparima
Containing one thousand five hundred and seventy two point two square metres
Surveyed by me, with due authority, in May 2015 at the request of Sandra Ramasami.
Certified correct in accordance with Regulation 25 (1) of the Land Surveyors
Regulations 1998.

SASHA ADDO

Entered Trinidad & Tobago Land Surveyor *6 July* 2015

