

U.P.R.N. ....

Process SD# 110870

now or formerly  
Bispat Beharry

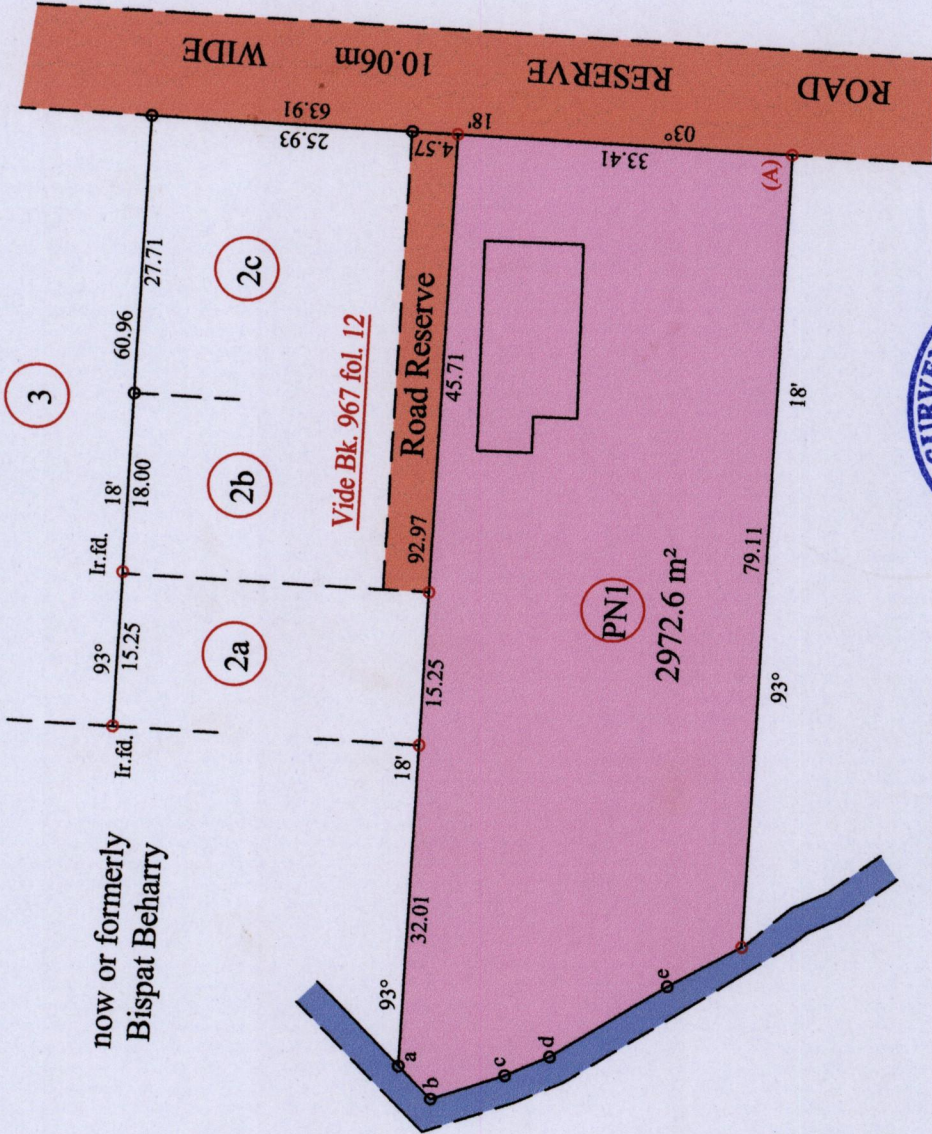

Ward of Naparima  
County of Victoria  
Cadastral Sheet

64 D  
2/d

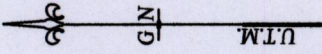

Line	Bearing	Distance
a - b	226° 09'	4.59
b - c	162° 20'	7.78
c - d	157° 39'	4.85
d - e	149° 21'	13.61
e - Ir.	152° 19'	8.39

At Station (A)  
E 0675763  
N 1127412  
Reading taken with  
Handheld G.P.S.  
U.T.M. Zone 20  
Naparima  
+ 5 m.

1558

183

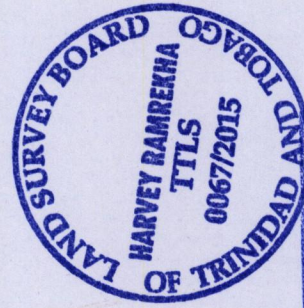

MINISTRY OF FOOD PRODUCTION  
LAND AND MARINE AFFAIRS  
JUL - 3 2015  
#54  
Lands & Surveys Division

SCALE : 1:750

Note: Bearings are U.T.M. grid based on solar observations Distances are in metres

PLAN of a parcel of land coloured pink in the Ward of Naparima

Containing two thousand nine hundred and seventy two point six square metres

Surveyed by me, with due authority, in May 2015 for Pertina Nanan

Certified Correct in accordance with Regulation 25(1) of the Land Surveyors Regulations 1998

Checked by .....

Entered on ..... Trinidad & Tobago Land Surveyor ..... 30.06.2015