

U.P.R.N. ....

Process *SD# 110680*

1558

Ward of Naparima  
County of Victoria  
Cadastral Sheet

164

63 B  
2/b

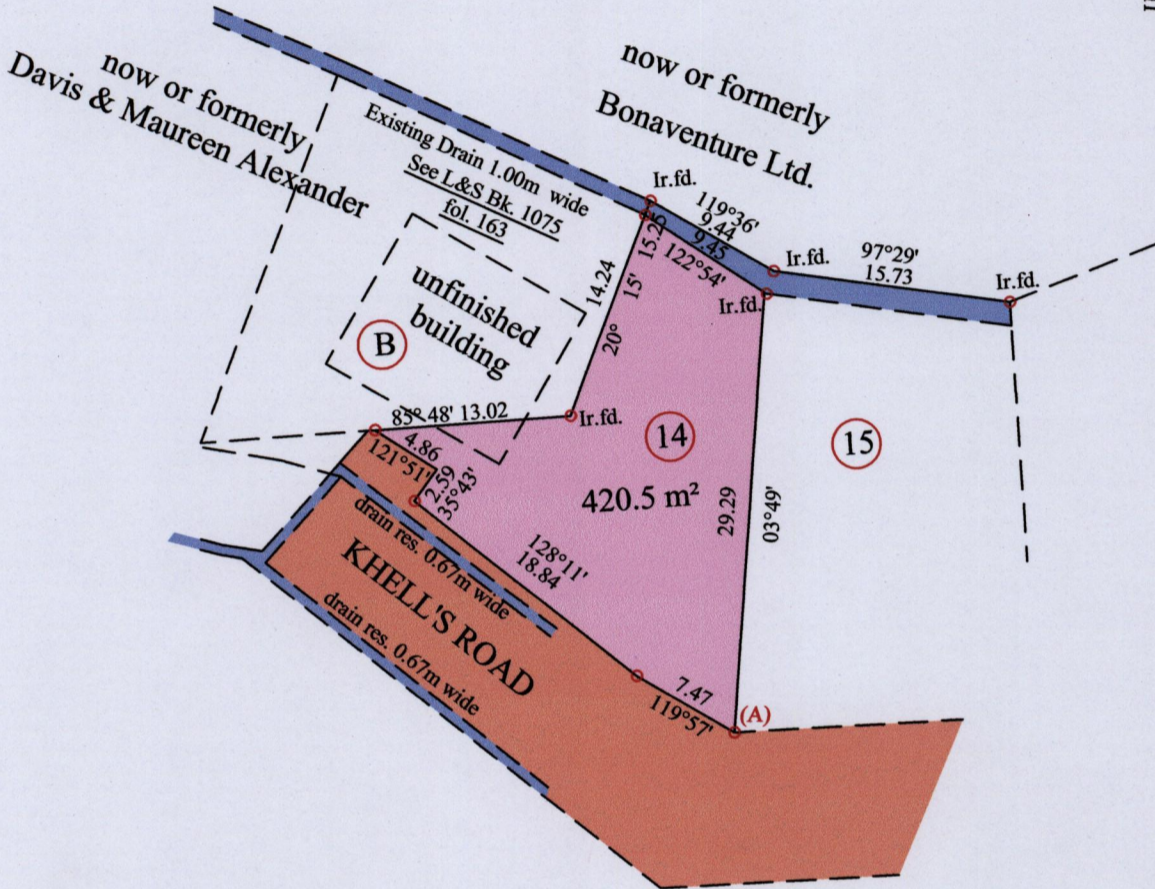
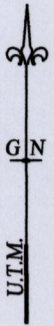

At Station (A)  
E 0668114  
N 1133187  
Reading taken with  
Handheld G.P.S.  
U.T.M. Zone 20  
Naparima  
± 10 m.



○ Denotes Iron put except stated otherwise.

SCALE : 1:500

Note: Bearings are U.T.M. grid based on solar observations Distances are in metres

PLAN of a parcel of land coloured pink in the Ward of Naparima  
Containing four hundred and twenty point five square metres  
Surveyed by me, with due authority, in March 2015 for Anthony Alkhal  
Certified Correct in accordance with Regulation 25(1) of the Land Surveyors Regulations 1998

Checked by .....

Entered on ..... Trinidad & Tobago Land Surveyor .....

