

Ward of Naparima  
 County of Victoria  
 Cadastral Sheet (G.8.P.)  $\frac{63C}{4/d}$

Reference :  
 Plan J.B. 132  
 Bk.1261 fol.108

Process *SD# 110628*

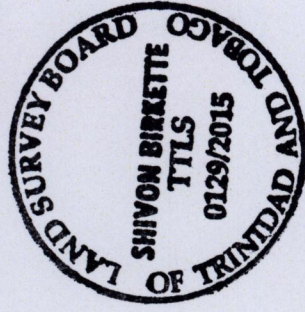

Co-ordinates

Ir.pt. A : N 1128499  
 E 673584

Error Statement:  $\pm 4m$   
 Datum Definition: U.T.M. Zone 20 Naparima  
 Source: Garmin Vista Hand Held GPS

SCALE: 1:750

Distances are in metres.

151

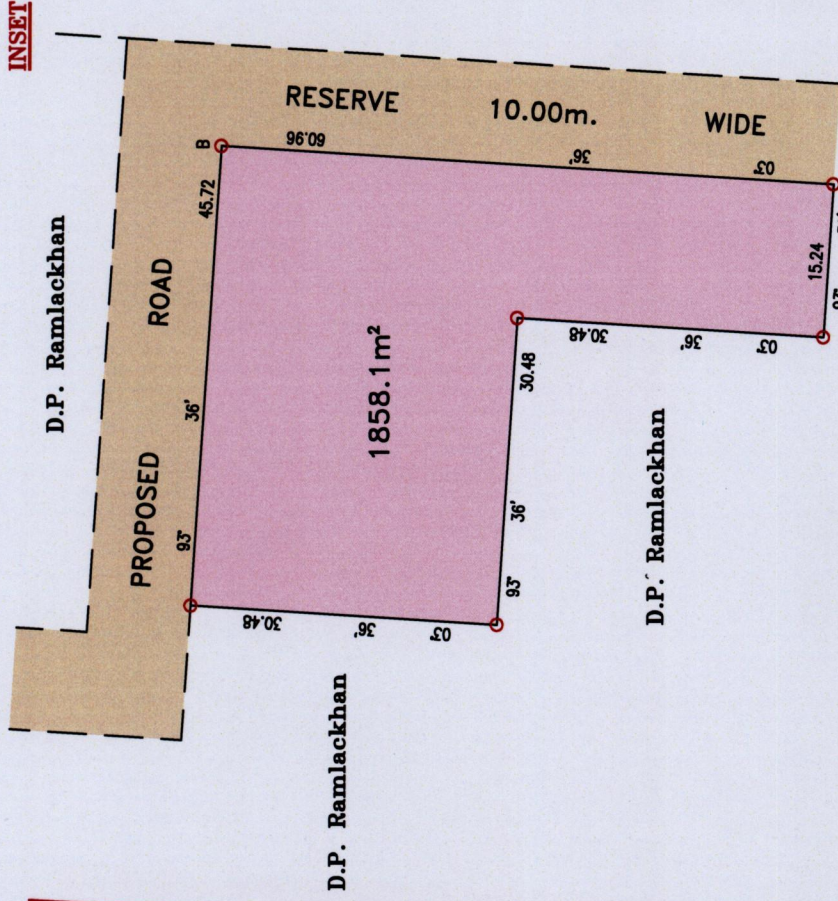
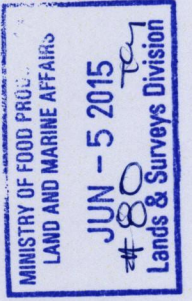

○ Denotes Iron put except where otherwise stated

Note: Bearings are CASSINI Grid based on solar observations.

Plan of a Parcel of land coloured pink in the Ward of Naparima

Containing one thousand eight hundred and fifty eight point one square metres

Surveyed by me, with due authority, in May 2015 at the request of Ms. Laura Seenath

Certified correct in accordance with Regulation 25 (1) of The Land Surveyors' Regulations 1998,

*Shivon Birkette*

Trinidad & Tobago Land Surveyor ...05/05/.....2015

Entered .....

