

1558

148

U.P.R.N.

Process *It* #110620

City of San Fernando

County of Victoria

Cadastral Sheet G.3.

53.E.
2/d

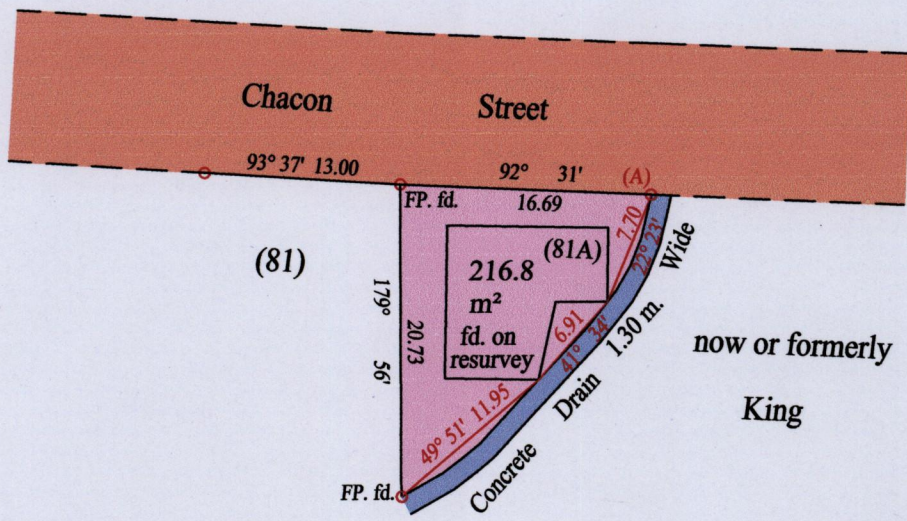
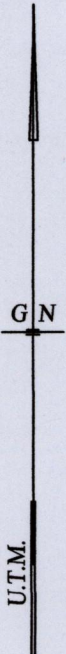

At Station (A)
 E 0668239
 N 1136969
 Reading taken with
 Handheld G.P.S.
 U.T.M. Zone 20
 Naparima
 ± 5 m.

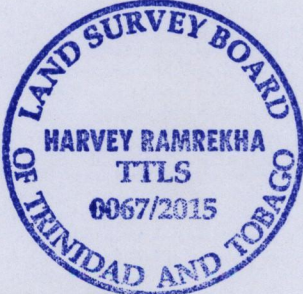

○ Denotes Iron put except stated otherwise.

SCALE : 1:500

Note: Bearings are U.T.M. grid based on solar observations Distances are in metres

PLAN of a parcel of land coloured pink in the City of San Fernando
 Containing two hundred and sixteen point eight square metres
 Surveyed by me, with due authority, in June 2015 for Gemma Maharaj & Ors.
 Certified Correct in accordance with Regulation 25(1) of the Land Surveyors Regulations 1998

Checked by *[Signature]*

Entered on Trinidad & Tobago Land Surveyor *v. 06* 2015

