

U.P.R.N. No.

Vide R.D. 4447 of 1988

Process **SD-110596**

Cadastral Sheet G.4.E 54D  
1/a  
Ward of Naparima  
County of Victoria

CLEGHORN VILLAGE

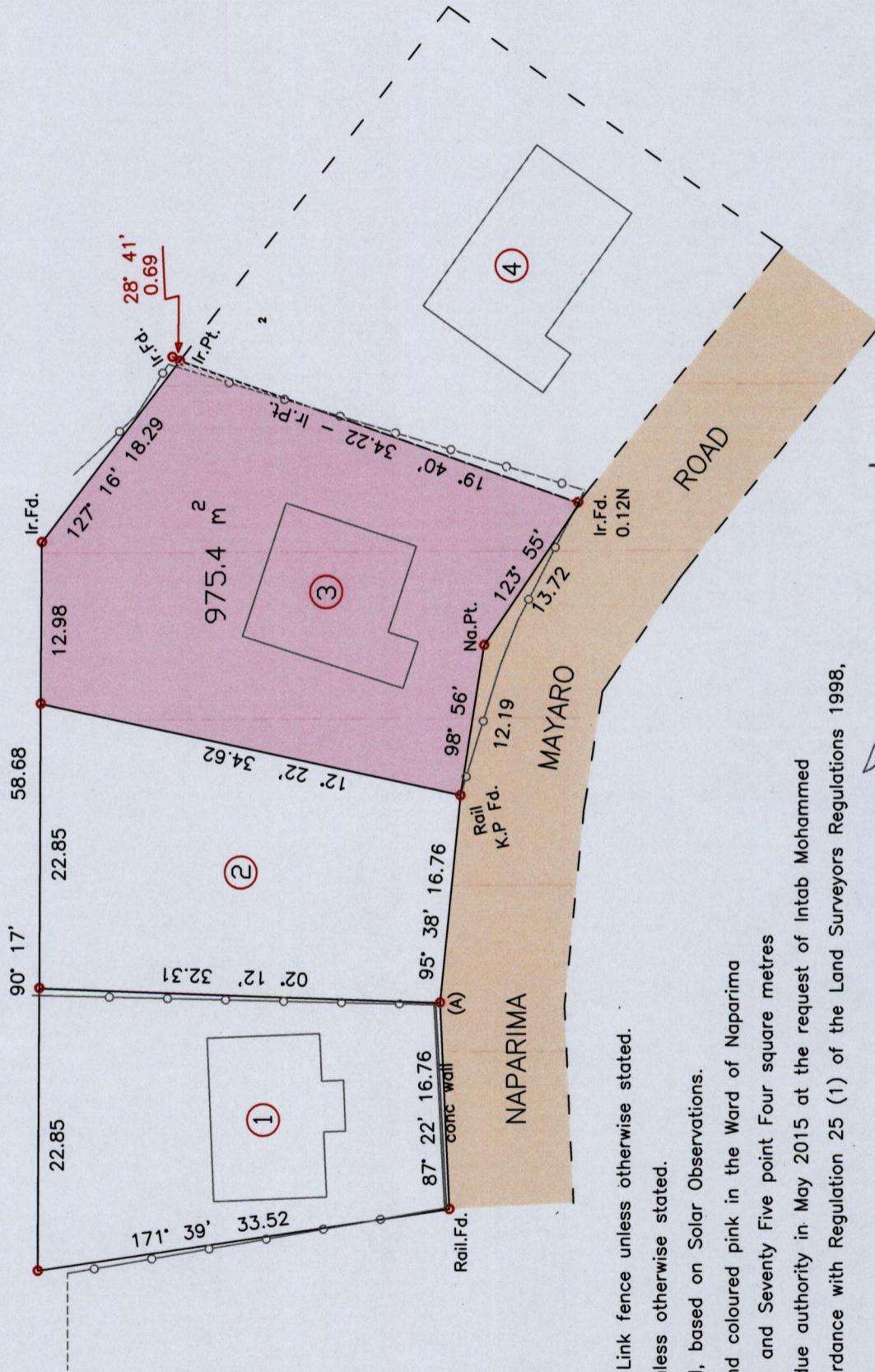

(A)  
U.T.M. 20, Naparima  
( 675272mE, 1137921mN )  
GPS Accuracy (+/- 5m)

○ Denotes Chain Link fence unless otherwise stated.  
● Denotes Iron Put unless otherwise stated.

Bearings are U.T.M. Grid, based on Solar Observations.  
PLAN of a Parcel of land coloured pink in the Ward of Naparima  
Containing Nine Hundred and Seventy Five point Four square metres  
Redefined by me, with due authority in May 2015 at the request of Intab Mohammed  
Certified correct in accordance with Regulation 25 (1) of the Land Surveyors Regulations 1998,

*[Signature]*  
Trinidad and Tobago Land Surveyor

MINISTRY OF FOOD PRODUCTION  
LAND AND MARINE AFFAIRS  
JUN 21 2015  
#15  
Lands & Surveys Division

Entered on .....

*[Signature]*  
30<sup>th</sup> June 2015

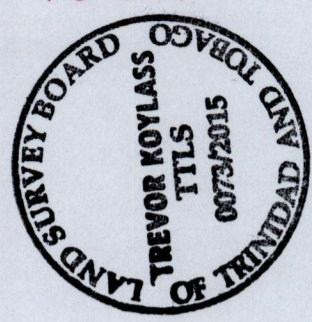
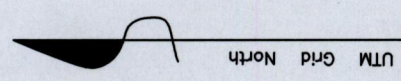

1558

146

SCALE 1 : 500  
Distances are in metres.