

1558

136

Process SD4 109733

U.P.I.N. No.:

City of San Fernando

County of Victoria

Cadastral Sheet  $\frac{53E}{3/d/4}$

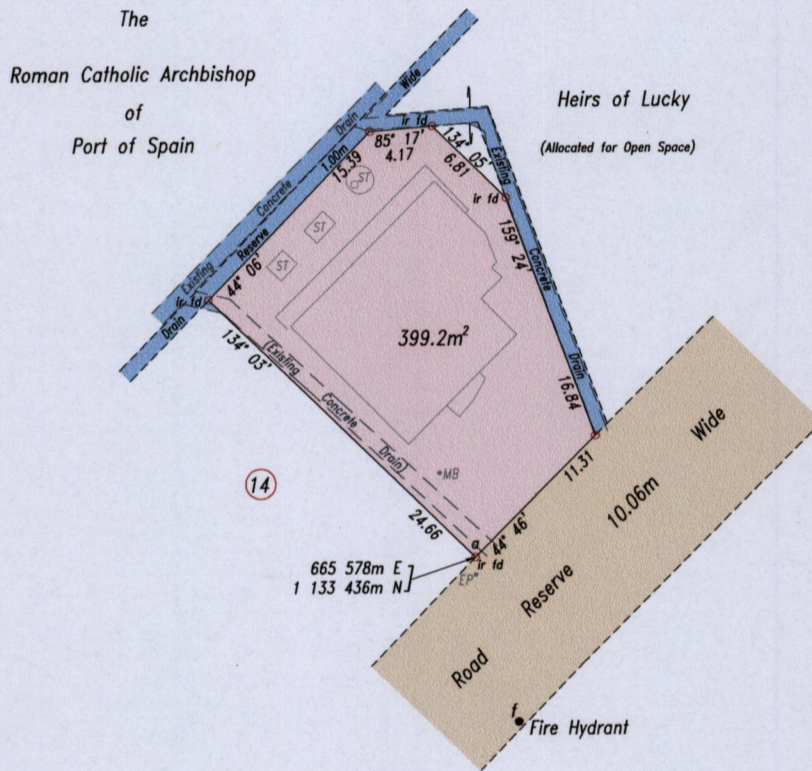
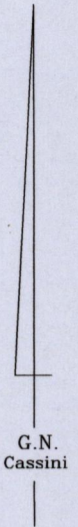

Sta. - Sta.	Bearing	Distance
a - f	165° 13'	11.31
ST	Septic Tank	
MB	Meter Base	
EP	Electricity Pole	

Source: GPS (Hand Held)  
 Error Statement: +/- 5m  
 Datum: Naparima, UTM (Zone 20).

SCALE 1: 500

Distances are in metres

o Denotes iron put except otherwise stated

Bearings are Cassini Grid based on Solar Observations

PLAN of a parcel of land coloured pink in the City of San Fernando  
 Containing three hundred and ninety nine point two square metres  
 Surveyed by me, with due authority, in May 2015 for S. Bissessar

Certified Correct in accordance with Regulation 25(1) of the Land Surveyors' Regulations 1998.

Entered

*S.A. Bissessar*  
 20/5/2015  
 Trinidad & Tobago Land Surveyor

MINISTRY OF FOOD PRODUCTION  
 LAND AND MARINE AFFAIRS  
 MAY 22 2015  
 #272  
 Lands & Surveys Division

