

City of San Fernando
 County of Victoria
 Cadastral Sheet G.7.D

53E
 3/d

G.N.

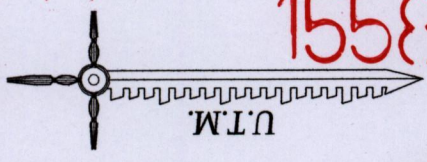

1558

SCALE : 1:4500

129

Vide Bk. 954 fol. 23
 Vide Bk. 1126 fol. 146

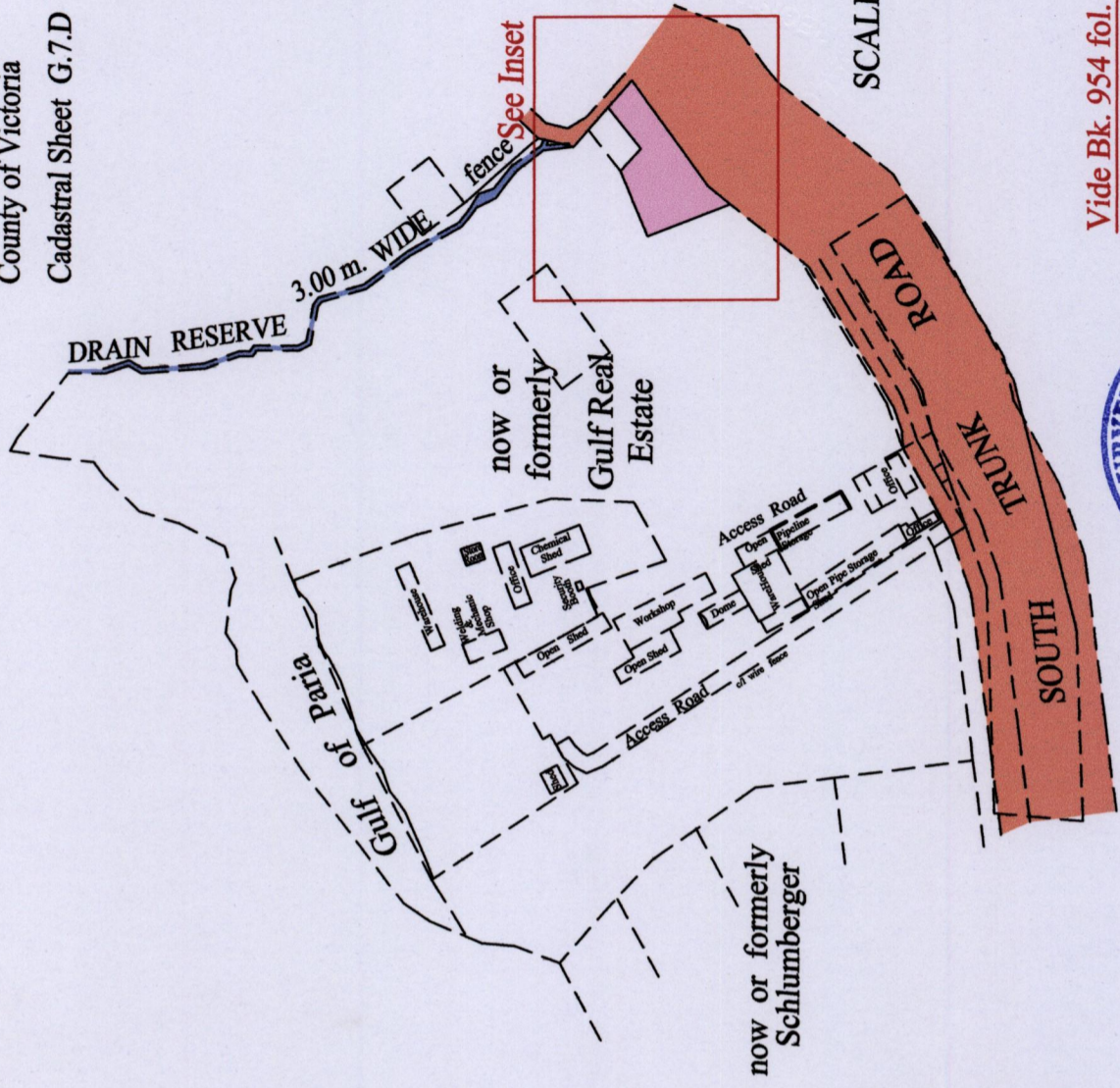

MINISTRY OF FOOD PRODUCTION
 LAND AND MARINE AFFAIRS
 MAY 12 2015
 #141 RR
 Lands & Surveys Division

U.P.R.N.
 Process # 109706

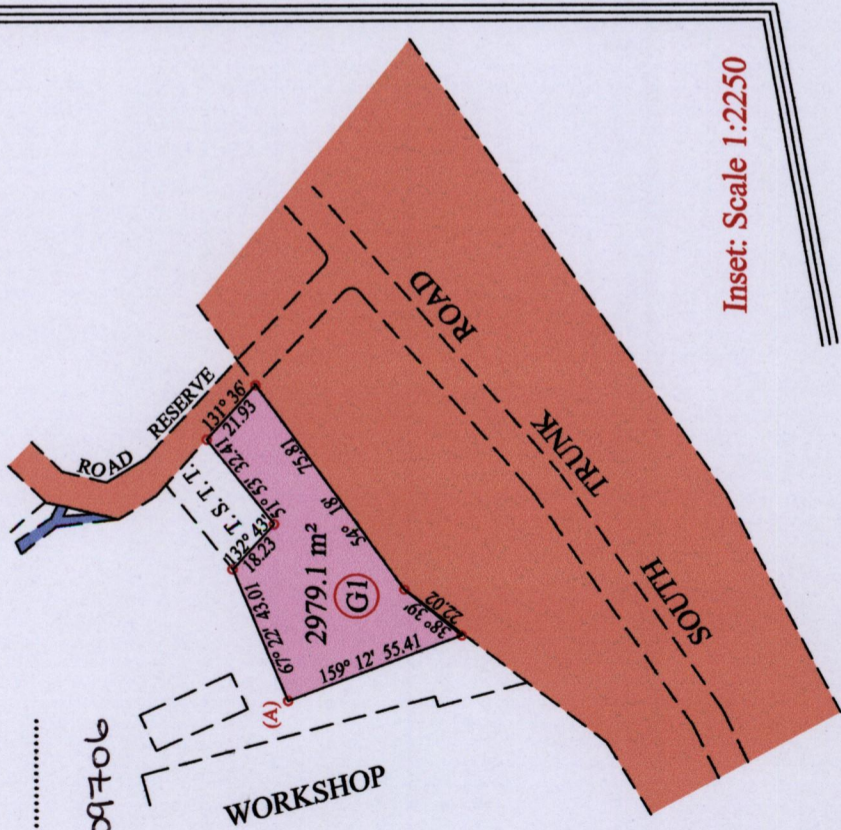

Inset: Scale 1:2250

At Station (A)
 E 0665332
 N 1133224
 Reading taken with
 Handheld G.P.S.
 U.T.M. Zone 20
 Naparima
 + 5 m.

o Denotes Iron put except stated otherwise.
 Note: Bearings are U.T.M. grid based on solar observations Distances are in metres
 PLAN of a Parcel of land coloured pink in the City of San Fernando
 Containing two thousand nine hundred and seventy nine point one square metres
 Surveyed by me, with due authority, in May 2015 for Gulf Real Estate
 Certified Correct in accordance with Regulation 25(1) of the Land Surveyors Regulations 1998

Checked by
 Entered on Trinidad & Tobago Land Surveyor / 2.05.2015