

U.P.R.N.

Process *SDT* 109697

Ward of Naparima

County of Victoria

Cadastral Sheet G.7 $\frac{63.B.}{1/b}$

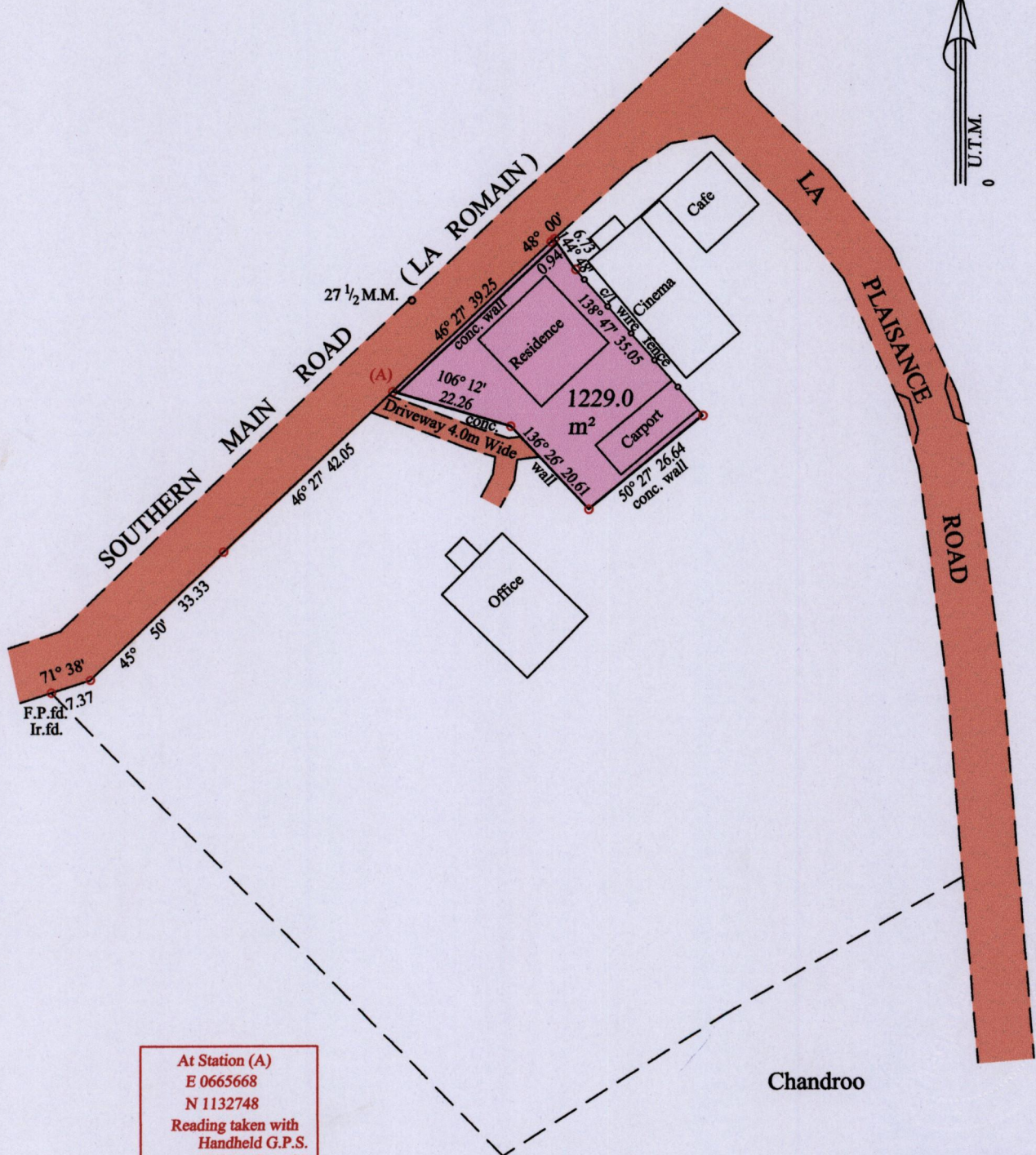

At Station (A)
 E 0665668
 N 1132748
 Reading taken with
 Handheld G.P.S.
 U.T.M. Zone 20
 Naparima
 ± 5 m.

○ Denotes Iron put except stated otherwise.
 Note: Bearings are U.T.M. grid based on solar observations Distances are in metres
PLAN of a parcel of land coloured pink in the Ward of Naparima
 Containing one thousand two hundred and twenty nine point zero square metres
 Surveyed by me, with due authority, in July 2014 for Mrs. Chandroo Maharaj
 Certified Correct in accordance with Regulation 25(1) of the Land Surveyors Regulations 1998

Checked by

Entered on Trinidad & Tobago Land Surveyor 6.05.2015

