

From	To	Bearing	Distance
a	b	47° 11'	13.62

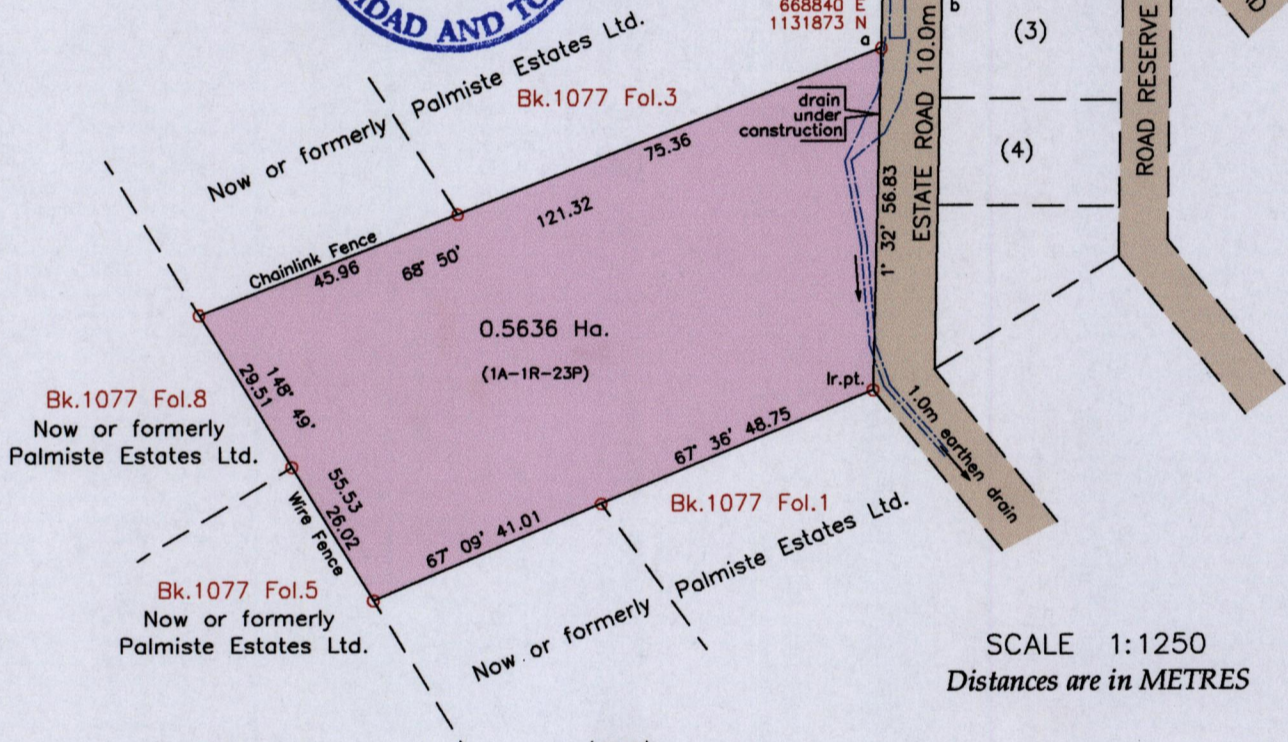

SCALE 1:1250
Distances are in METRES

- References:**
Bk.1077 Fol.2
Bk.1077 Fol.4
- Legend**
Electricity Pole with Transformer ◯ EP
Drain - - - - -

Notes: ◯ Denotes Ir.f.d. unless otherwise indicated
Bearings are U.T.M. Grid based on Solar Observations
Previous survey by Winston Ramcharan in June 2001 for Dr. Gordon Bartlett
Coordinates obtained by handheld GPS (UTM Zone 20, Naparima ± 5.0m)

PLAN of a parcel of land coloured pink in the Ward of Naparima
Containing zero point five six three six hectares
Surveyed by me, with due authority, in April 2015 for Michael Bobb

Certified Correct in accordance with Regulation 25(1) of the Land Surveyors Regulations 1998.

Checked by
Entered on
KM07/2015

Kenneth Mondul
Trinidad and Tobago Land Surveyor, 4th May 2015

