

Ref.: Bk. 807 Fol. 171

Process *LS* # 109470

Cadastral Sheet G.8.D. 63C
Ward of Naparima 2/a
County of Victoria
St. John's Village.

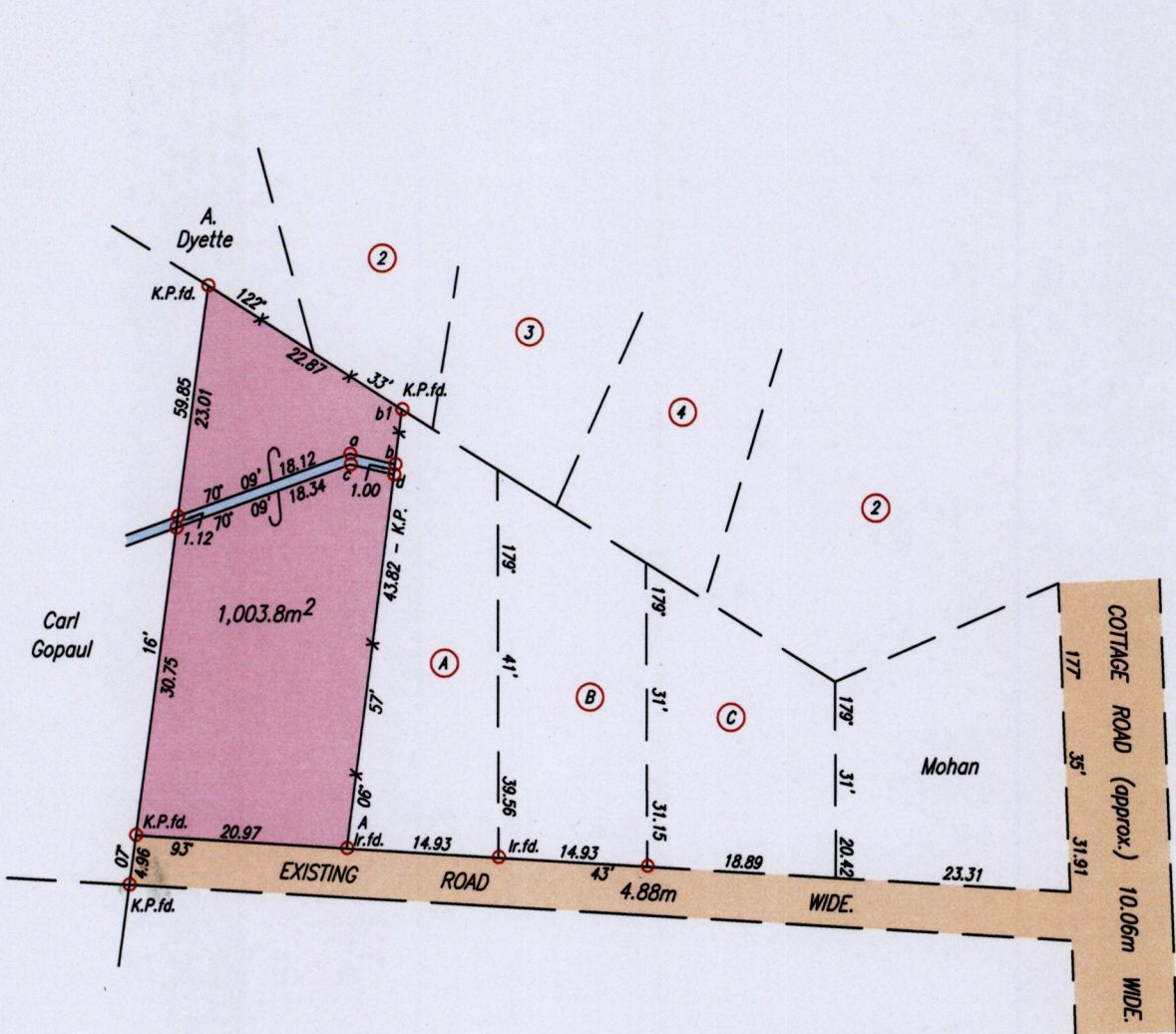

$a - b = 103^{\circ} 03' 4.61$
$c - d = 103^{\circ} 03' 4.42$
$b - b1 = 06^{\circ} 57' 5.44$

Ir.f.d. A.: 672768mE, 1133197mN
(U.T.M. 20, WGS 84 (+/-5m))
Coordinates obtained from
handheld GPS.



==== Denotes Drain 1.00m Wide.

Denotes Fence -x-x-x-x-x-

○ Denotes Iron put except otherwise stated.

Bearings are Cassini Grid based on Solar Observations.

SCALE 1:750

Distances are in Metres

PLAN of a Parcel of land coloured pink in the Ward of Naparima

Containing one thousand and three point eight square metres.

Surveyed by me, with due authority, in July, 2014 for Neela Bahaw

Certified Correct in accordance with Regulation 25(1) of the Land Surveyors' Regulations 1998

[Signature]

Entered Trinidad & Tobago Land Surveyor *16th March* 2015

MINISTRY OF FOOD PRODUCTION
LAND AND MARINE AFFAIRS
APR 30 2015
#388 RR
Lands & Surveys Division

49P