

U.P.R.N.
Process ~~LD~~# 109459

Ward of Naparima
County of Victoria
Cadastral Sheet

63 C
4/d

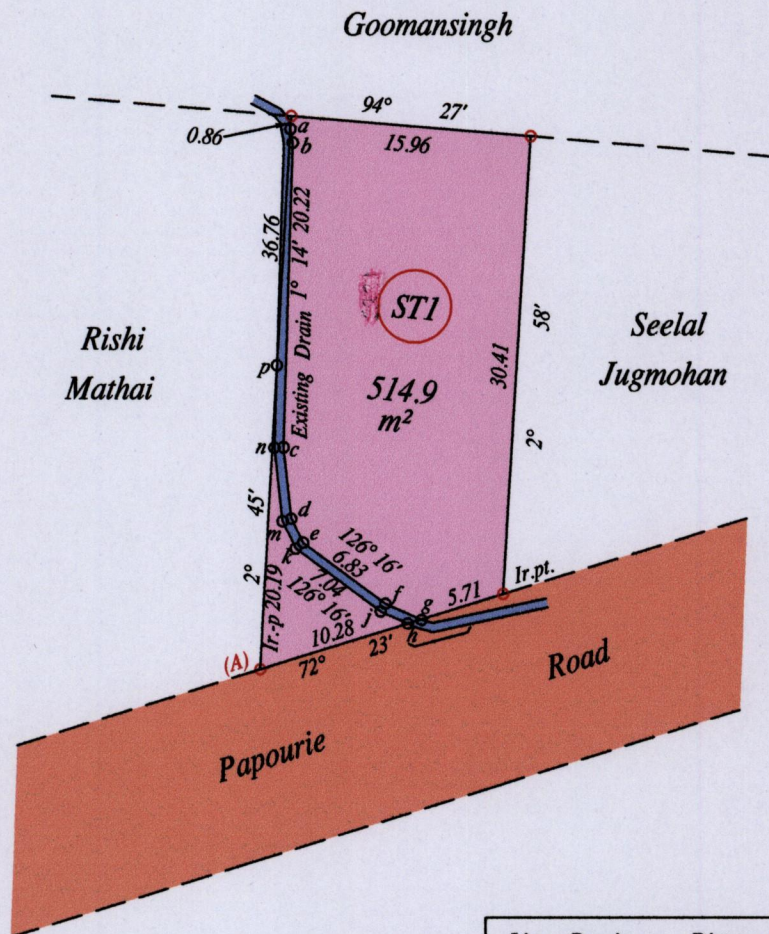

Line	Bearing	Distance
a - b	169° 22'	0.91
c - d	173° 09'	4.72
d - e	153° 58'	1.77
f - g	113° 48'	2.58
g - h	252° 23'	0.91
h - j	293° 48'	1.97
k - m	333° 58'	2.02
m - n	353° 09'	4.87
n - p	1° 14'	5.45
p - a	2° 45'	15.71

At Station (A)
E 0674327
N 11428701
Reading taken with
Handheld G.P.S.
U.T.M. Zone 20
Naparima
± 5 m.

Vide Bk. 1070 fol. 110
Vide Bk. 1119 fol. 86

o Denotes Iron put except stated otherwise.

Note: Bearings are U.T.M. grid based on solar observations

Distances are in metres

PLAN of a parcel of land coloured pink in the Ward of Naparima

Containing five hundred and fourteen point nine square metres

Surveyed by me, with due authority, in April 2015 for Rishi Mathai

Certified Correct in accordance with Regulation 25(1) of the Land Surveyors Regulations 1998

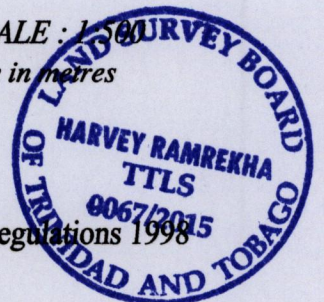

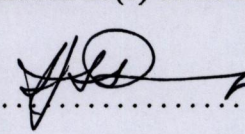
Checked by 

Entered on 29-04-2015
Trinidad & Tobago Land Surveyor

