

Process # 109374
U.P.R.N.

1558

111

Ward of Naparima
County of Victoria
Cadastral Sheet

64A
3/c

G.N.

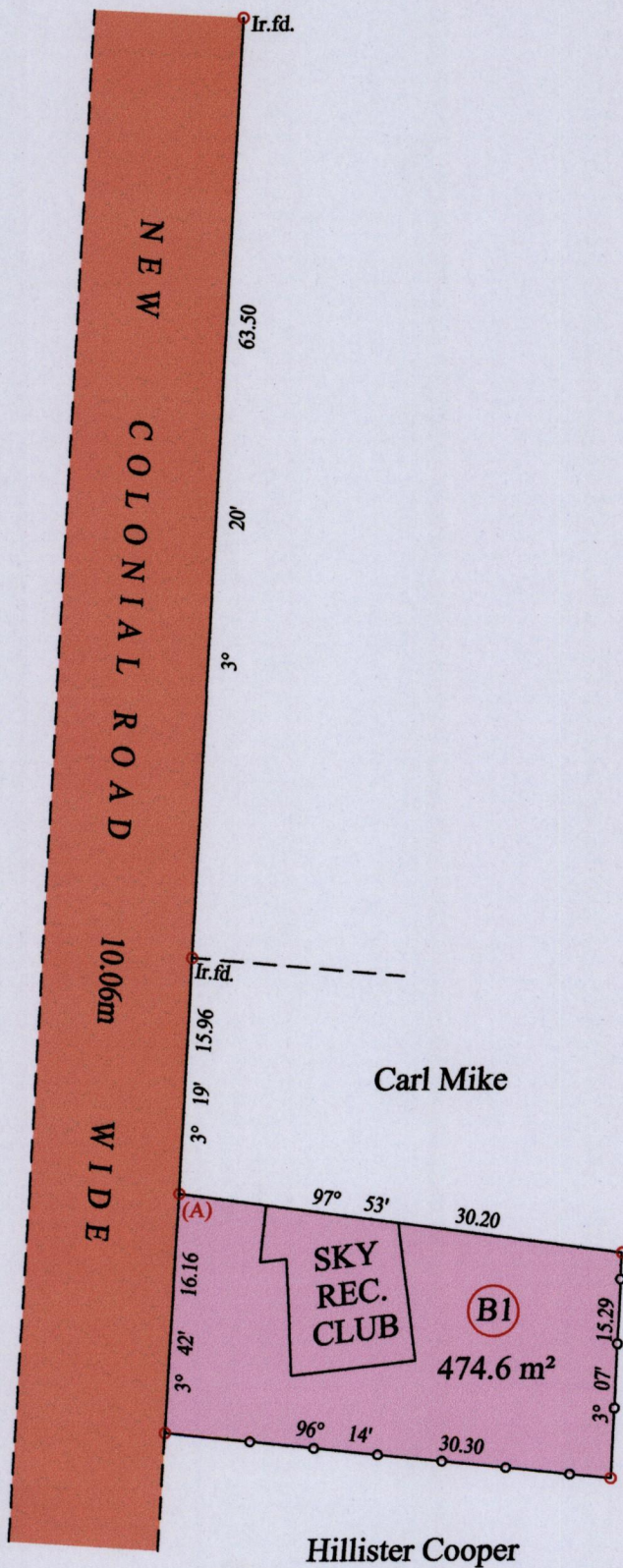
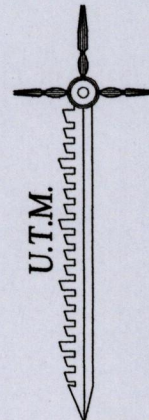

now or formerly
Narain

At Station (A)
E 0675705
N 1128494
Reading taken with
Handheld G.P.S.
U.T.M. Zone 20
Naparima
± 5 m.

○ Denotes Iron put except stated otherwise.

Note: Bearings are U.T.M. grid based on solar observations
 PLAN of a Parcel of land coloured pink in the Ward of Naparima
 Containing four hundred and seventy four point six square metres
 Surveyed by me, with due authority, in March 2015 for Mr. Balraj
 Certified Correct in accordance with Regulation 25(1) of the Land Surveyors Regulations 1998

SCALE : 1:500

Distances are in metres

Checked by

Entered on Trinidad & Tobago Land Surveyor 29. 04. 2015

MINISTRY OF FOOD PRODUCTION
 LAND AND MARINE AFFAIRS
 APR 29 2015
 #365
 Lands & Surveys Division

