

1558

109

U.P.R.N.

Reg. Deed No. DE201300619062D001

Process Lot # 109366

Ward of Naparima

County of Victoria

Cadastral Sheet G.8.D. 53 F
4/d

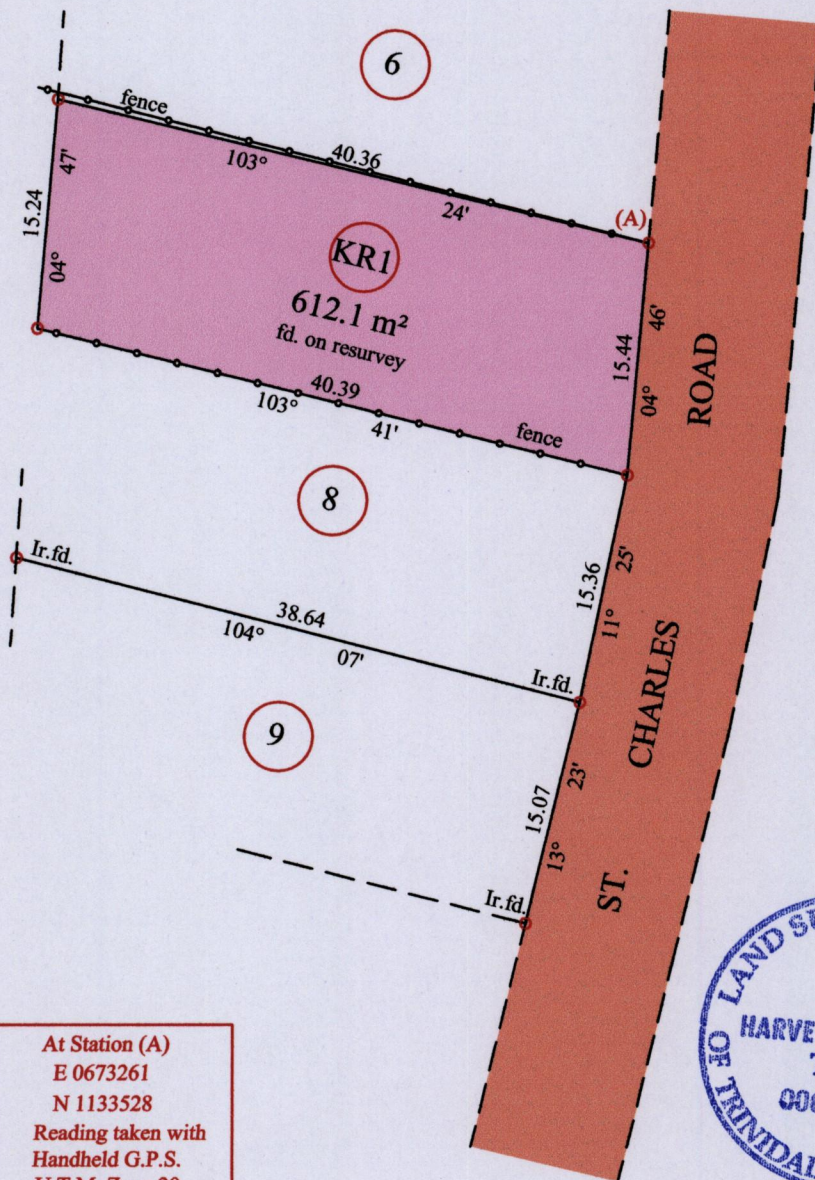
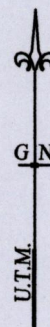

At Station (A)
E 0673261
N 1133528
Reading taken with
Handheld G.P.S.
U.T.M. Zone 20
Naparima
± 5 m.

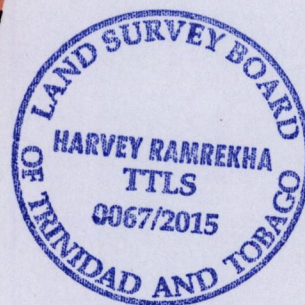

○ Denotes Iron put except stated otherwise.

SCALE : 1:500

Note: Bearings are U.T.M. grid based on solar observations

Distances are in metres

PLAN of a parcel of land coloured pink in the Ward of Naparima

Containing six hundred and twelve point one square metres

Surveyed by me, with due authority, in May 2014 for Kris Roopnarine

Certified Correct in accordance with Regulation 25(1) of the Land Surveyors Regulations 1998

Checked by

Entered on Trinidad & Tobago Land Surveyor 25.04.2015

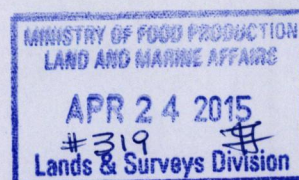

368