

1557

Process ID# 110036

WINDSOR HEIGHTS

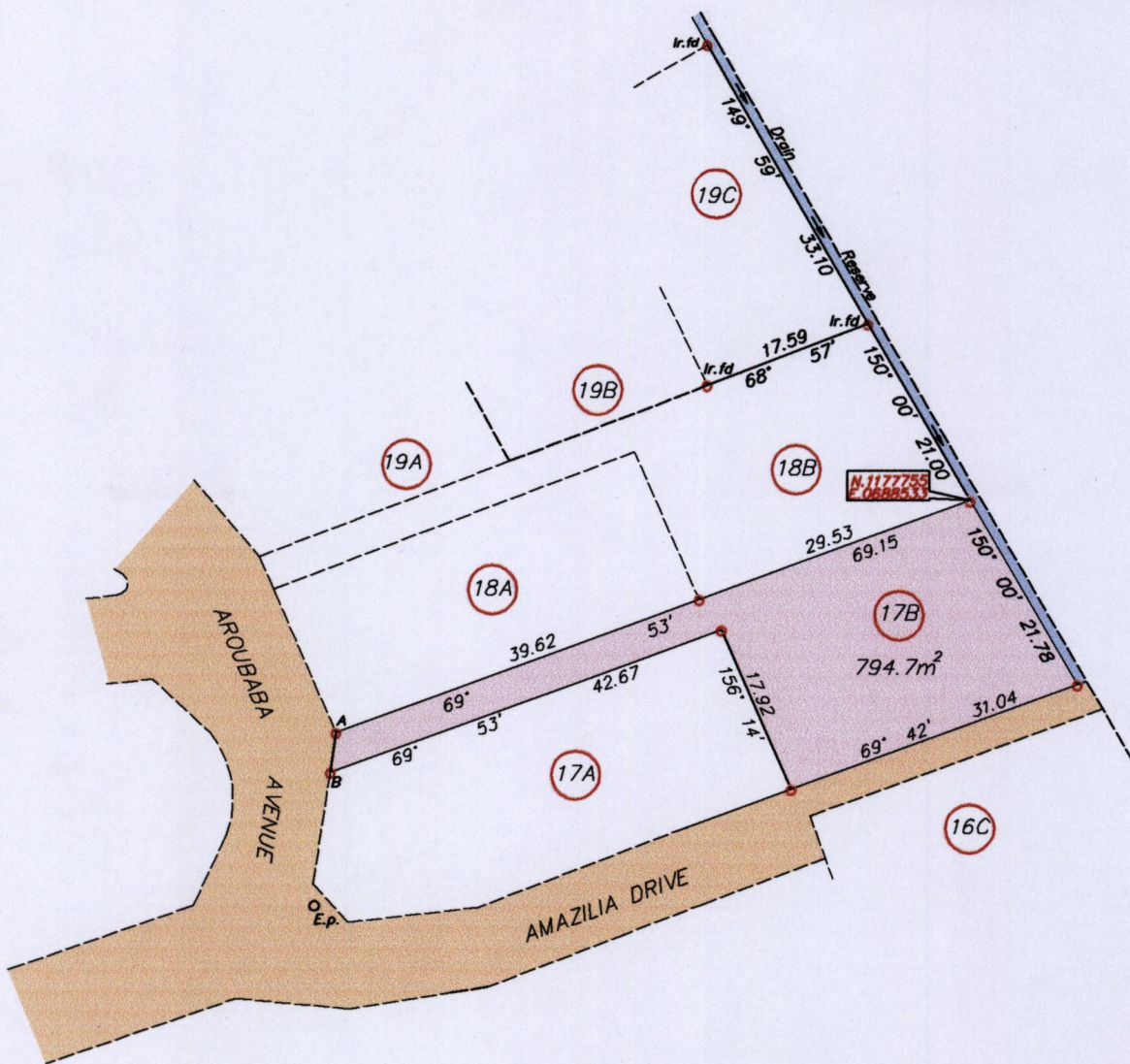

A-B 188° 00' 4.16
B-E.P. 186° 31' 13.83

Vide plan E.D.146

SCALE 1/750

Distances are in metres

Co-ordinates are based on GPS finding

U.T.M. Zone 20 Naparima B.W.I. (+/-5.00m)

○ Denotes Iron put except otherwise stated

Bearings are U.T.M. Grid based on Solar Observations

Note : To obtain Cassini bearings add 18 minutes

Plan of a Parcel of land coloured pink in the borough of Arima
 Containing seven hundred and ninety four point seven square metres
 Surveyed by me, with due authority, in May 2015 for Jennifer Martin

Certified correct in accordance with Regulation 25 (1) of the Land Surveyors' Regulations 1998.



Hugo Somasingh

Entered on.....

Trinidad and Tobago Land Surveyor... 28th May 2015

