

1557

Cadastral Sheet B.24. ^{24C}/_{3/a}

33

SAMAROO LANDS

Borough of Arima.

County of St. George.

Vide Plan P.F.92

Process ID#109875

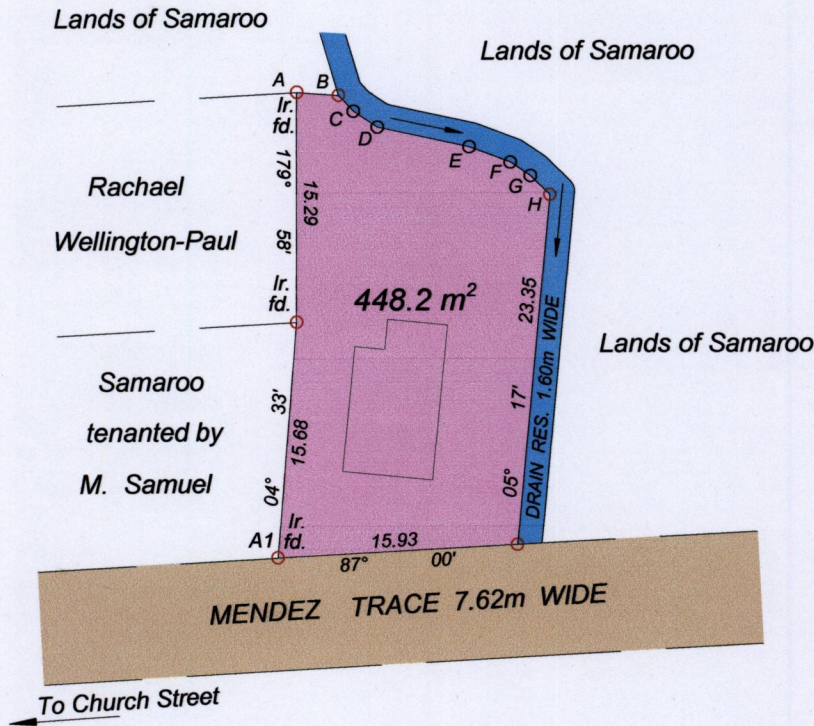

STA.	BEAR.	DIST.
A-B	94° 21'	2.78
B-C	135° 44'	1.44
C-D	123° 46'	1.91
D-E	102° 19'	6.24
E-F	110° 37'	2.91
F-G	123° 52'	1.61
G-H	134° 37'	1.82

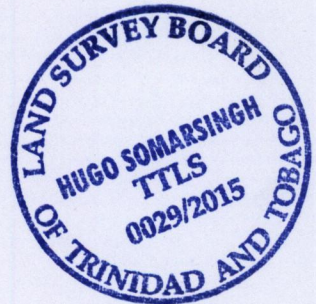

Note : Coordinates obtained by hand held G.P.S. Naparima U.T.M. Zone 20 (+/-) 3m

A1= N - 1178008
E - 0676361

○ Denotes peg put unless otherwise stated
○ Denotes iron put unless otherwise stated
Bearings based on solar observations.

SCALE: 1/500

Note : To obtain compass bearing add minutes Distances are in metres.

PLAN of a parcel of land coloured pink in the Borough of Arima
Containing four hundred and forty eight point two square metres.

Surveyed by me, with due authority, in April, 2015 for Carl Paul & Rachael Wellington Paul.
Certified Correct in accordance with Regulation 25 (1) Land and Surveys Regulation 1998.

Checked by.....

Entered on

Hugo Somarsingh
Trinidad & Tobago Land Surveyor..... 18th May 2015

Rachael
Wellington-Paul

