

69

Process ID# 109741

1557

R.D.3128/1981 parcels 37A & 37B

R.D. De.200302621894 parcels 39A & 39B

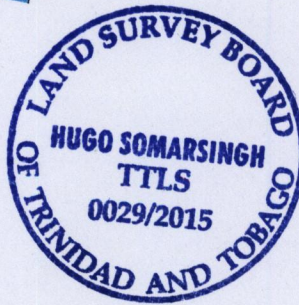
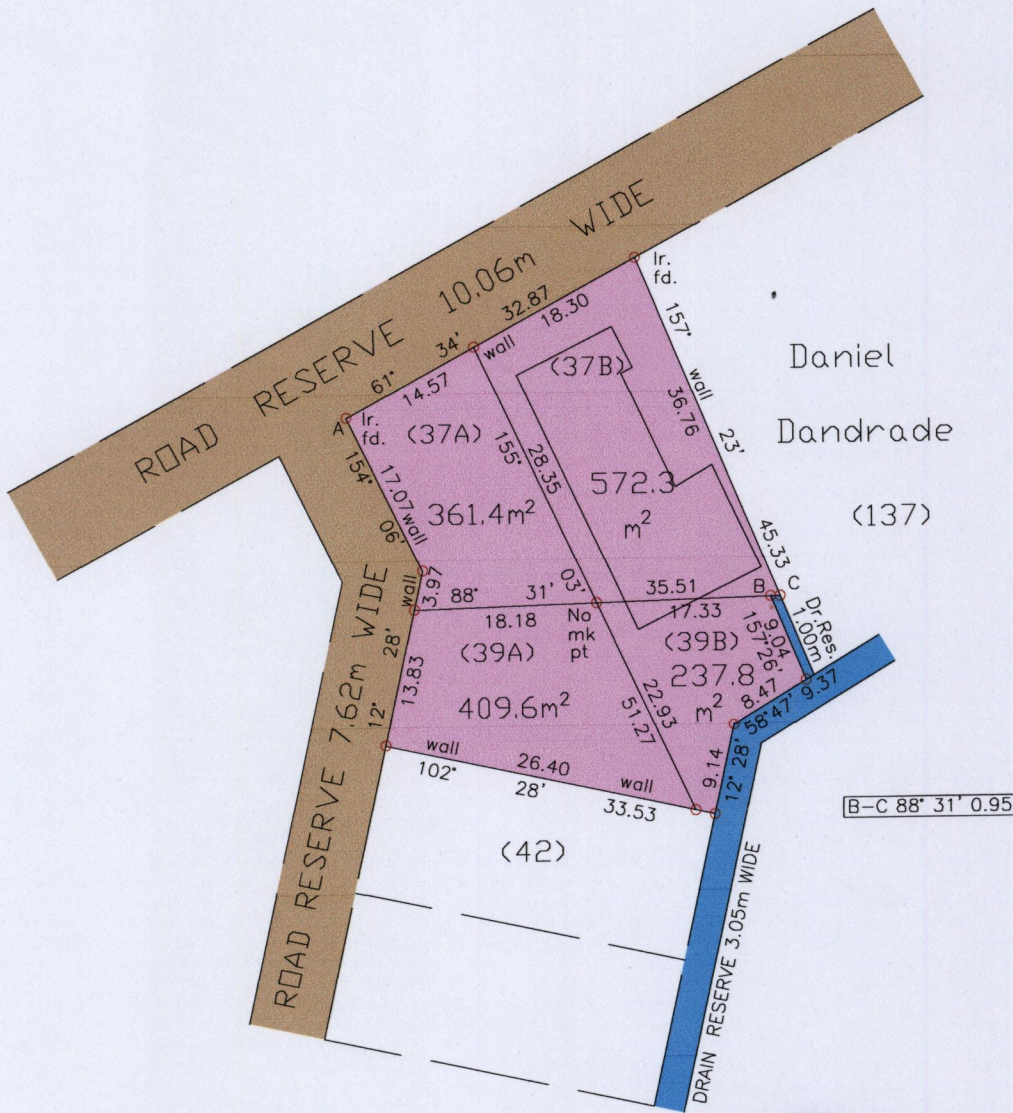
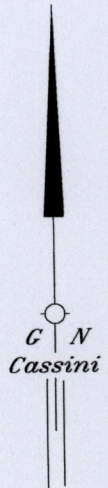

Note : Parcels 37A & 39A to be amalgamated
Parcels 37B & 39B to be amalgamated

Note : Coordinates obtained by hand held G.P.S.
Naparima Zone 20 (+/-) 5m

A= N - 1171951
E - 689417

○ Denotes iron put unless otherwise stated SCALE: 1/750
Bearings based on solar observations .
Note : To obtain compass bearing add minutes Distances are in metres.

PLAN of 4 parcels of land coloured pink in the Ward of Arima.
Containing together one thousand five hundred and eighty one point one square metres.
Surveyed by me, with due authority, in March, 2015 for Krishna Deonarine
Certified Correct in accordance with Regulation 25 (1) Land and Surveys Regulation 1998.

Checked by.....

Entered on

H. Somarsingh
7th May 2015
Trinidad & Tobago Land Surveyor.....

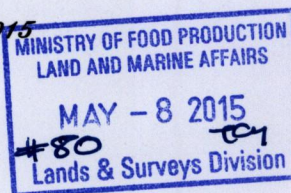

25P-141P