

1557

1330

Cadastral Sheet B.19.0. 24C
1/c

Ward of Arima

County of St. George

R.D. 201302825003

Process Jd# 111293

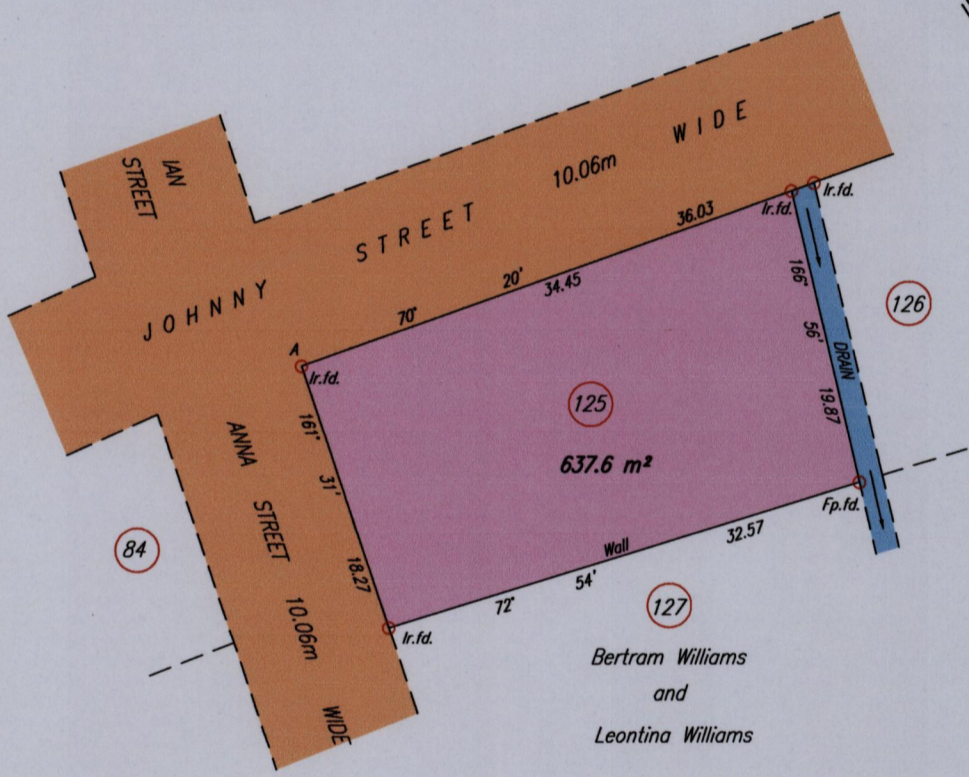
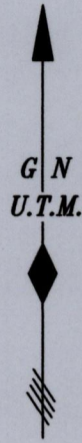

Bertram Williams
and
Leontina Williams

Coordinates of A (lr.fd.): 0685920mE, 1176067mN
U.T.M. 20 Naparima (+/- 5.00m)
G.P.S Direct Observation

SCALE 1:500

Distances are in METRES

Bearings are U.T.M. Grid based on Solar Observations
To obtain Cassini +18'

PLAN of a Parcel of land coloured pink in the Ward of Arima
Containing six hundred and thirty seven point six square metres
Surveyed by me, with due authority, in July 2015 for Gloria Woodman

Certified Correct in accordance with Regulation 25 (1) of The Land Surveyors' Regulations 1998,

Entered

Camille Fortune-Rollock TTLS

Trinidad & Tobago Land Surveyor *24th July* 2015
C:\LESS 2015\TRINIDAD\WOODMAN, GLORIA CR.dwg

