

1557

1783

Process SD#

U.P.R.N.

Cadastral Sheet (B.20.1) ^{24C}/_{2/a}
Ward of Arima
County of St. George.

References:

- Plan J.F. 92
- Plan AN. 45

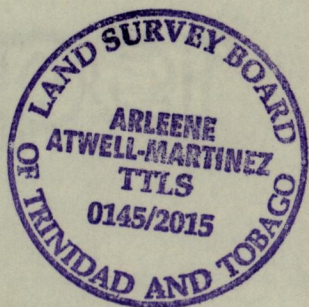
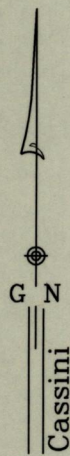
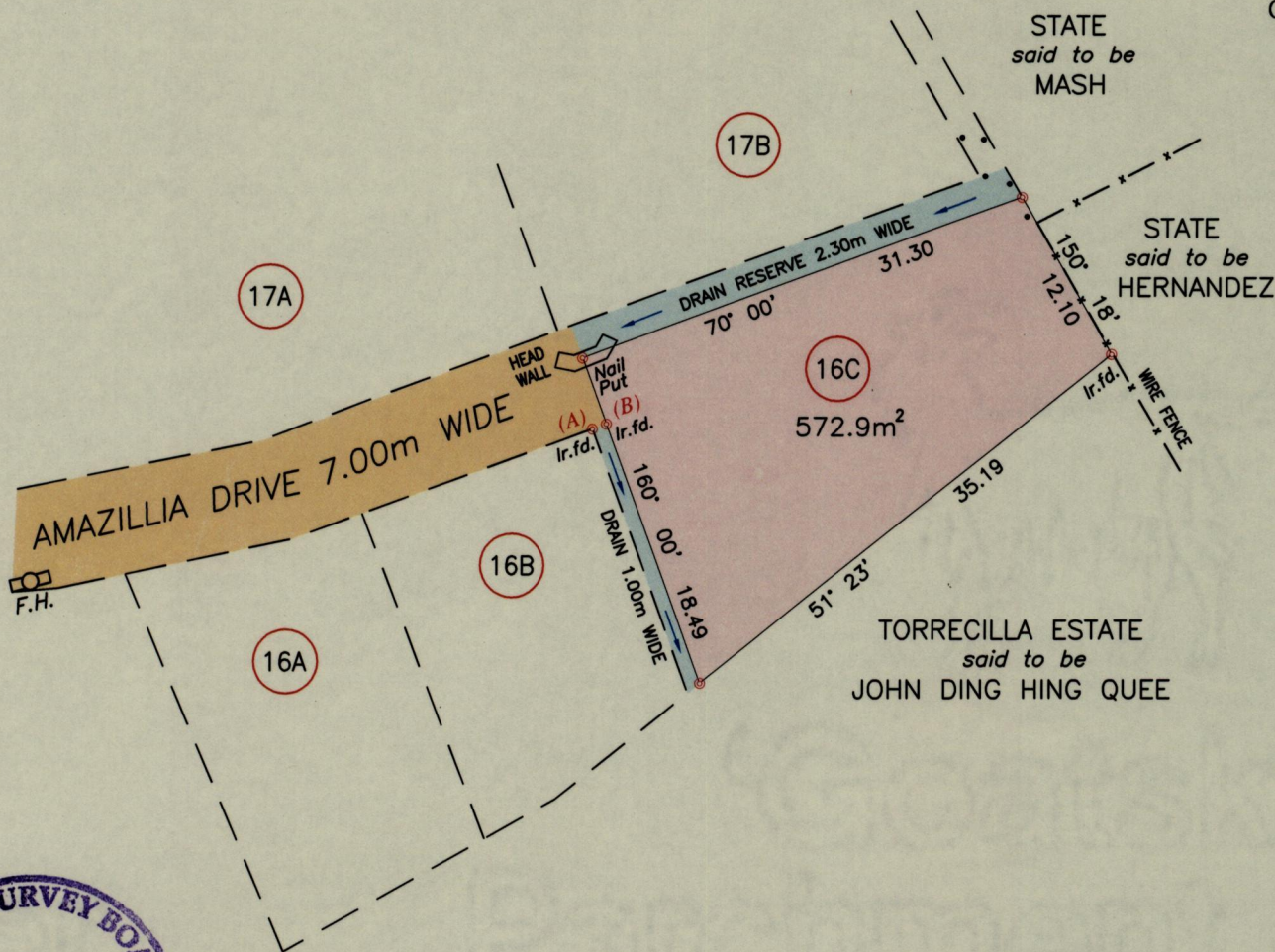

F.H. - A	78° 47'	58.07
A - B	70° 00'	1.00
B - Nail Put	340° 00'	4.69

lr.fd. Iron Found

F.H. Fire Hydrant

● Fence Post

○ Denotes Boundary Iron Put unless otherwise stated
Bearings are based on Solar observations

GPS COORDINATE (B)

N: 1177904

E: 688696

UTM/WGS 84

+/- 3.0 metres

SCALE 1:500

Distance are in metres.

Plan of One parcel of land coloured pink in the Ward of Arima
Containing a total of Five Hundred and Seventy Two point Nine square metres.
Redefined by me, with due authority, in July 2015 for Vanita Maharaj.

Certified correct in accordance with Regulation 25 (1)
of the Land Surveyors' Regulations 1998.

Entered on Trinidad & Tobago Land Surveyor *Arlene Atwell-Martinez* 2015

22ND JULY

