

U.P.R.N. No.

1557

Cadastral Sheet D.4.D. 24 F

176

3/a

Ref. Reg. Deed No. 13258/1997

Ward of San Rafael

County of St. George

Process SDH 111286

La Esmeralda, South

G. N.

Cassini

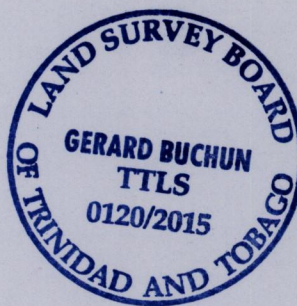
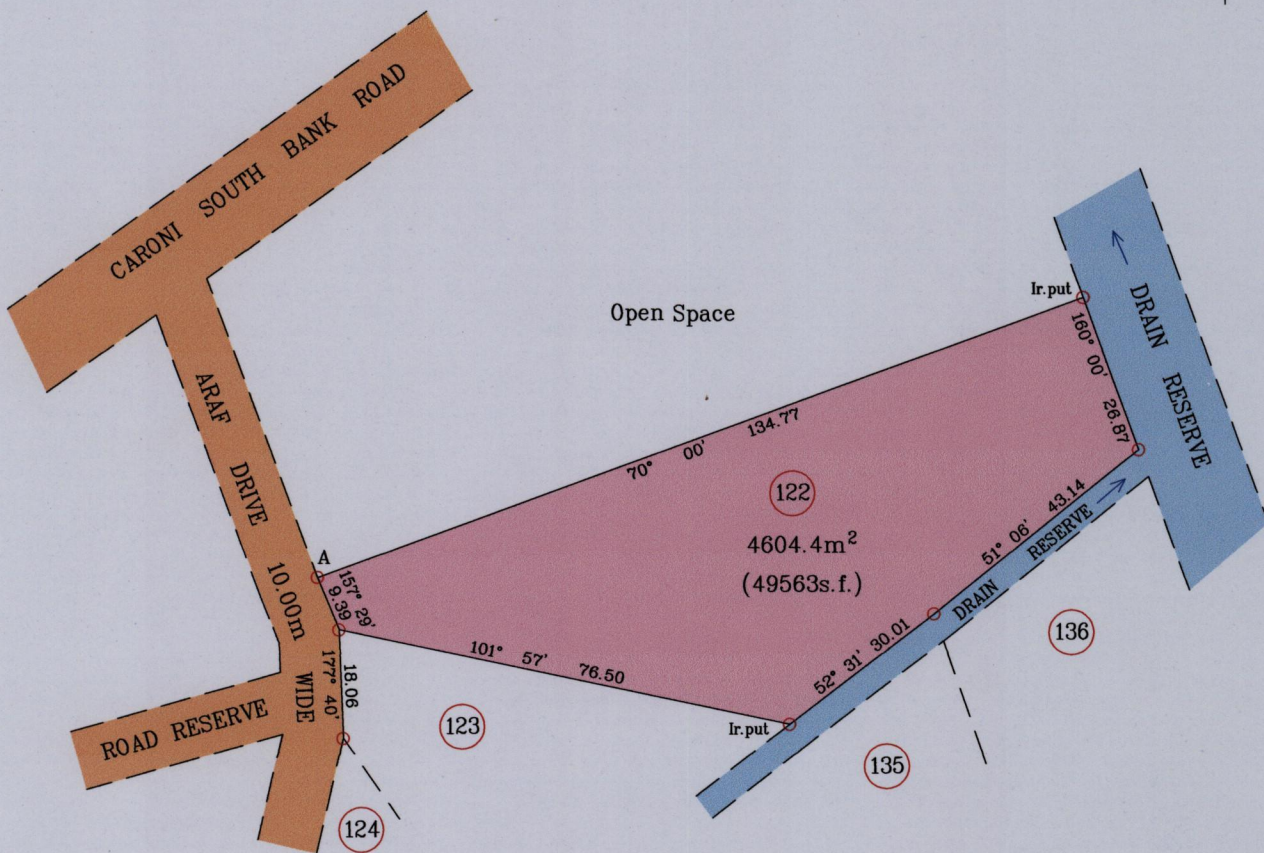

Ir.fd.(A) - 686769m E
 1168475m N
 UTM. Zone20,WGS84(+/-5.0m)
 Hand Held G.P.S. Coordinates.

Vide: Plan K.T.47

SCALE 1/ 1250

Distances are in metres

○ Denotes Iron found except where otherwise stated

Bearings are Cassini Grid based on Solar Observations.

Plan of a Parcel of land coloured pink in the Ward of San Rafael

Containing four thousand six hundred and four point four square metres

Surveyed by me,with due authority in July 2015 for Saliesha Ali and Afrose Ali

Certified Correct in accordance with Regulation 25(1) of the Land Surveyors Regulation 1998.

Entered on.....

Gerard Buchun

Trinidad and Tobago Land Surveyor(TTLS)..... 20/07/ 2015

