

1557

109

Process JDA 111246

Ward of Arima

County of St. George

Cadastral Sheet B.24.C., $\frac{24C}{3/a}$

Reg Deed 201201784186

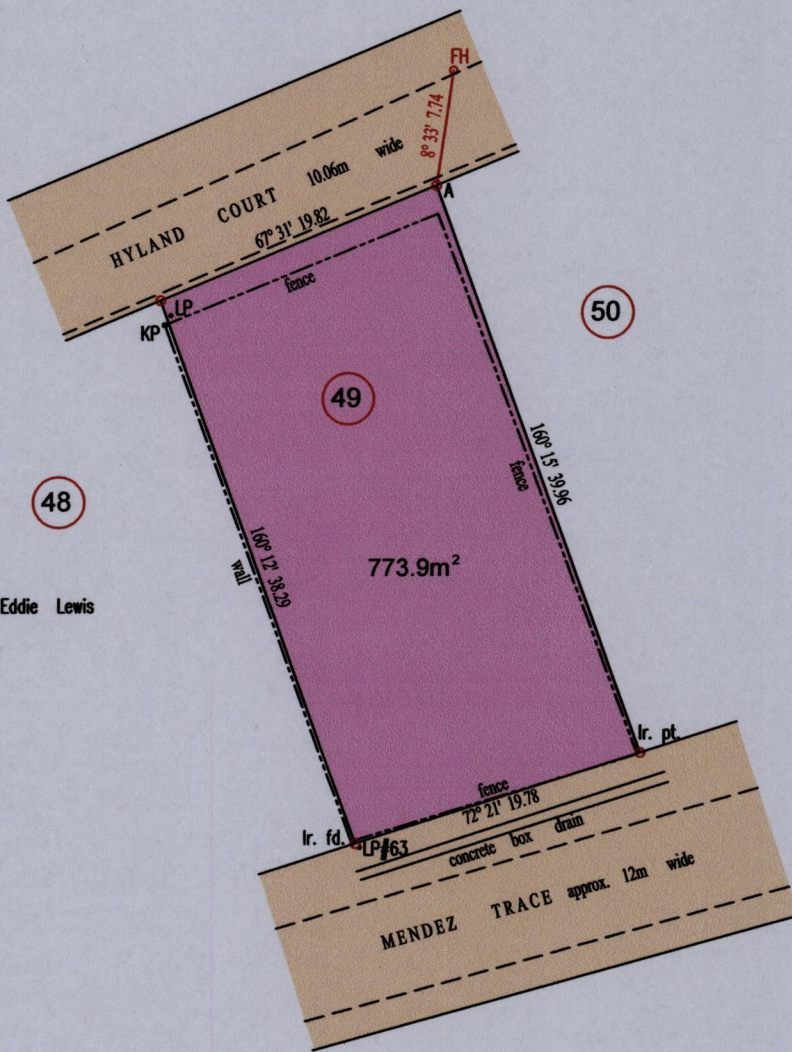

Co-ordinates obtained by Hand Held G.P.S. (U.T.M. Naparima Zone 20)

Point A

Accuracy +/- 3m

E 686604m

N 1175160m

SCALE 1:500

Distances are in metres

KP Denotes King Post

FH Denotes Fire Hydrant

○ Denotes Nail Put unless otherwise stated.

Bearings are Cassini based on Solar Observations

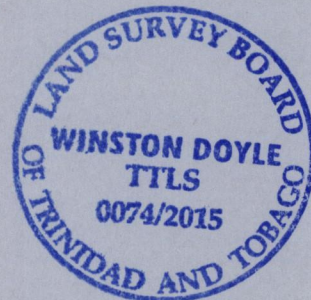

PLAN of a Parcel of land coloured pink in the Ward of Arima
 Containing seven hundred and seventy three point nine square metres
 Surveyed by me, with due authority in July 2015 for Cathy-Ann Jackman
 Certified correct, in accordance with Regulations 25(1) of the Land Surveyors' Regulations 1998

[Handwritten signature]

Entered

Trinidad & Tobago Land Surveyor (TTLS) 16th July 2015

MINISTRY OF FOOD PRODUCTION
 LAND AND MARINE AFFAIRS
 JUL 17 2015
 # 245
 Lands & Surveys Division