

1557

145

Process JDA#111333

Cadastral Sheet D.5.B & B.25.N, 24F&25D
Ward of Arima
County of St. George

SAN RAFAEL

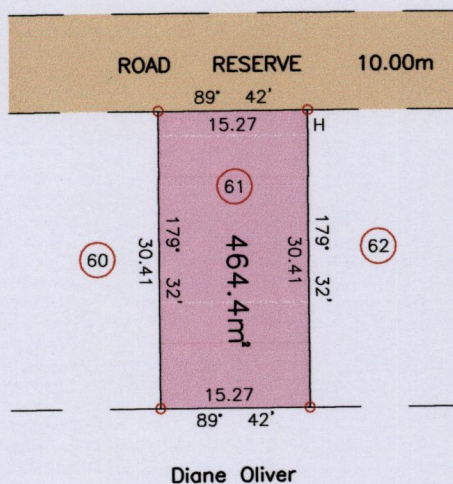

Ir.pt.=H:-N:1170074m
E:691144m
UTM 20, NAP Datum ± 7m
GPS (Hand Held)

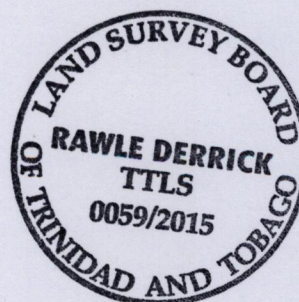

SCALE 1/750
Distances are in Metres

o Denotes Iron put except otherwise stated
Bearings are UTM Grid based on Solar Observations
Plan of a Parcel of land coloured pink in the Ward of Arima
Containing four six four point four square metres
Surveyed by me with due authority, in June 2015 for Diane Oliver
Certified Correct in accordance with Regulation 25 (1) of the
Land Surveyors Regulations 1998.

Entered..... Rawle Derrick
Trinidad & Tobago Land Surveyor July 06.....2015

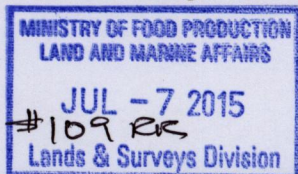

39P