

1557

143

Process ID# 111303

Cadastral Sheet D.5.B & B.25.N, 24F&25D  
Ward of Arima  
County of St. George

SAN RAFAEL

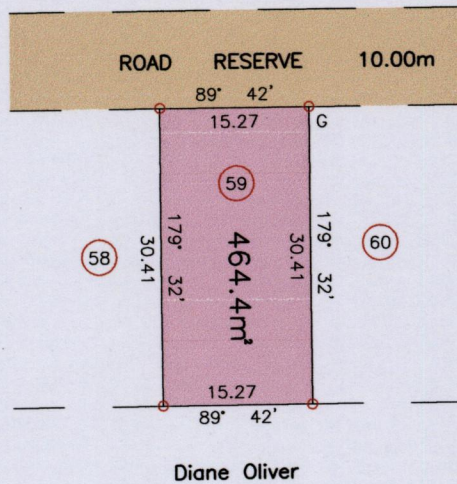

Ir.pt.=G:-N:1170074m  
E:691113m  
UTM 20, NAP Datum ± 7m  
GPS (Hand Held)

SCALE 1/750  
Distances are in Metres

o Denotes Iron put except otherwise stated  
Bearings are UTM Grid based on Solar Observations  
Plan of a Parcel of land coloured pink in the Ward of Arima  
Containing four six four point four square metres  
Surveyed by me with due authority, in June 2015 for Diane Oliver  
Certified Correct in accordance with Regulation 25 (1) of the  
Land Surveyors Regulations 1998.

Entered..... Rawle Derrick.....

Trinidad & Tobago Land Surveyor July 06 2015

