

1557

Cadastral Sheet D.5.B & B.25.N, 24F&25D

134

Ward of Arima

2/d

Process ID# 111201

County of St. George

SAN RAFAEL

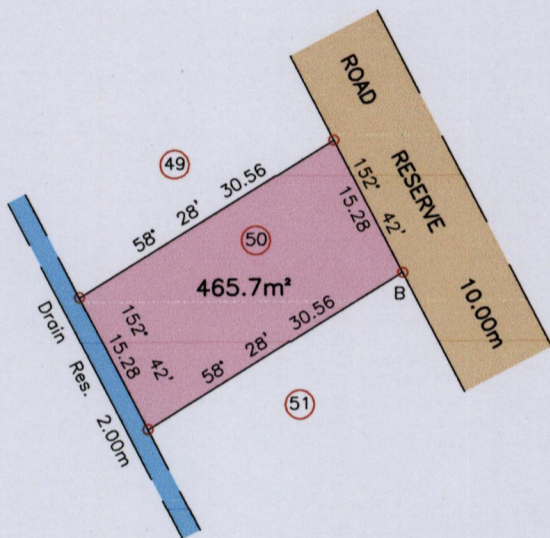

Ir.pt.=B:-N:1170002m
E:690996m
UTM 20, NAP Datum ± 7m
GPS (Hand Held)

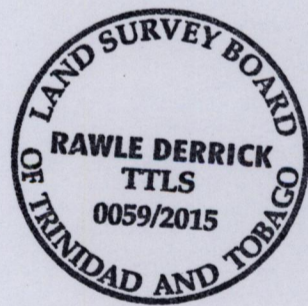

SCALE 1/750

Distances are in Metres

○ Denotes Iron put except otherwise stated
Bearings are UTM Grid based on Solar Observations
Plan of a Parcel of land coloured pink in the Ward of Arima
Containing four six five point seven square metres
Surveyed by me with due authority, in June 2015 for Diane Oliver
Certified Correct in accordance with Regulation 25 (1) of the
Land Surveyors Regulations 1998.

Entered.....

Rawle Derrick

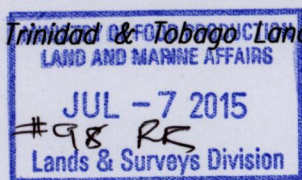

July 06, 2015