

1557

14F

Cadastral Sheet 1/b B.14.0 & B.19.D.
Borough of Arima
County of St. George

107

Location Diagram

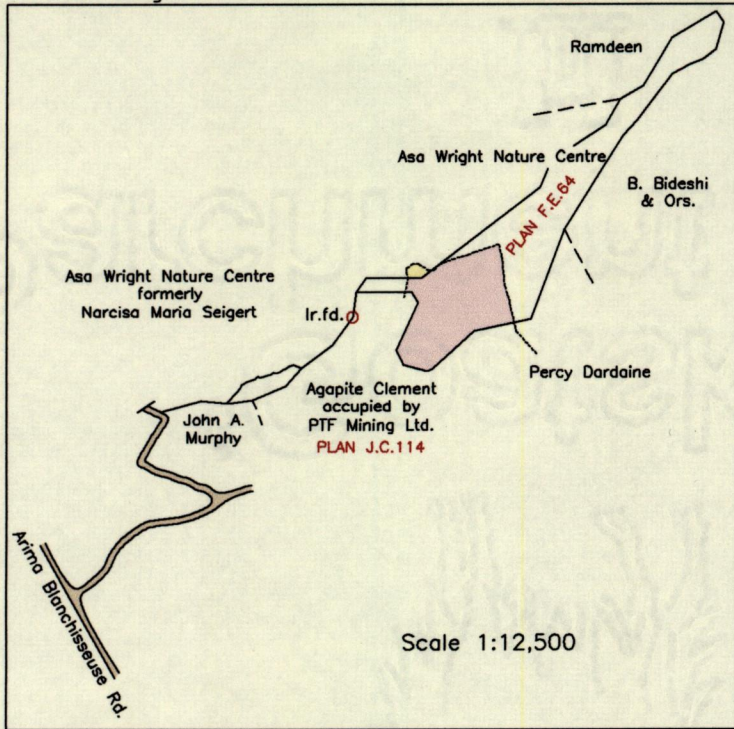

Arima

Process No # 110065

G N
U.T.M.

Asa Wright Nature Centre
formerly
Narcisa Maria Seigert

Asa Wright Nature Centre
formerly
John Boodhoo
PLAN F.E.64

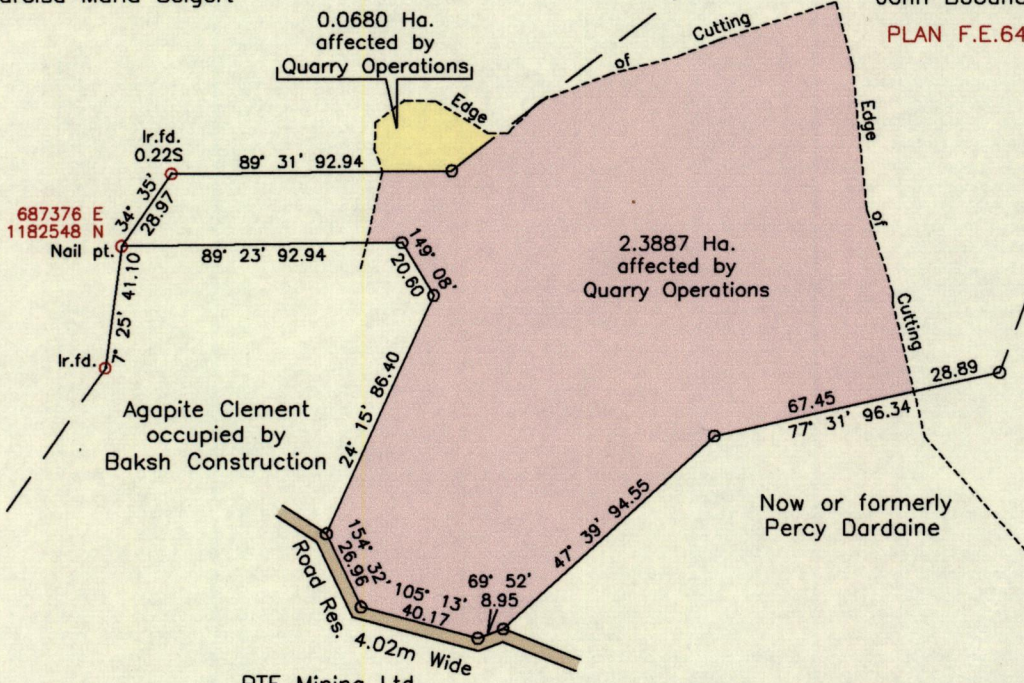

PTF Mining Ltd.
PLAN J.C.114

SCALE 1:2500

Distances are in metres

Reference:
PLAN C.B.35

- Notes: ○ Denotes No Mk.f.d. unless otherwise stated
 Previous surveys by Burton Williams in Oct. 2001 and Sep. 2010
 Previous survey by Charisse G-Charles in Dec. 2008
 Bearings are U.T.M. Grid based on Solar Observations
 Coordinates obtained using handheld GPS (UTM Zone 20, Naparima ± 5.0m)

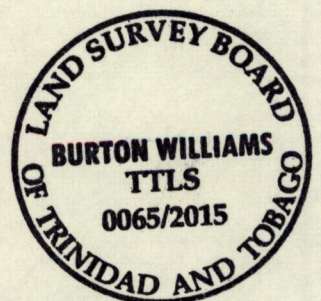

PLAN showing certain boundary lines in the Borough of Arima
 Surveyed by me, with due authority, in May 2015 for Asa Wright Nature Centre
 Certified Correct in accordance with Regulation 25(1) of the Land Surveyors Regulations 1998.

Checked by *Burton Will*

Entered on Trinidad and Tobago Land Surveyor, 11/6/2015.

MINISTRY OF FOOD PRODUCTION
 LAND AND MARINE AFFAIRS
 JUN 11 2015
 #154
 Lands & Surveys Division

G862013.DWG