

"Amended Plan"

1555

190

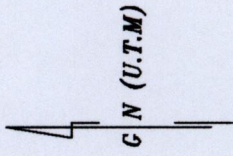

A = N 1155088
 E = 677418

B - C 138° 54' 4.50
 D - E 61° 56' 3.80
 F - G 69° 31' 8.03

SCALE 1:1000
 Distances are in METRES

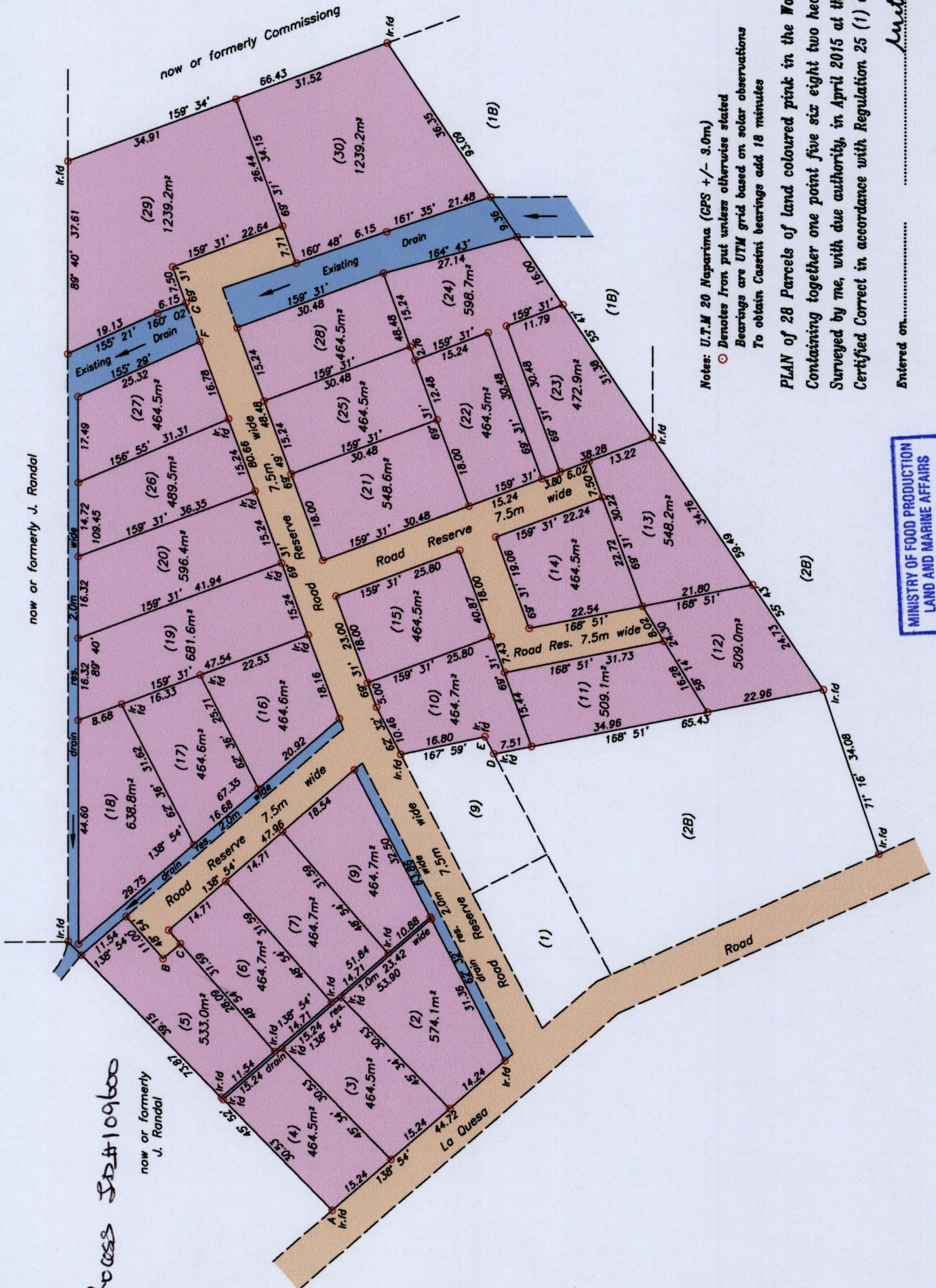

Notes: U.T.M 20 Naparima (GPS +/- 3.0m)
 Denotes Iron put unless otherwise stated
 Bearings are UTM grid based on solar observations
 To obtain Cassini bearings add 18 minutes

PLAN of 28 Parcels of land coloured pink in the Ward of Montserrat.
 Containing together one point five six eight two hectares.
 Surveyed by me, with due authority, in April 2015 at the request of Dynasty Holdings Ltd.
 Certified Correct in accordance with Regulation 25 (1) of the Land Surveyors Regulations 1998.

Entered on.....
 Lucy School

Trinidad and Tobago Land Surveyor..... May 20 2015

MINISTRY OF FOOD PRODUCTION
 LAND AND MARINE AFFAIRS
 MAY 29 2015
 # 359
 Lands & Surveys Division

Process Sd#109600
 now or formerly J. Randal