

1555

127

Location Diagram

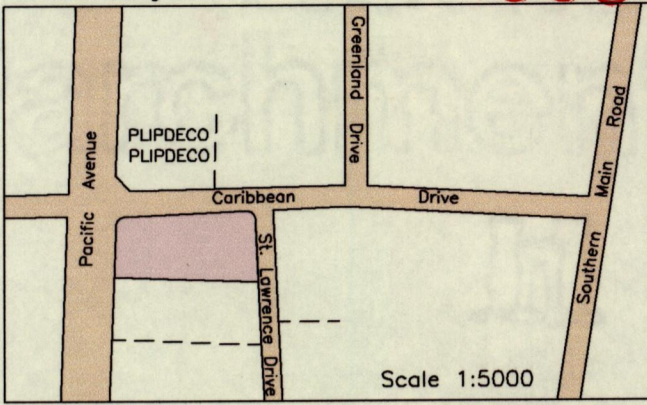

43E

Cadastral Sheet 2/a (D.16.H.)  
 Ward of Couva  
 County of Caroni  
 Point Lisas Industrial Estate

Process Jn#108998

G N  
U.T.M.

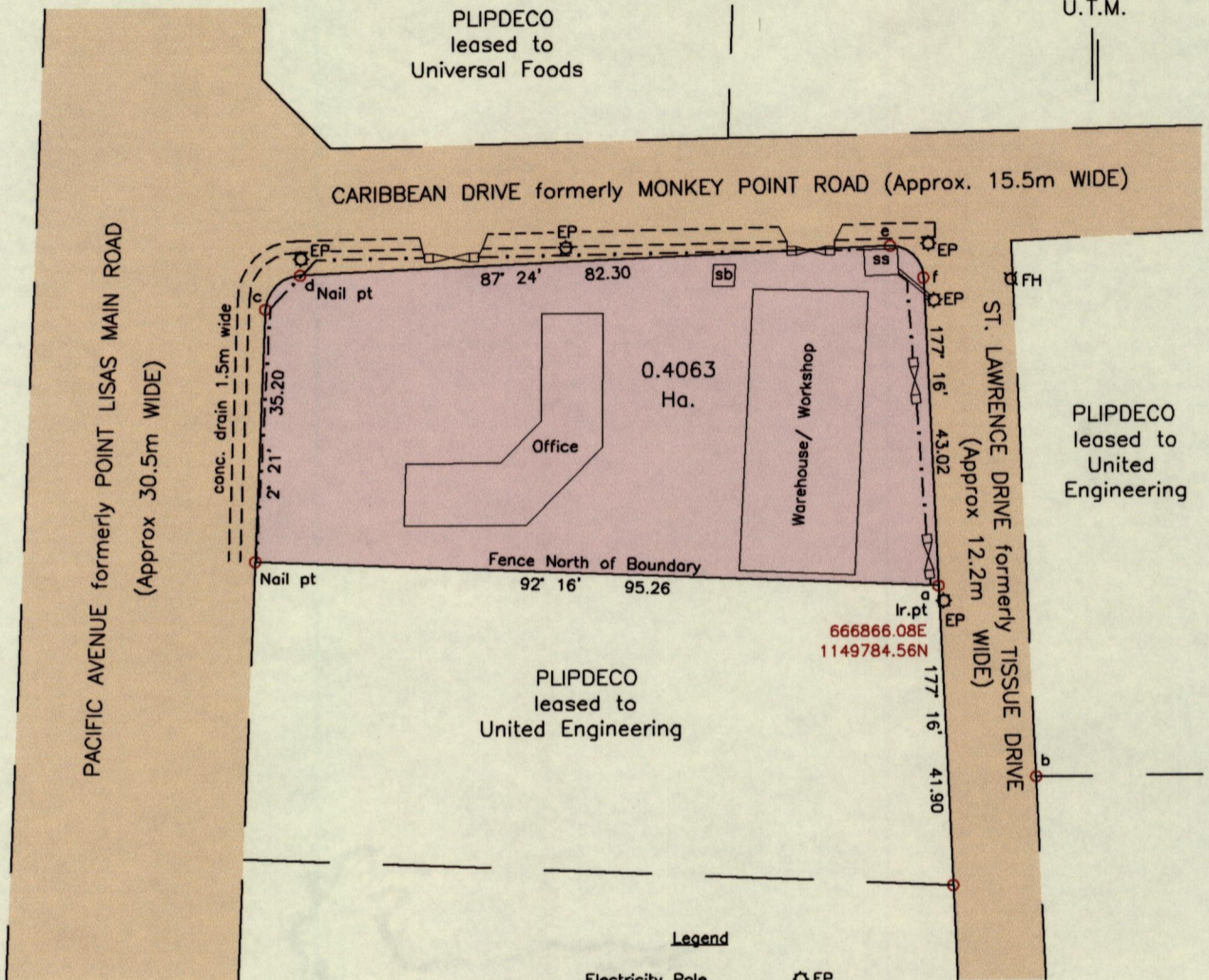

Curve	c-d	e-f	From	To	Bearing	Distance
Delta	80° 03'	89° 52'	a	b	153° 12'	29.90
Radius	5.02	4.56	a	FH	13° 13'	43.86
Bearing	45° 27'	133° 56'				
Distance	6.79	6.44				

Legend

Electricity Pole	⊙ EP
Fire Hydrant	⊠ FH
Security Booth	sb
Electrical Sub Station	ss
Gate	⌢
Fence	- - - - -

SCALE 1:1000  
 Distances are in metres

- Notes: ○ Denotes Ir.f.d. unless otherwise stated  
 Bearings are U.T.M. Grid based on Solar Observations  
 Previous survey by Kenneth Sturge in March 1981  
 Previous survey by Paul Williams in April 1994  
 Coordinates obtained using handheld GPS (UTM Zone 20, Naparima ± 5.0m)

PLAN of a parcel of land coloured pink in the Ward of Couva  
 Containing zero point four zero six three hectares  
 Surveyed by me, with due authority, in March 2015 for PLIPDECO  
 Certified Correct in accordance with Regulation 25(1) of the Land Surveyors Regulations 1998.

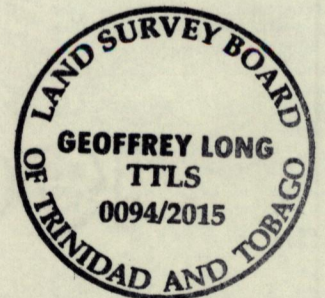

Checked by ..... Geoffrey Long .....  
 Entered on ..... Trinidad and Tobago Land Surveyor, 8th April ..... 2015.

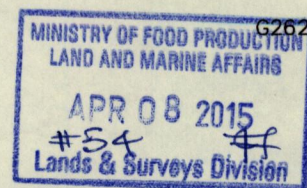

G262015.DWG