

R.P.O. Vol. 125

Fol. 193

C.T. Vol. 2903

Fol. 93

Bk.762 fol.43

Process ID#110910

G N
U.T.M.

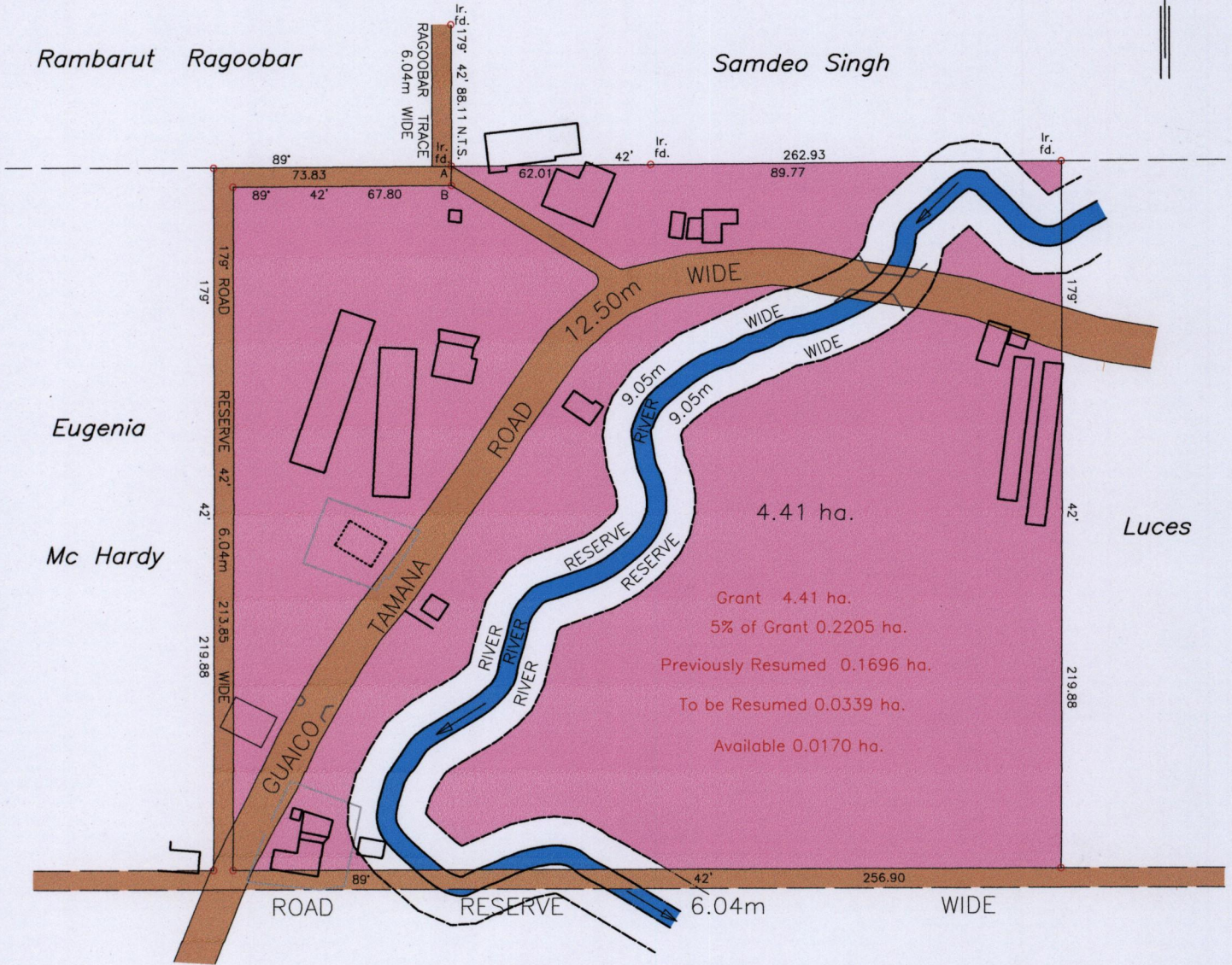

A-B 179° 42' 6.03

A= N - 1158548
E - 700437

Note : Coordinates obtained by hand held G.P.S.

W.G.S.84 Zone 20 (+/-) 5m

o Denotes iron put unless otherwise stated

Bearings are based on solar observations .

SCALE: 1/2000

Note : To obtain compass bearing add/subtract minutes Distances are in Metres.

PLAN of a parcel of land coloured pink in the Ward of Tamana.

Containing four point four one hectares

Redefined by me, with due authority, in June, 2015

Certified correct in accordance with regulation 25 (1) of the

Land Surveyors' Regulations 1998,

Checked by.....

Entered on.....

Trinidad & Tobago Land Surveyor...20...7...2015

