

Process ID 110359

1552

Cadastral Sheet 25.D.

127

Ward of Tamana

County of St. Andrew

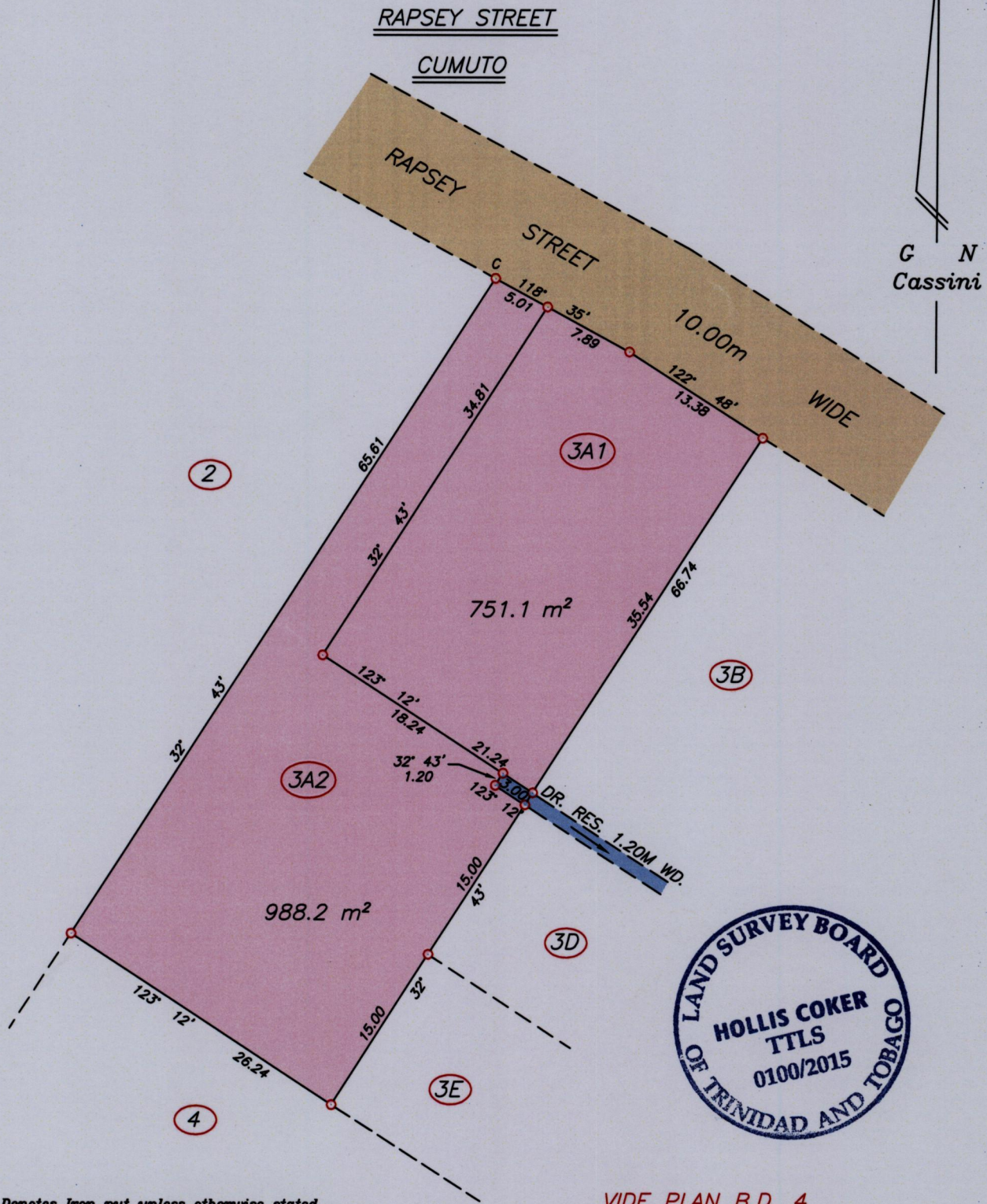

○ Denotes Iron put unless otherwise stated

WGS 84 Easting : 693 744 Northing : 1170 001 - C

Co-ordinates obtained by hand held GPS

Bearings are based on Solar Observations

VIDE PLAN B.D. 4

SCALE 1/500

Distances are in metres

PLAN of 2 Parcels of land coloured pink in the Ward of Tamana  
 Containing one thousand seven hundred and thirty nine point three square metres  
 Surveyed by me with due authority in Apr. 2015 for Eric De Silva  
 Certified correct in accordance with Regulation 25 (1) of the  
 Land Surveyors' Regulations 1998.

Checked by.....

..... T.T.L.S

Entered.....

Trinidad & Tobago Land Surveyor 16 June 2015

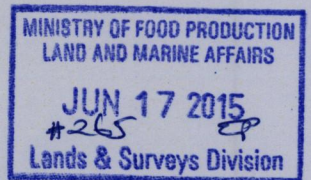

3+2