

1552

R.P.O. Vol. 668 Fol. 43
C.T. Vol. 4048 Fol. 409
See Bk.612 Fol.463

Ward of Tamana 119
County of St. Andrew
Cadastral Sheet E.6.I. 35D
2/6
TAMANA

REDEFINITION PLAN

Process JDA 110302

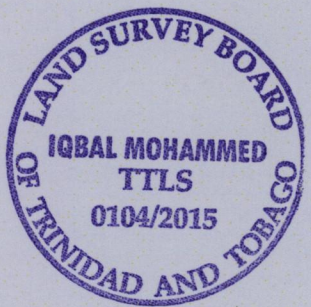
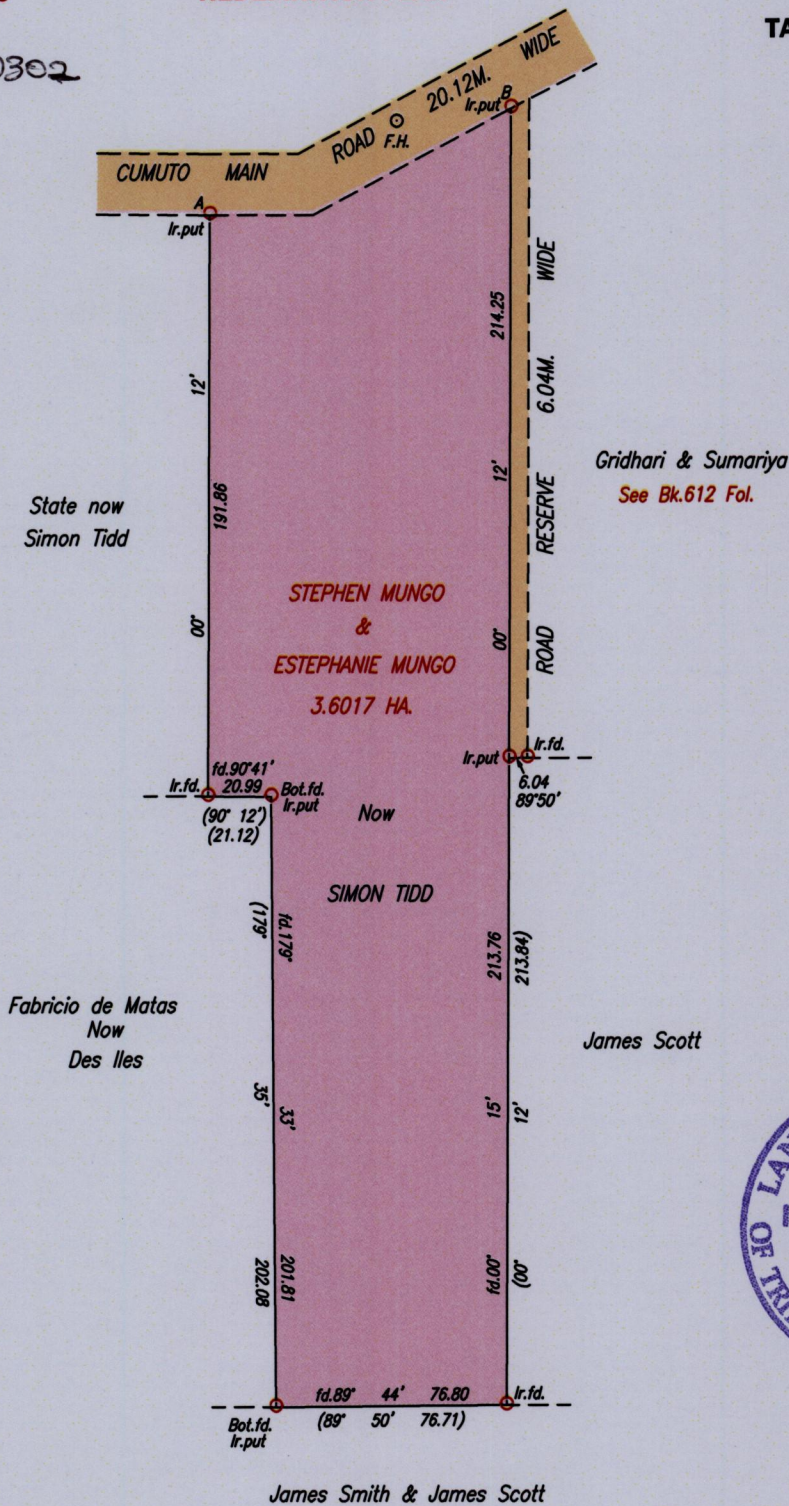

A - B	71° 03'	106.13
B - F.H.	264° 19'	38.19

SCALE 1/2500
Distances are in Metres.

F.H.
696549 mE, 1160666 mN
U.T.M. 20, Nap. (+/- 3.0m.)
G.P.S. (Handheld)

Bearings are Cassini Grid based on solar Observations

To obtain UTM Bearings, subtract 18 minutes

PLAN of a Parcel of land coloured pink in the Ward of Tamana

Containing three point six zero one seven hectares

Redefined by me, with due authority, on May 30th, 2015 for Simon Tidd

Certified Correct in accordance with Regulation 25 (1) of The Land Surveyors' Regulations 1998,

Checked by *[Signature]*

Entered on Trinidad & Tobago Land Surveyor (T.T.L.S.) 8(c) 2015

