

1552

1000

Process ID#109253

Cadastral Sheet 25.D.

Ward of Tamana

County of St. Andrew

RAPSEY STREET

CUMUTO

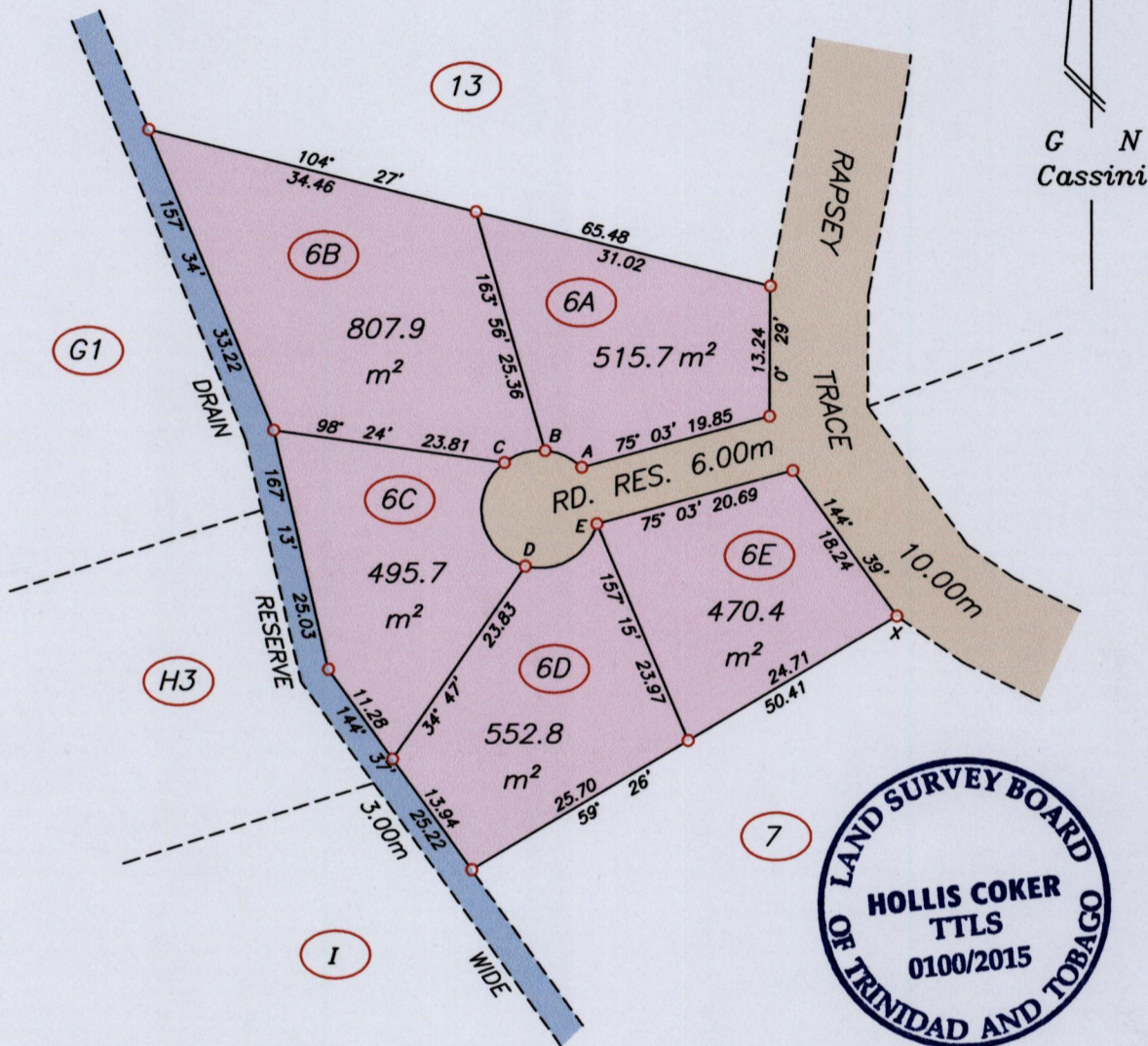

Station	Bearing	Distance	Radius	Station
A	294° 57'	4.12	6.00	B
B	253° 42'	4.33	6.00	C
C	168° 41'	10.77	6.00	D
D	59° 56'	8.47	6.00	E

VIDE PLAN B.D.4

○ Denotes Iron put unless otherwise stated

WGS 84 Easting : 693 914 Northing : 1170 788 - X

Co-ordinates obtained by hand held GPS

Bearings are based on Solar Observations

SCALE 1/750

Distances are in metres

PLAN of 5 Parcels of land coloured pink in the Ward of Tamana

Containing together two thousand eight hundred and forty two point five square metres

Surveyed by me with due authority in Sept. 2014 for Dustin Williams

Certified correct in accordance with Regulation 25 (1) of the Land Surveyors' Regulations 1998.

Checked by.....

Entered.....

*Hollis Coker*

T.T.L.S.

Trinidad & Tobago Land Surveyor

27<sup>th</sup> April 2015

MINISTRY OF FOOD PRODUCTION  
LAND AND MARINE AFFAIRS  
APR 29 2015  
#371  
Lands & Surveys Division

342