

Process ~~SD#~~ 45138

1548

96

Ward of Naparima

County of Victoria

Cadastral Sheet ( G.8.)  $\frac{63.C.}{11a}$

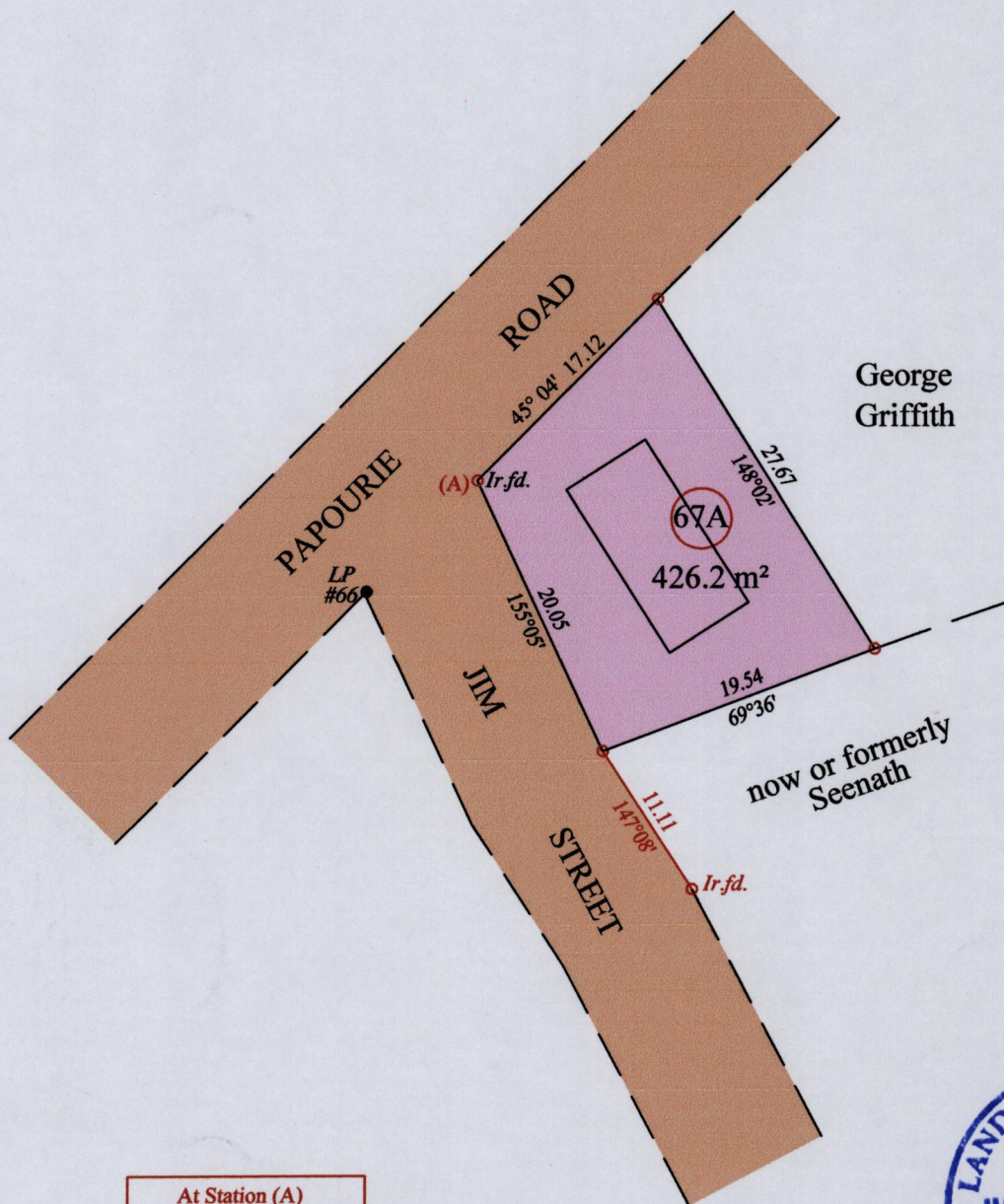
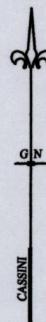

George Griffith

now or formerly Seenath

At Station (A)  
E 0669731  
N 1132742  
Reading taken with  
Handheld G.P.S.  
U.T.M. Zone 20  
Naparima  
± 5 m.



Vide Plan P.F. 104

o Denotes Iron put except stated otherwise.

SCALE : 1:500

Note: Bearings are cassini grid based on solar observations

Distances are in metres

PLAN of a Parcel of land coloured pink in the Ward of Naparima

Containing four hundred and twenty six point two square metres

Surveyed by me, with due authority, in October 2011 for Deokaran Lall

In accordance with Regulation 25 (1) of the Land Surveyors' Regulations 1998,

I certify that this plan is correct.

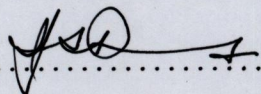
Checked by ..... 

Entered on ..... Trinidad & Tobago Land Surveyor ..... 4. 11. .... 2011

