

Process ~~IDA~~ 45140

1548

94

Ward of Naparima
County of Victoria
Cadastral Sheet (G.7.D.) 63.B.
1/b

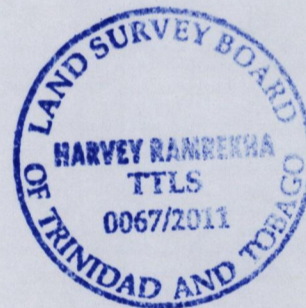
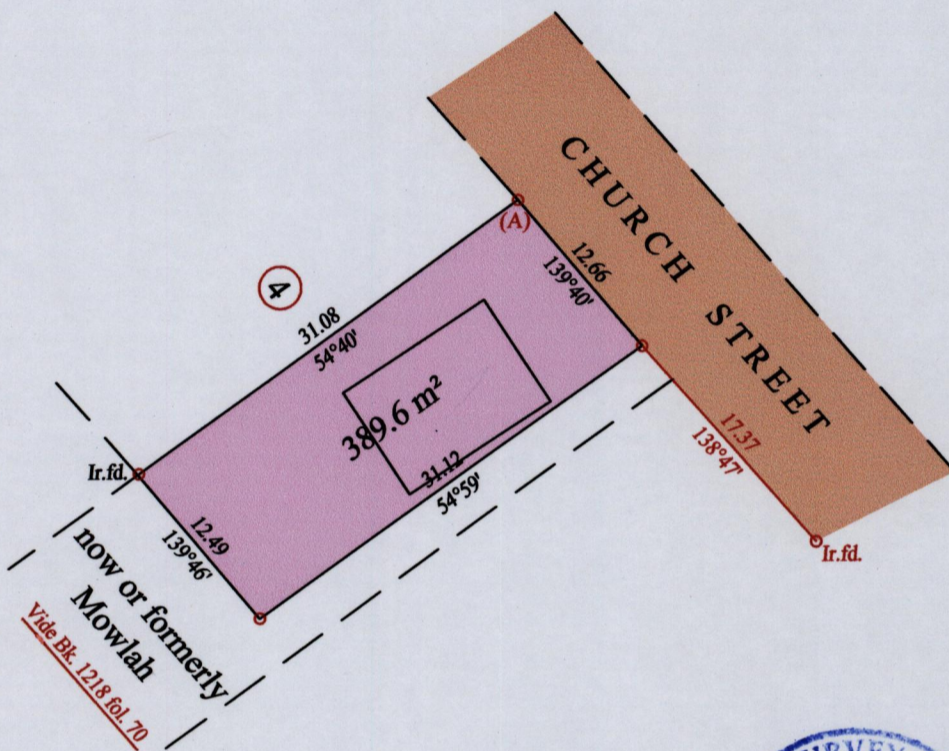
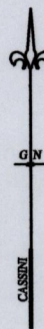

At Station (A)
E 0665723
N 1132901
Reading taken with
Handheld G.P.S.
U.T.M. Zone 20
Naparima
± 5 m.

See fol 95

o Denotes Iron put except stated otherwise.

SCALE : 1:500

Note: Bearings are cassini grid based on solar observations

Distances are in metres

PLAN of a Parcel of land coloured pink in the Ward of Naparima
Containing three hundred and eighty nine point six square metres
Surveyed by me, with due authority, in September 2011 at the request of Mr. R. Gopeesingh
In accordance with Regulation 25 (1) of the Land Surveyors' Regulations 1998,
I certify that this plan is correct.

Checked by

Entered on Trinidad & Tobago Land Surveyor 4. 11. 2011

