

Process ID# 44973

1548

Ward of Naparima

County of Victoria

Cadastral Sheet G.8.B.  $\frac{63C}{1/a}$

89

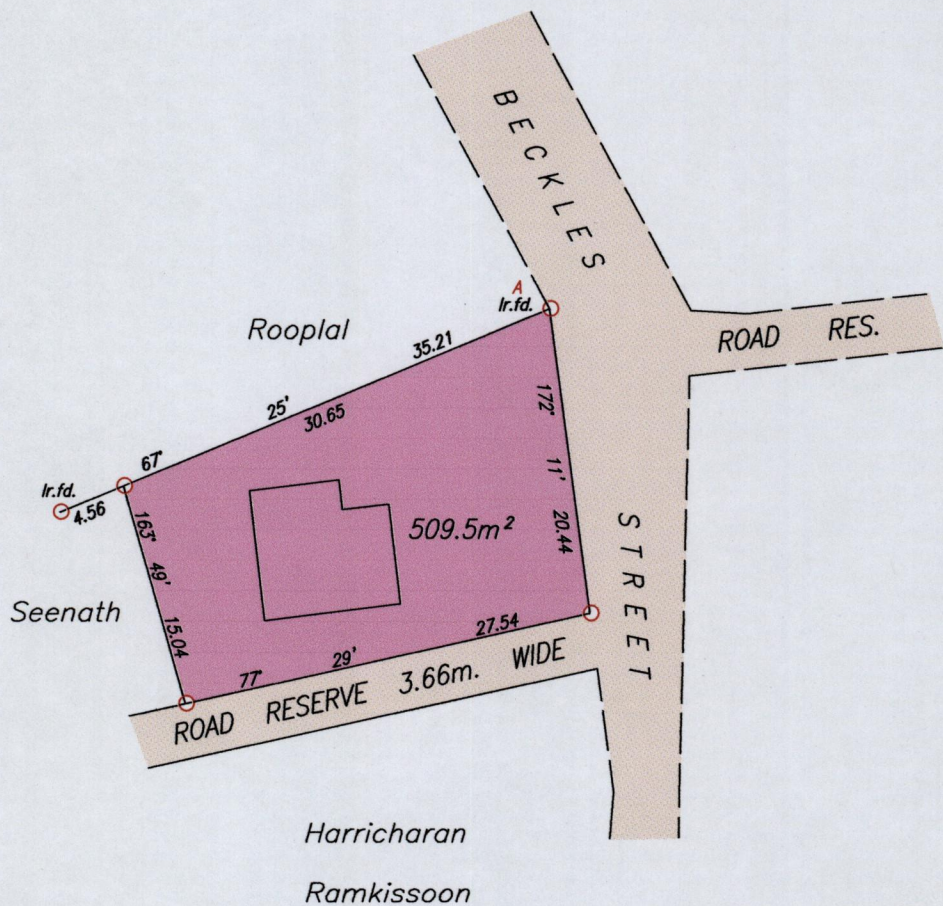
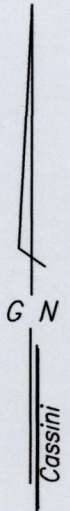

At A

N	1132479	U.T.M.
E	0669729	

obtained from Hand-held  
GPS receiver  
( + / - 5.0m. )

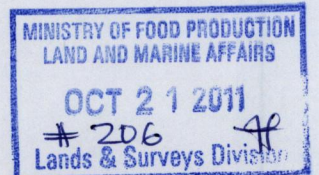

SCALE 1 / 500

Distances are in metres

- Denotes Iron put unless otherwise stated
- Bearings are Cassini Grid based on Solar Observations

Plan of a Parcel of land coloured pink in the Ward of Naparima  
Containing five hundred and nine point five square metres  
Surveyed by me, with due authority, in October 2011 for Annette Moyne.  
In accordance with Regulation 25 (1) of the Land Surveyors' Regulations 1998,  
I certify that this plan is correct.

..... Reemaul ..... T.T.L.S.

Entered on .....

..... 21<sup>st</sup> October ..... 2011

365