

Process ID#44935

Reg. Deed No : 200050116944

Ward of Naparima  
County of Victoria  
Cadastral Sheet (G.8.P.) 63C  
4/d

Error Statement: ±4m  
Datum Definition: U.T.M. Zone 20 Naparima  
Source: Magellan Hand Held GPS

Address: Rookmineah Trace,  
Barrackpore.



**Re-definition Plan**

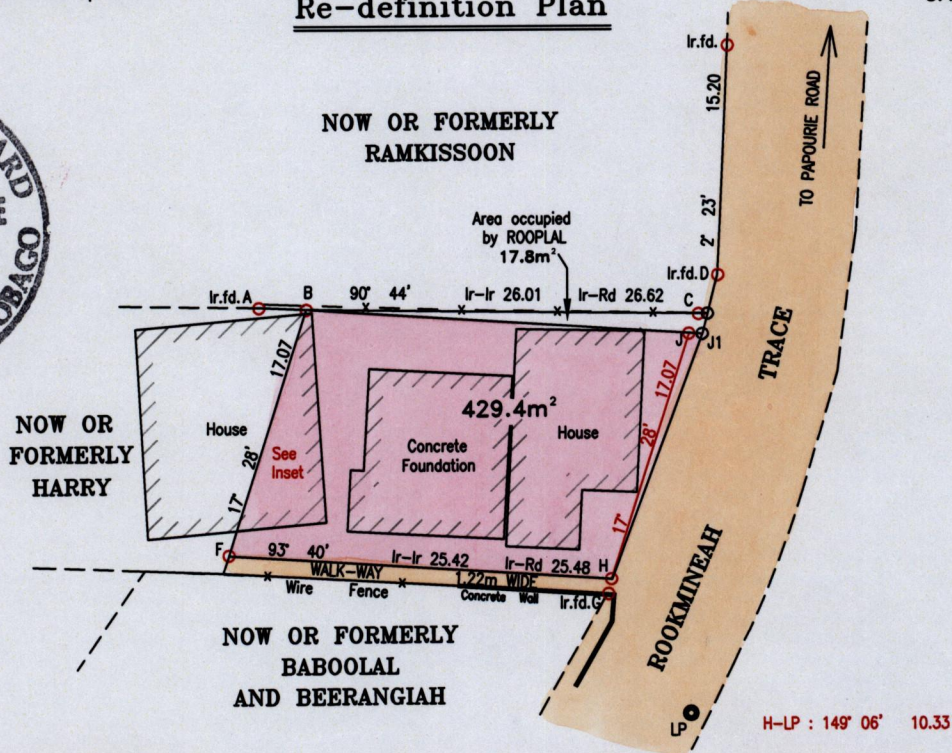

**Co-ordinates**  
Ir.f.d. D: N 1128501  
E 673575

Station	Bearing	Distance
A-B	92° 11'	3.13
B-C	90° 44'	26.01
C-D	26° 11'	2.86
G-H	10° 52'	1.00
B-J	93° 40'	25.42
J-J1	93° 40'	0.91
J-C	26° 11'	1.44
c-d	264 47'	0.48
d-B	17 28'	0.28

- Building (Eve)
- Wire Fence
- Concrete wall

See Bk.1071 fol.109

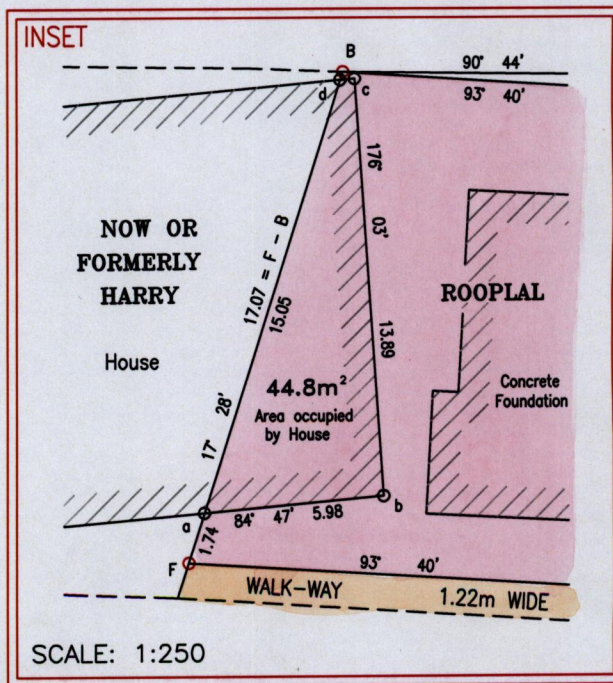

o Denotes No Mark  
o Denotes Iron put except stated otherwise. SCALE: 1:500

Note: Bearings are CASSINI Grid based on solar observations. Distances are in metres.

Plan of a Parcel of land coloured pink in the Ward of Naparima  
Containing four hundred and twenty nine point four square metres  
Re-defined by me, with due authority, in September 2011 at the request of Mr. and Mrs. Rooplal  
In accordance with Regulation 25(1) of the Land Surveyors' Regulations 1998,  
I certify that this plan is correct.

..... Shivon Birkette .....

Entered ..... Trinidad & Tobago Land Surveyor ..... 20-10-2011

