

Process ID# 44474

1548

834

"Palmiste"

Cadastral Sheet G.8.E. 63B
Ward of Naparima
County of Victoria

G N
Cassini

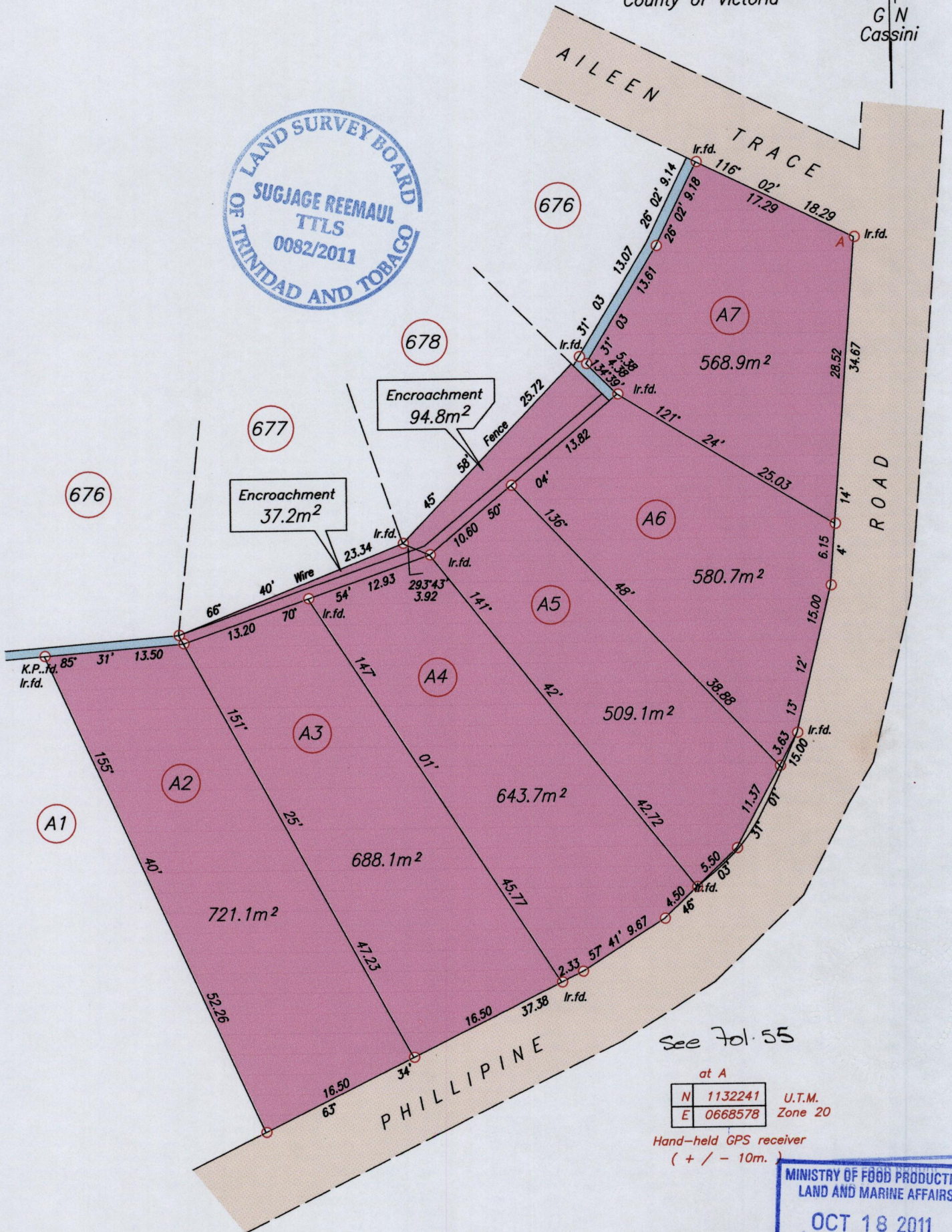

676

677

678

676

A1

A2

A3

A4

A5

A6

A7

See Fol. 55

at A

N	1132241	U.T.M.
E	0668578	Zone 20

Hand-held GPS receiver
(+ / - 10m.)

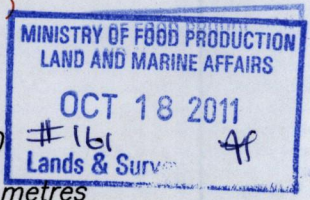

SCALE: 1/500

Distances are in metres

- Denotes Iron put unless otherwise stated
- Bearings are Cassini Grid based on Solar Observations

PLAN of 8 parcels of land coloured pink in the Ward of Naparima
Containing together three thousand eight hundred and forty-three point six square metres
Surveyed with due authority, in September 2011 for Reynold Beharry.
In accordance with regulation 25 (1) of the Land Surveyors' Regulations 1998,
I certify that this plan is correct.

Sugjage Reemaul T.T.L.S.

17th October, 2011

Entered on.....

46P+SLP